

ENG

Translation of the
original user guide



CHARGING STATION PELLENC CHARGING STATION

OPERATING INSTRUCTIONS

56_136922-B
05/2020

**READ THE OPERATING INSTRUCTIONS
MANUAL CAREFULLY BEFORE USE**

TABLE OF CONTENTS

1. INTRODUCTION	5
2. SAFETY	6
2.1. GENERAL SAFETY INSTRUCTIONS FOR THE TOOL	6
2.1.1. WORK AREA SAFETY	6
2.1.2. ELECTRICAL SAFETY	6
2.1.3. PERSONAL SAFETY	6
2.1.4. MAINTENANCE AND UPKEEP	6
2.2. SAFETY MEASURES ASSOCIATED WITH THE USE OF THE CHARGING STATION	6
2.3. SAFETY MEASURES RELATING TO THE USE OF PELLENC CHARGERS AND BATTERIES	7
2.4. SECURITY MEASURES RELATED TO THE TECHNOLOGIES USED	7
2.5. STICKERS	7
3. DESCRIPTION AND TECHNICAL CHARACTERISTICS	10
3.1. DESCRIPTION OF THE CHARGING STATION	10
3.1.1. THE CHARGING STATION	10
3.1.2. ITEMS SUPPLIED WITH THE CHARGING STATION	11
3.2. TECHNICAL FEATURES	11
3.2.1. COMPATIBILITY BETWEEN CHARGERS AND PELLENC BATTERIES	12
4. COMMISSIONING	14
4.1. INSTALLATION OF THE PELLENC CHARGING STATION	14
4.1.1. FIXING CHARGING STATION TO WALL	14
4.1.2. INSTALLATION OF CHARGING STATION ON A WORK SURFACE	15
4.1.3. POSITIONING OF THE POWER CABLE	16
4.2. ELECTRICAL INSTALLATION	16
4.3. CHANGING THE POSITION OF THE POWER CABLE	16
4.4. INSTALLATION OF CABLES	18
4.5. INSTALLING CHARGERS	19
4.6. INSTALLATION OF TOUCHSCREEN TABLET.	22
4.7. FORCED POWER SWITCH	23
4.8. FIRST STARTUP	23
5. USE	25
5.1. HMI (HUMAN-MACHINE INTERFACE)	25
5.1.1. PRESENTATION OF THE HMI	25
5.1.2. SETTINGS / CONVERSIONS MENU	25
5.1.3. DETAILS OF CALCULATIONS FOR SAVINGS MADE	26
5.1.4. SAVINGS / CONSUMPTION / ENVIRONMENT MENU	27
5.1.5. BATTERY SETTINGS MENU	28
5.1.6. CHARGING TIME (DAYTIME/NIGHTTIME) SETTING MENU	29
5.1.7. STATISTICS MENU	30
5.1.8. DEFINING THE EMAIL ADDRESS FOR RECEIVING MAIL	30

5.2. CHANGING TABLET - SAVING DATA	31
5.2.1. REPLACING THE TOUCHSCREEN TABLET	31
5.2.2. SAVING DATA	31
5.2.3. CONNECTION BETWEEN TABLET AND CHARGING STATION	32
6. SERVICE	33
7. INCIDENTS AND TROUBLESHOOTING	34
7.1. INCIDENT AND TROUBLESHOOTING TABLE	34
8. WARRANTIES	35
8.1. GENERAL WARRANTIES	35
8.1.1. STATUTORY WARRANTY	35
8.1.2. COMMERCIAL WARRANTYPELLENC	35
8.1.3. PAID AFTER-SALES SERVICE	36
9. EC STATEMENT OF COMPLIANCE	38
9.1. "EC" DECLARATION OF CONFORMITY: PELLENC CHARGING STATION	38

1. INTRODUCTION

Dear Customer,

Thank you for purchasing your Charging station PELLENC CHARGING STATION . Correctly used and maintained, this tool will give a satisfactory performance for many years.



Warning

Your device contains numerous recoverable or recyclable materials. Return it to your dealer or, failing this, to an approved servicing centre to be treated.



Comply with the regulations in force in your country as concerns environmental protection associated with your activity.



Warning

It is imperative that you read through the ENTIRE user's manual before using or servicing the tool. Always comply with the instructions and illustrations in the manual.

All through this user guide you will find advisory notes and information entitled: NOTE, IMPORTANT, ATTENTION and WARNING.

The points marked "NOTE" indicate additional information.

The points marked "IMPORTANT" warn the user of a potential risk to the equipment.

The points marked "ATTENTION" warn the user of a potentially hazardous situation which if not avoided leads to minor injuries.

The points marked "WARNING" warn the user of a potentially hazardous situation which if not avoided leads to serious injury or death.

The warning  indicates that damage resulting from failure to comply with the procedures and instructions is not covered by the warranty and the owner will be liable for any repair costs.

Safety indications are also given on the tool; they remind you of the safety precautions to be taken. Identify and read these indications before using the tool. Immediately replace any indications that may become partially illegible or deteriorated.

Refer to Section 2.5, "Stickers" for the location diagram of the safety stickers affixed to the tool.

No part of this manual may be reproduced without the written permission of the company PELLENC. The illustrations given in this manual are for information purposes and are in no way contractual. The PELLENC company reserves the right to make any modification or improvement to its products as deemed necessary without informing customers already in possession of a similar model. This manual forms an integral part of the tool and must accompany the tool if it changes hands.

2. SAFETY

- The Charging station PELLENC CHARGING STATION is a professional tool, for use only with PELLENC compatible tools (PELLENC chargers and batteries).
- The PELLENC company accepts no responsibility for any damage caused by improper or unspecified use different from its original intention.
- The PELLENC company accepts no responsibility for any damage caused by the use of non-original parts or accessories.

2.1. GENERAL SAFETY INSTRUCTIONS FOR THE TOOL



Warning

Read all the safety measures and all the instructions.

Retain all the safety measures and instructions for later reference.

This appliance is not intended for use by persons (including children) with reduced physical, sensory or mental capabilities, or lack of experience and knowledge, unless they have been given supervision or preliminary instructions by a person responsible for their safety.

2.1.1. WORK AREA SAFETY

1. **Keep the working area clean and well-lit, with enough space to ensure the machine remains cool.**
2. **Do not operate power tools in an explosive atmosphere, for example in the presence of flammable liquids, gases or dust.** Power tools create sparks, which may ignite the dust or fumes.
3. **Keep children and bystanders away while operating the power tool.** Distractions can cause you to lose control of the tool.

2.1.2. ELECTRICAL SAFETY

1. **Never modify the connector or any other part of the device in any way whatsoever.**
2. **Do not misuse the power cords. Do not use cables for carrying, pulling or disconnecting batteries or chargers. Keep cords away from heat, oil, sharp edges and moving parts.** Damaged or entangled cords increase the risk of electric shock.
3. **If the input and/or output cables are cut or damaged, contact the authorised distributor where it was purchased.**
4. **Do not introduce any metal objects into the device such as paper clips, coins, keys, nails, screws or other small metal objects likely to short circuit its components.**
5. **Do not immerse the device in water. Use indoors only (no water misting).**

2.1.3. PERSONAL SAFETY

1. **Remain vigilant, watch what you are doing and use common sense when using the device. Do not use the device if you are tired or under the influence of drugs, alcohol or medication.**

2.1.4. MAINTENANCE AND UPKEEP

1. **Have the device serviced by an approved PELLENC dealer, using only identical spare parts.**

2.2. SAFETY MEASURES ASSOCIATED WITH THE USE OF THE CHARGING STATION

1. During operation, the charging station temperature can reach 60° C. There must be no flammable material within 1.5 m of the Charging station and the batteries.

2. Keep the equipment out of the reach of children and place it on a non-flammable support.
3. Do not interfere with its cooling cycle.
4. The sockets inside the Charging station are intended for electrical supply for PELLENC chargers only.
5. The charging location must be equipped with a class D fire extinguisher (for metal fires) in good working order.
6. If the power cable is cut or damaged, contact your authorised distributor or an electrician, so that the cable can be replaced.
7. The Charging station is designed for PELLENC chargers, and for organising the charging of PELLENC lithium-ion battery tools.
8. Do not use it for any other purposes.
9. Children must be supervised to ensure they do not play with the Charging station.
10. Verify that the cables are not folded and that they do not come into contact with hot surfaces or sharp edges.
11. Ensure good ventilation during the charging.
12. Never cover the Charging station.
13. The charging station must not be used outdoors (or exposed to water).
14. Make sure the power connector is not exposed to water.
15. Never charge a damaged battery.
16. Grid connection must comply with national electrical regulations (EN60204#1).
17. Check the wiring of the Charging station before use. Never use the Charging station if the cabling is damaged

2.3. SAFETY MEASURES RELATING TO THE USE OF PELLENC CHARGERS AND BATTERIES

Please refer to the relevant battery or charger instruction leaflet.

2.4. SECURITY MEASURES RELATED TO THE TECHNOLOGIES USED

- A professional electrician must install the electrical equipment, using the wiring diagrams supplied with the Charging station.

Type of power cable: H07RN-F 3G2.5.



- The Charging station connects directly to a device fitted with a 16 A (C16) circuit-breaker and a sectioning switch.
- The electrical network must be equipped with a 30mA differential circuit breaker complying with the standard relating to the protection of persons.
- If you cannot start the machine, please contact the authorised distributor.



Warning

Any intervention in the electrical box must be done by a professional electrician (risk of electric shock).

2.5. STICKERS

PELLENC SA Quartier Notre-Dame Route de Cavaillon - CS 10047 84122 Pertuis Cedex (FRANCE) +33 (0)4 90 09 47 00 www.pellenc.com		  	
Designation	: Charge Monitor	Mass w/o chargers	: 75kg
Type	: Pellenc Charging Station	Rated voltage	: 220-240V
Year	:	Rated frequency	: 50/60Hz
SN	:	Rated power	: 2000W max.
		Rated current	: 10A max.



Use indoors only.



This device contains numerous recoverable or recyclable materials. Return it to your dealer or, failing this, to an approved servicing centre to be processed.



Tool compliant with EC standards.

ATTENTION

COURANT DE FUITE ÉLEVÉ
RACCORDEMENT À LA TERRE
INDISPENSABLE
AVANT LE RACCORDEMENT À
L'ALIMENTATION

WARNING

HIGH LEAKAGE CURRENT
EARTH CONNECTION ESSENTIAL
BEFORE CONNECTING SUPPLY

ACHTUNG

ERHÖHTER FEHLERSTROM!
VOR DEM ANSCHLIESSEN AN DIE
STROMVERSORGUNG IST EIN
ERDUNGSANSCHLUSS
ERFORDERLICH

READ THE INSTRUCTIONS BEFORE USE

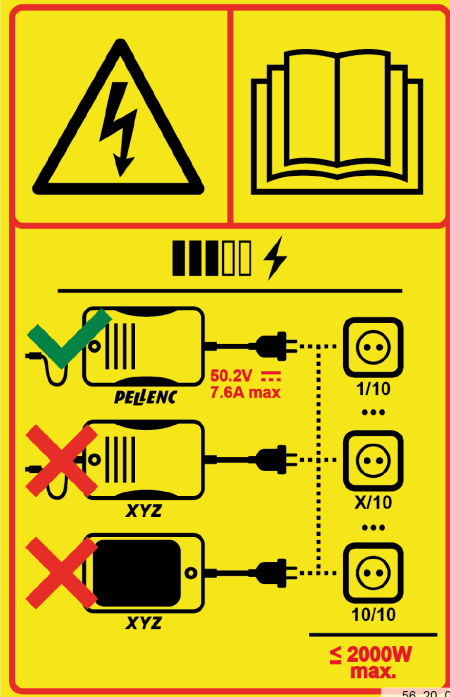

56_20_016



Electrical hazard. Hazardous voltage.



Read the user manual.

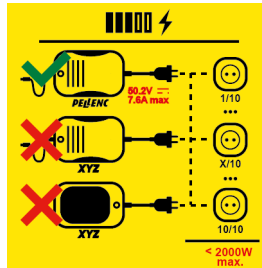

The 10 connectors in the electrical box are reserved only for PELLENC chargers. No other appliance must be connected to these sockets.

Maximum available power: 2000W.

3. DESCRIPTION AND TECHNICAL CHARACTERISTICS

3.1. DESCRIPTION OF THE CHARGING STATION

3.1.1. THE CHARGING STATION

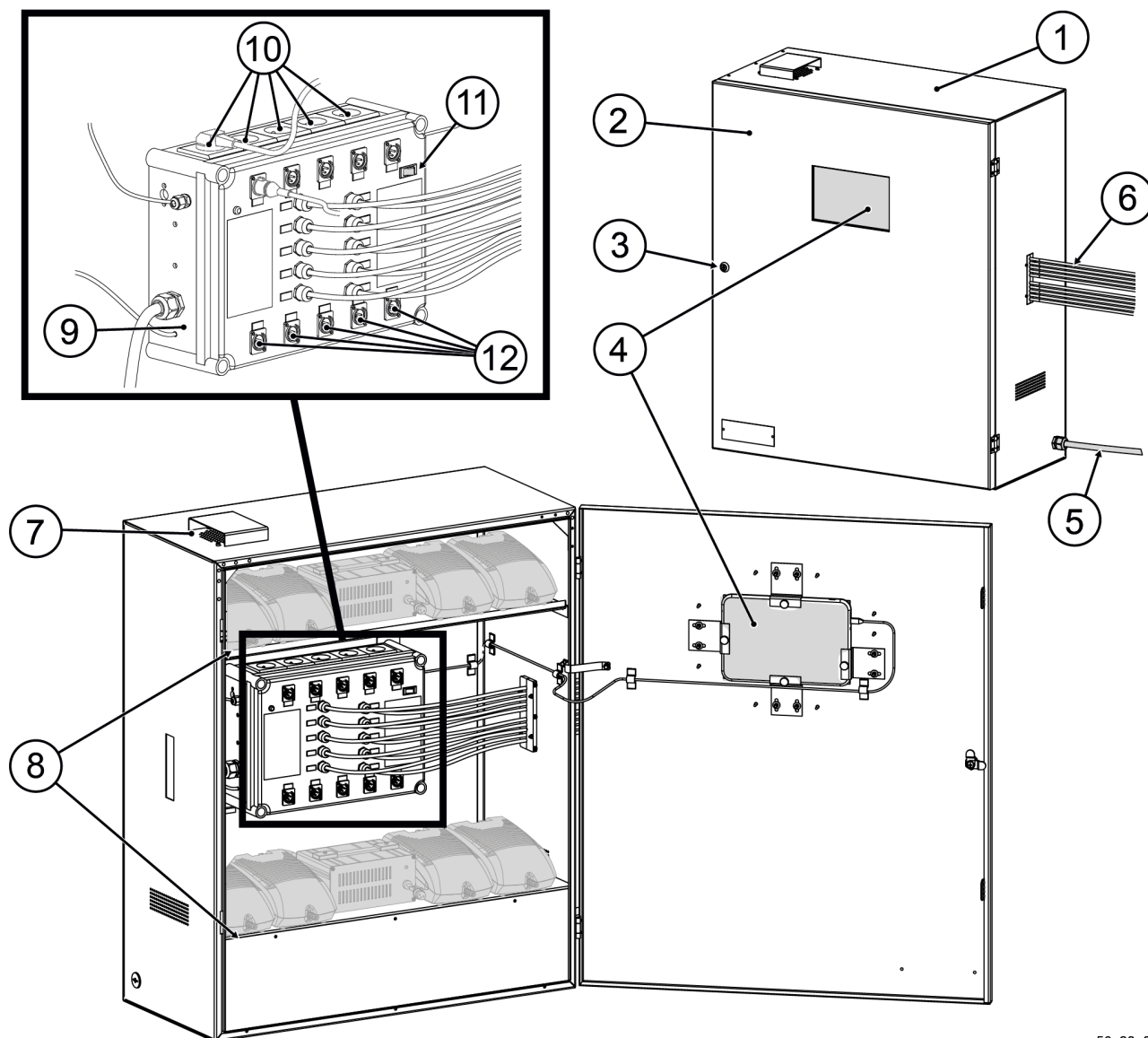

56_20_017

- | | |
|---|---|
| 1. Charging station | 7. Fan |
| 2. Door | 8. Supporting shelves for chargers |
| 3. Touchscreen tablet | 9. Electrical box |
| 4. Locks | 10. Charger power sockets (x10) |
| 5. Charging station power supply cable | 11. Override on/off switch |
| 6. Cables for battery connections (x10) | 12. XLR connectors (x10) to connect the chargers to the electrical box. |

Note

There is an F10AH250V fuse inside the box, compliant with standard CEI 60127.

3.1.2. ITEMS SUPPLIED WITH THE CHARGING STATION

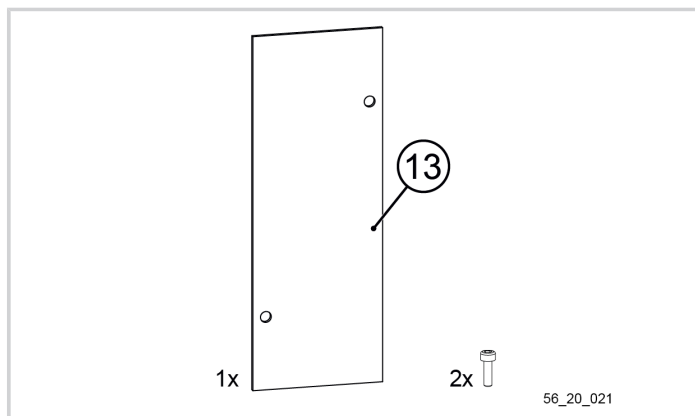

13. Blanking plate (supplied with two screws)

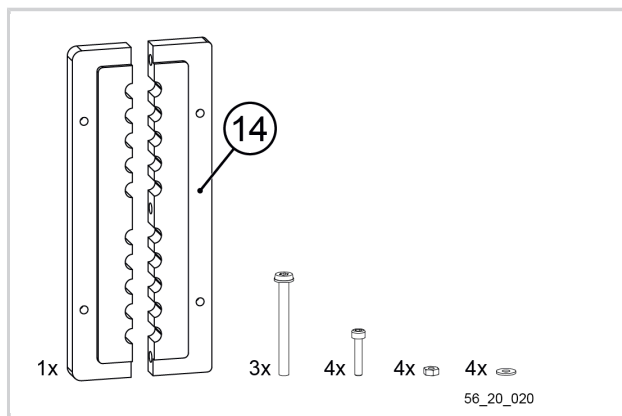

14. Cable grommet plate (supplied with 7 screws, 4 nuts and 4 washers).

3.2. TECHNICAL FEATURES

	PELENC CHARGING STATION
Capacity	10 battery chargers (including a maximum of 2 quick chargers)
Dimensions in mm (L x H x W)	800 x 1000 x 400
Weight without charger (kg)	83
Weight with 10 chargers (kg)	96

3.2.1. COMPATIBILITY BETWEEN CHARGERS AND PELLENC BATTERIES

Batteries (type Lithium-ion)				Chargers					
Type	Comm. ref.	Allocat- ed capac- ity (Ah)	Number of elements	CB5010HV (1A) 132658	CB5012 (1.2A) 62398	CB5022 (2.2A) 60026	CB5022HV (2.2A) 57256	CB5030HV (3.75A) 131941	CB5075 (7.6A) 57011
ULIB 250	57107	5.4	24	YES	YES				
ULiB 400	57065	8.4	48	YES	YES	YES	YES	YES	
OLIVION+	57173	16.2	72		Compati- ble but slow charge*	YES	YES	YES	YES
ULIB 700	56242	16.2	72		Compati- ble but slow charge*	YES	YES	YES	YES
ULIB 750	57257	17.25	60	Compati- ble but slow charge*	Compati- ble but slow charge*	YES	YES		
ULIB 1100	57028	21.6	96		Compati- ble but slow charge*	YES	YES	YES	YES
ULIB 1200	57181	27.2	96			Compati- ble but slow charge*	Compati- ble but slow charge*	YES	YES
ULIB 1500	57180	34	120			Compati- ble but slow charge*	Compati- ble but slow charge*	YES	YES
Alpha 260	57192	6	24	Compati- ble but slow charge*	Compati- ble but slow charge*	YES	YES		YES
Alpha 520	57193	12	48	Compati- ble but slow charge*	Compati- ble but slow charge*	YES	YES		YES

*Compatible but slow charge: >12h to charge from 0 to 100%.

Note

See battery instructions to estimate charging time according to charger used.

Reminder of use of Quick Charger CB5075 (7.6A) :

- If after charging with the CB5075 charger the battery display indicates less than 95%, the next time the battery is charged it must be done with the original charger. The sticker shown below is affixed to the CB5075 charger as a visual reminder of this warning.

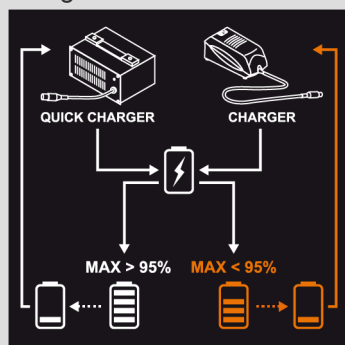

4. COMMISSIONING

4.1. INSTALLATION OF THE PELLENC CHARGING STATION

4.1.1. FIXING CHARGING STATION TO WALL

Important

The Charging station may be fixed only to a masonry type wall.

4 anchor studs are required to fix the charging station in place. Use anchor studs suitable for the type of wall which will support the charging station:

- For a solid concrete wall (not subject to cracking) or a solid brick wall: RS PRO - REF 908-6895 or RAWL FIXINGS - REF R-RBL-M06/10W.
- For a natural stone, breeze block or hollow block wall: RAWL FIXINGS - REF R-RBL-M06/10W.

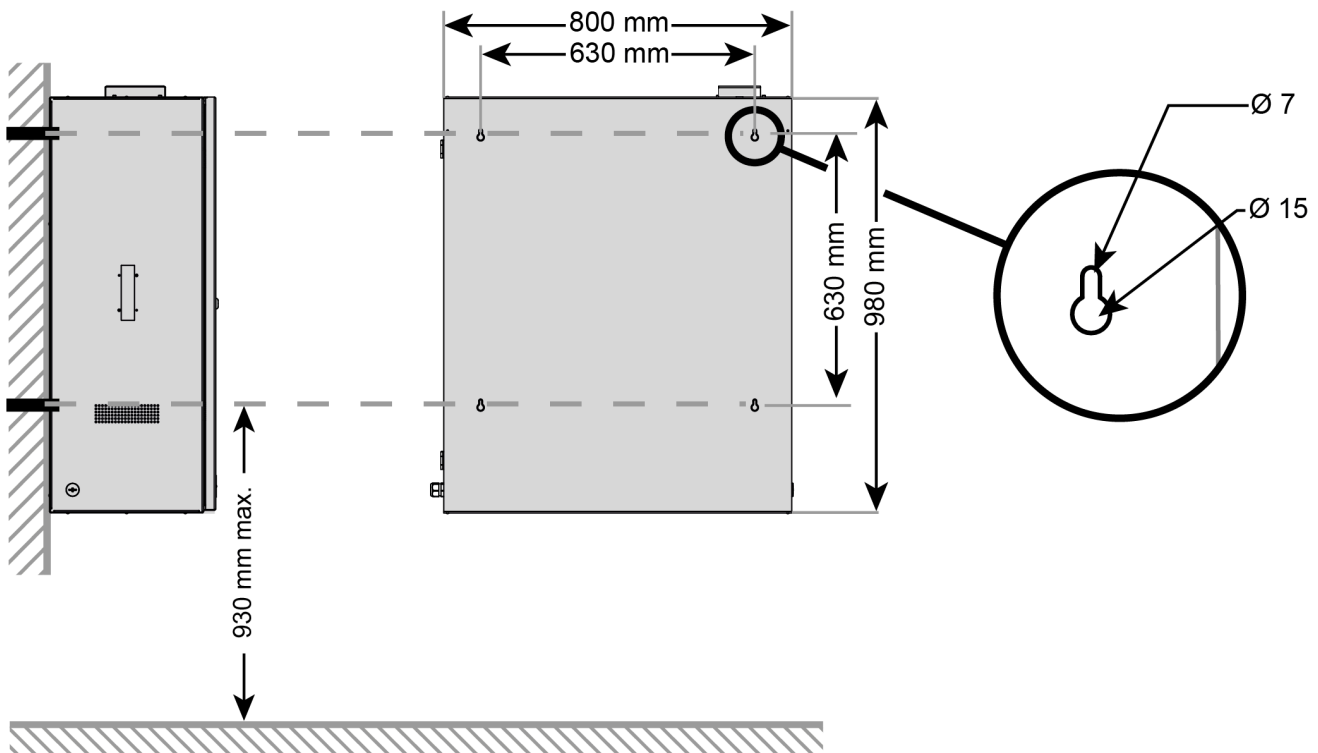

56_20_019

1. Drill 4 x 12mm holes, 55mm deep at the positions specified below.

Note

For fixing to a brick wall, the studs must not be inserted in the mortar joints.

2. Remove any debris produced.
3. Remove the debris, and clean the holes thoroughly with a suitable brush or pump.
4. Remove the shelf from the charging station to make installation easier (see Section 4.5, "Installing chargers").

5. Remove the pre-assembled bolts and washers.
6. Separate the pre-assembled bolts and washers, then insert the studs into the 4 holes using a hammer, until they are flush.
7. Screw the 2 bolts with the 2 washers into the top brackets.
8. Tighten to the recommended torque depending on the model chosen (6 Nm for the RS PRO brand / 6.5 Nm for the RAWL FIXINGS brand).
9. Unscrew the 2 bolts to leave a gap of 5mm between the washers and the wall so that the panel of the charging station cabinet fits between the washers and the wall.
10. Using appropriate handling equipment, lift the charging station,
11. and place it on the studs,
12. tighten the bolts to the recommended torque depending on the model chosen (6 Nm for that of RS PRO brand / 6.5 Nm for that of RAWL FIXINGS brand).
13. Screw the 2 bolts and washers into the bottom fixings through the holes in the charging station cabinet, and tighten them to the torque recommended for the chosen model (6 Nm for the RS PRO brand / 6.5 Nm for the RAWL FIXINGS brand).

4.1.2. INSTALLATION OF CHARGING STATION ON A WORK SURFACE

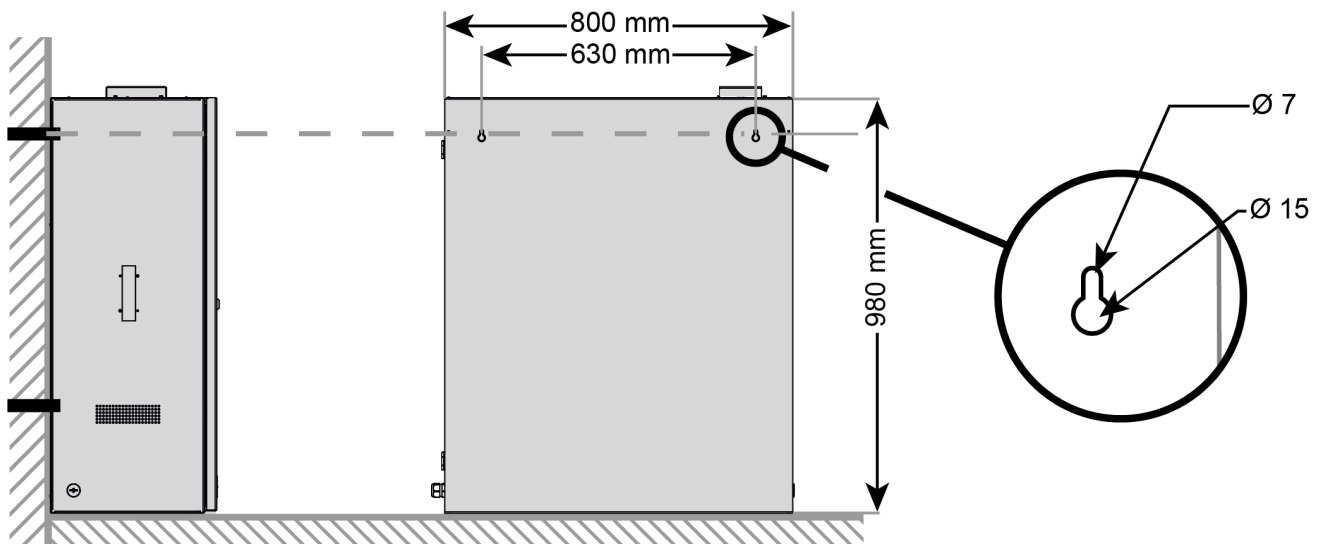

56_20_022



Warning

To ensure proper stability, it is essential that the Charging station is correctly positioned. The cabinet must be placed onto a work surface and rest against a wall.

The work plan must be carefully considered. It must be stable, dimensioned and designed to support the weight of the Charging station and made of a fire-resistant material.

1. The two upper drill holes are used to fix the cabinet to the wall. Drill 2 holes with a diameter of 12 mm and a length of 55 mm, at the positions specified above.

For this, use bolts and screws (not supplied) to suit the type of supporting surface.

4.1.3. POSITIONING OF THE POWER CABLE

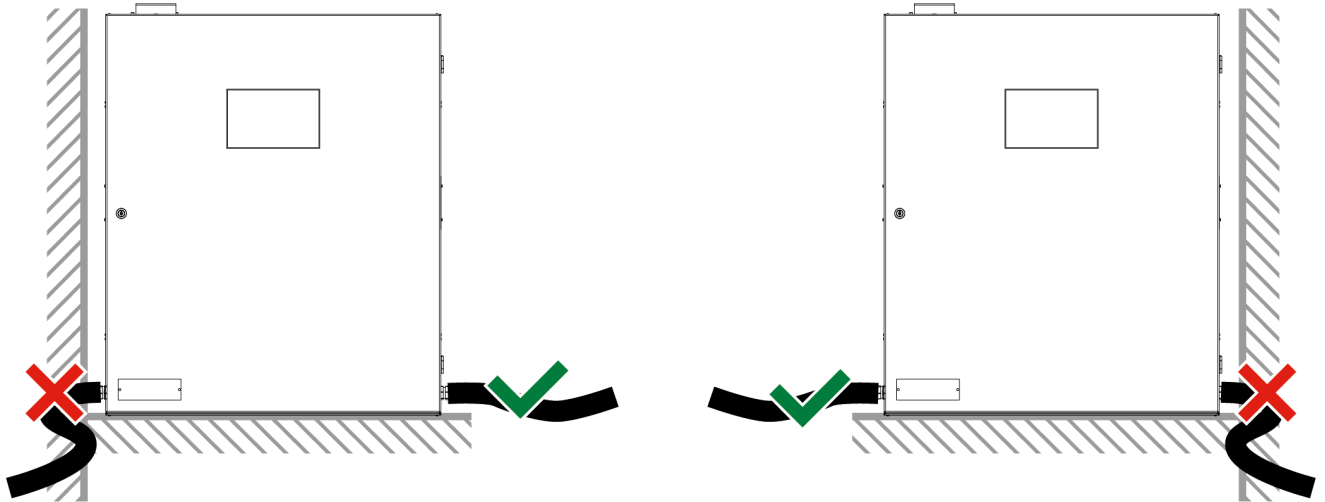

56_20_023

Depending on the position of the charging station cabinet, the qualified electrician who connects it can change the position of the power cable of the Charging station (refer to Section 4.3, “Changing the position of the power cable”).

4.2. ELECTRICAL INSTALLATION



Warning

Any intervention in the electrical box must be done by a professional electrician (risk of electric shock).

The electrical network must be equipped with a 30mA differential circuit-breaker compliant with electrical safety standards for protection of persons, and a C16 circuit-breaker with SECTIONING SWITCH DEVICE to connect the charging station.

4.3. CHANGING THE POSITION OF THE POWER CABLE

1. To access the power cable, remove the 3 screws on the vertical plate (at the bottom of the charging station cabinet) using a screwdriver.
2. Remove the vertical plate.

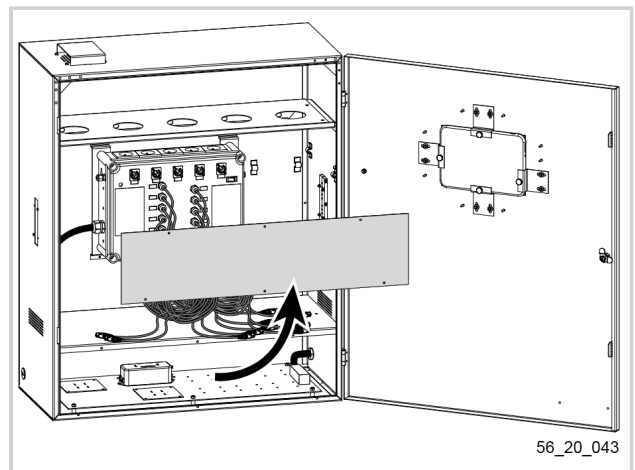

56_20_043

3. Unscrew the locknut on the blanking plate (15) to release the left hand outlet from the cabinet.
4. Unscrew the locknut of the cable grommet (16).

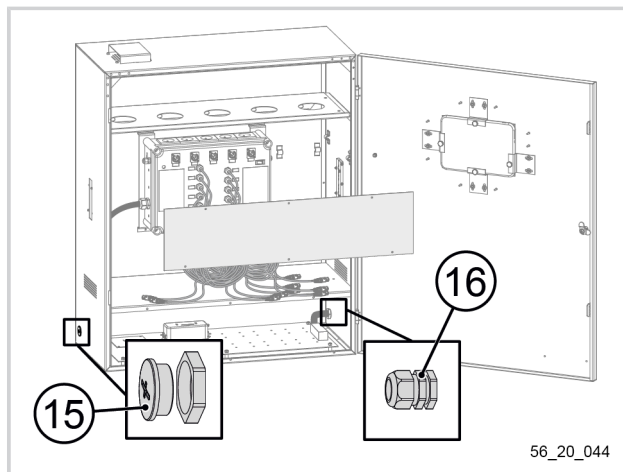

5. Remove the power cable (6) from the right hand outlet of the cabinet.
6. Pass the power cable (6) through the left hand outlet of the cabinet.
7. Hold the power cable in place with the cable grommet and the locknut, and tighten it (8Nm).
8. Torque tighten (8Nm).
9. Close off the right hand outlet with the blanking plate and locknut.
10. Install the metal wall at the bottom of the cabinet.
11. Fit the 3 screws.

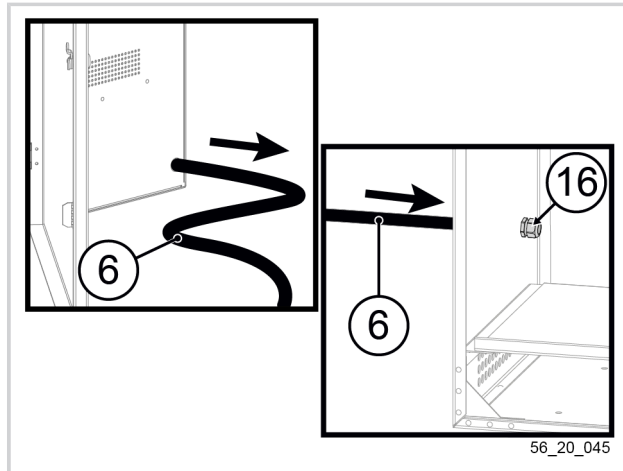

Warning

Take care not to damage the cables or components in the space behind the vertical plate while you are working.

When connecting to the customer's power supply unit, observe the standard colour code:

- Brown = phase
- Blue = neutral
- Green/yellow = earth

4.4. INSTALLATION OF CABLES

In order to adapt to the specific installation constraints of the user, the PELENC CHARGING STATION has two side faces, both equipped with a slot allowing the cables from inside the charging station cabinet to exit.

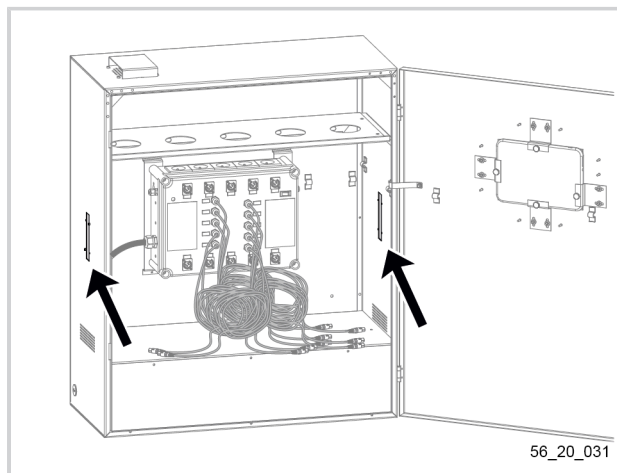

1. Choose one of the slots on the side faces of the Charging station and pass the 10 cables coming from the electrical box one by one.

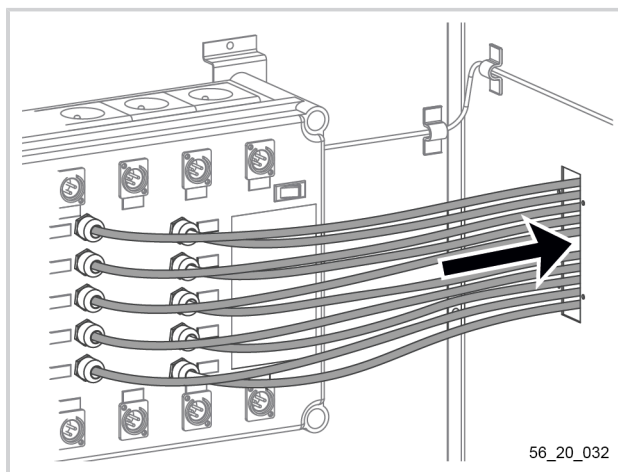

2. Put the cable grommet (14) in place and partially tighten the two fixing screws placed at its ends.
2. Fit the cables in the notches provided for this purpose.
2. Tighten up the cable grommet.
2. Do up the 3 screws to keep it around the cables.

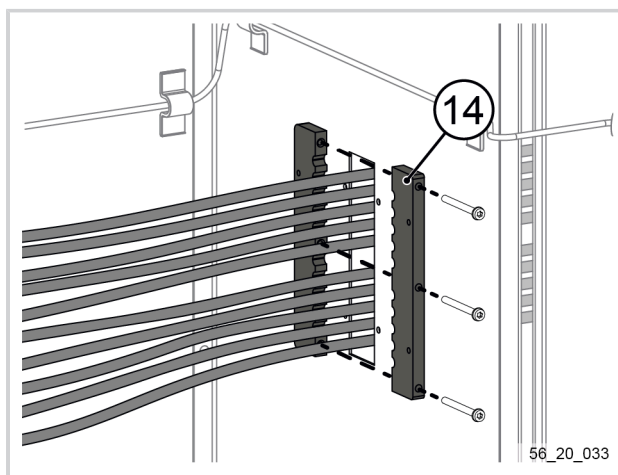

6. Fix the cable grommet to the cabinet with the 4 screws and nuts supplied.

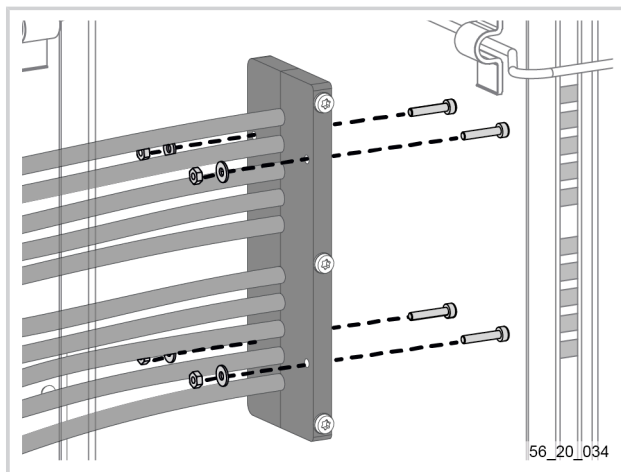

7. Install the blanking plate (13) at the unused outlet on the side face of Charging station.
7. Fit the 2 screws.

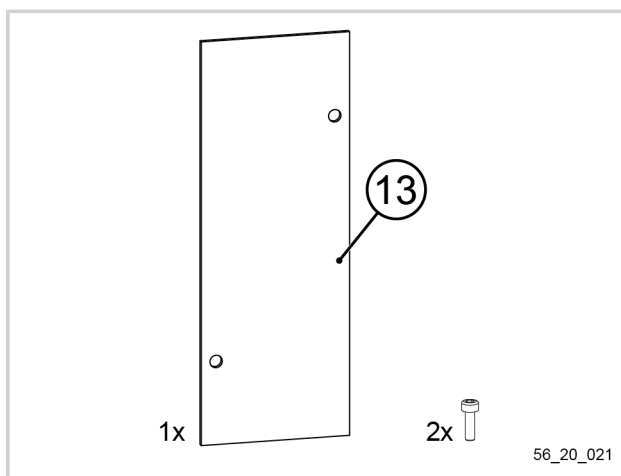

4.5. INSTALLING CHARGERS

To facilitate the installation of the chargers, the upper shelf (8) must first be removed.

1. Unscrew the nuts on either side of the top shelf (8) in the Charging station.

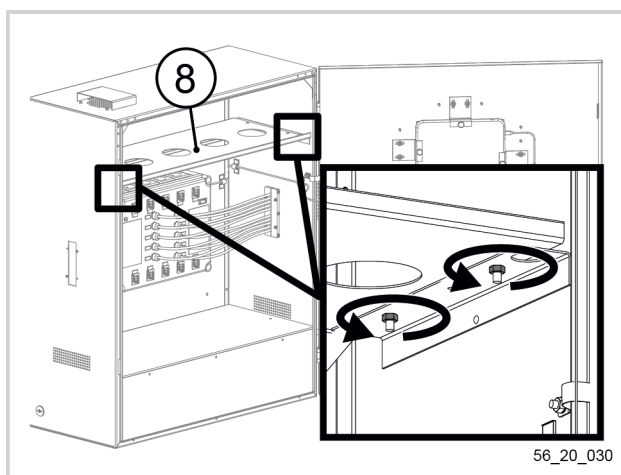

2. Remove the shelf (8) from its position.

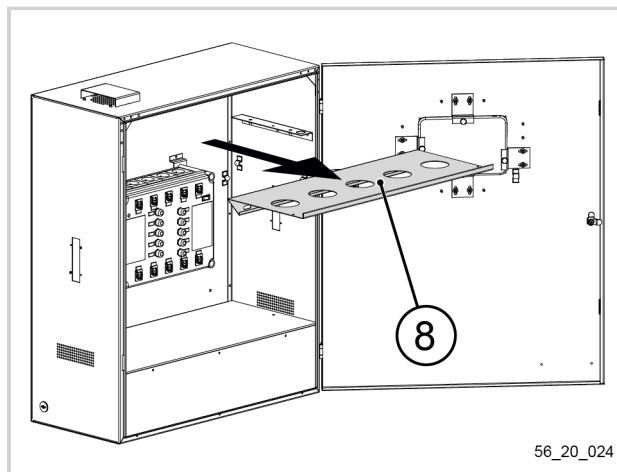

3. Distribute the chargers on each of the two shelves provided for this purpose.

Position any Quick Chargers in the middle of the shelves. These will be connected to the sockets marked in red (numbers 3 and 8).

Here is the configuration recommended to reach a suitable and authorized charging power relative to safety standards:

- 2 x 7.6 A chargers
- 4 x 3 A chargers
- 4 x 2.2 A chargers

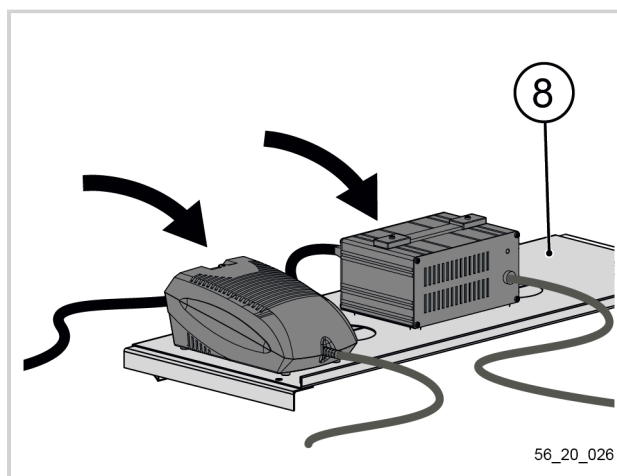

Note

Up to 10 chargers can be installed in the cabinet, including a maximum of two quick chargers.

4. In order to facilitate their installation in the electrical box, identify the charger cables as pairs when installing them (using colours or numbers).

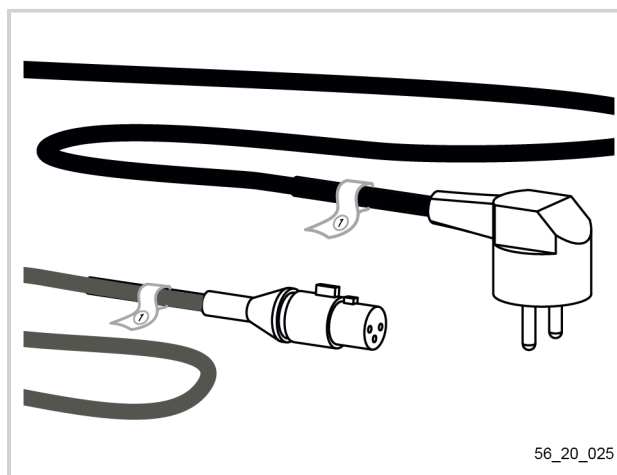

5. Keep around 40cm of cable free between charger and socket.
5. Attach the rest of the cable to the back of the shelf using a cable grip passed through the holes provided.

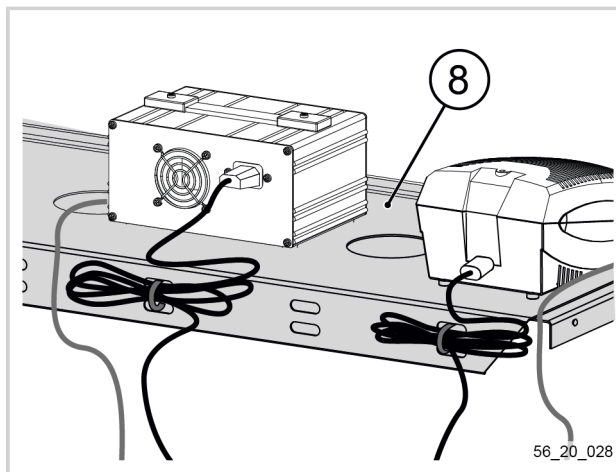

7. Once the chargers are in place, put the shelf back in the Charging station.

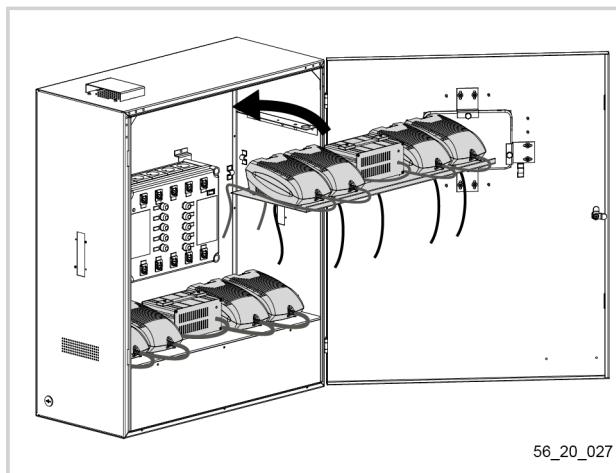

Connecting chargers



Warning

When connecting the chargers to the electrical box, it is important to respect the connection correspondences between the sockets.

The charging station electrical box includes:

- 10 power connectors (A) for chargers.
- 10 XLR connectors (B) for connecting the chargers to the electrical box.
- 10 output cables (C) to supply the batteries.

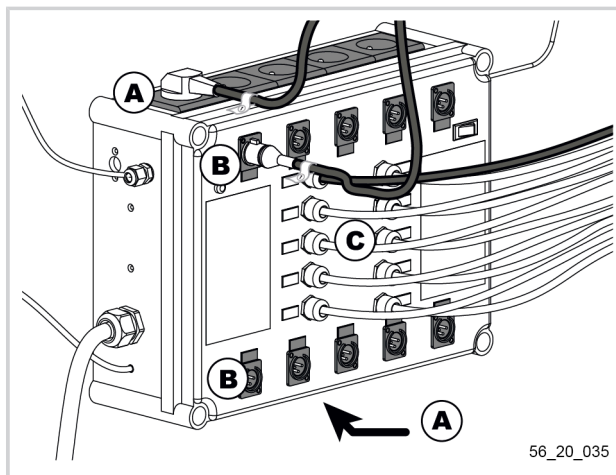

Each electrical outlet has an XLR connector and an output cable to the battery. This is what determines the identification and management of the batteries by the Charging Station application.

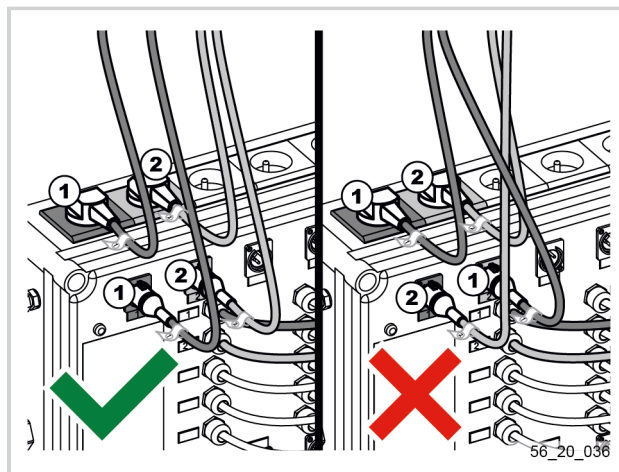

4.6. INSTALLATION OF TOUCHSCREEN TABLET.

1. Manually loosen the 4 pressure screws (17) located on the retaining brackets (18).

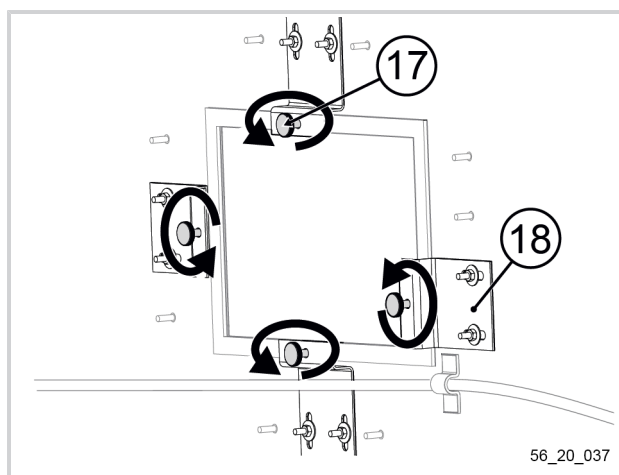

2. Remove the nuts and washers from the upper bracket.
2. Remove the upper bracket.

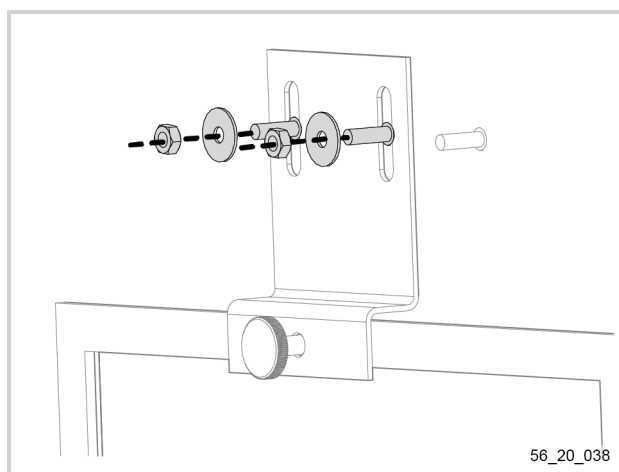

4. Position the support brackets so that the buttons and the charging connector of the tablet remain accessible.
4. Lightly loosen the nuts holding one of the side brackets.
4. Carefully insert the tablet between brackets and door (making sure you do not scratch the tablet's screen with the upper studs).
4. Put the side bracket back against the tablet and tighten its nuts.
4. Retighten the nuts.
4. Reposition the upper bracket against the tablet and secure it with screws and washers.
4. Tighten the 4 pressure screws (not too tightly).
4. Connect the tablet's charging cable to its connector.

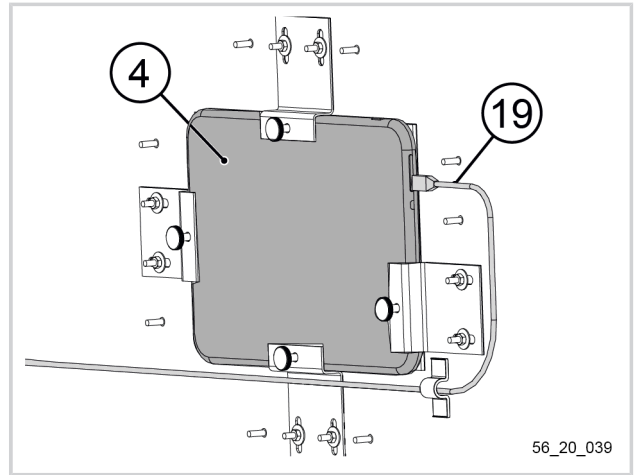

56_20_039

4.7. FORCED POWER SWITCH

The switch (11) located on the electrical box makes it possible to switch the Charging station into forced operation: the chargers are then permanently powered.

This mode allows the chargers to be used to recharge the batteries if the tablet is not operating correctly.

In normal use of the PELLENC CHARGING STATION and most of the time, this switch is in the Off position ("O" pressed).

1. To activate forced operation, turn the switch to the "I" position ("I" pressed).

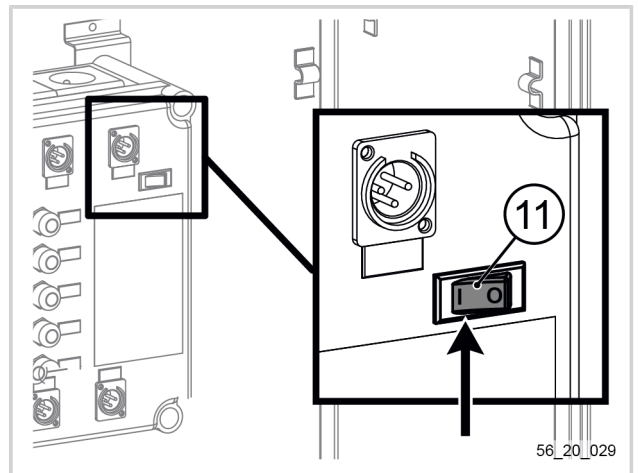

56_20_029

4.8. FIRST STARTUP

1. Check that the switch (11) is not in the forced override on position.
2. Check that the charging station is connected to the circuit-breaker.
3. Switch the charging station on.
4. Turn the tablet on by pressing its start button for 5 seconds.

Note

The tablet may take several minutes to start up.

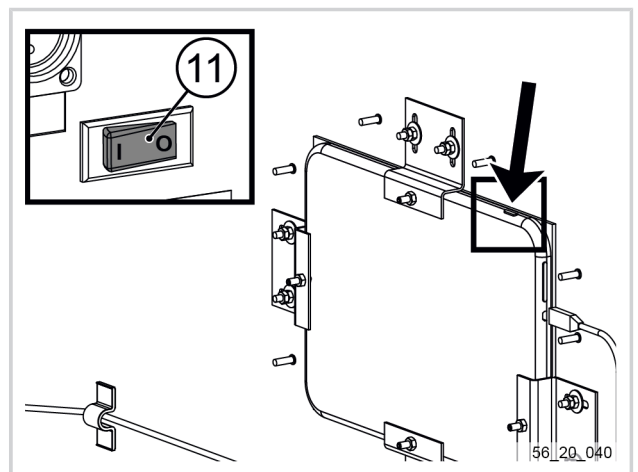

56_20_040

5. Once it is turned on, close the cabinet.
6. Turn the key in the lock on the cabinet door.

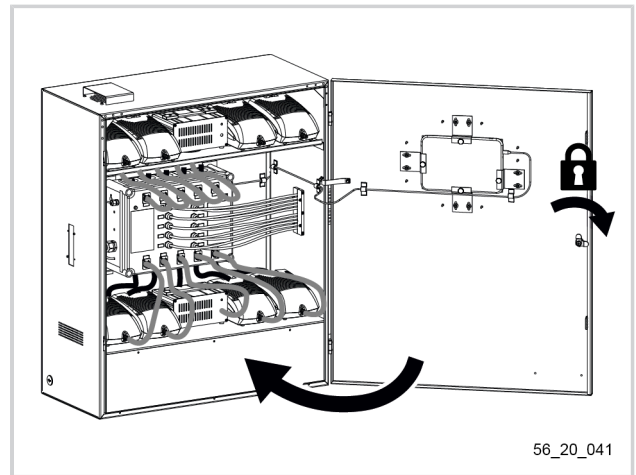

1. Side swipe the screen saver to the side to unlock the tablet.

You have access to the main screen.
2. Select the application by pressing on the "Charging Station" logo.

Note

If the display is too dark, it is possible to adjust the screen brightness in the tablet settings menus and to deactivate the "automatic brightness" function (refer to the instructions for the touch tablet used).

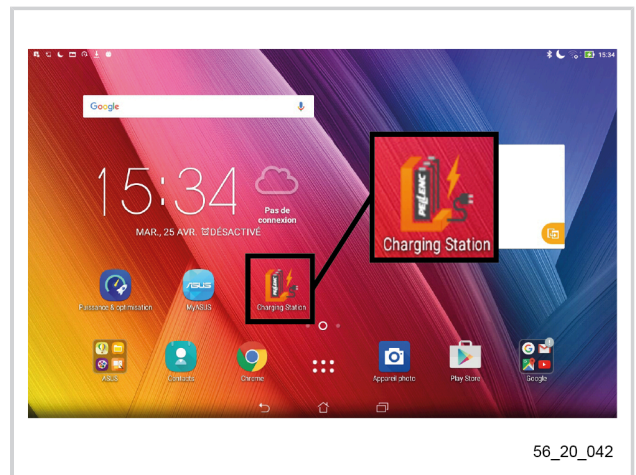

5. USE

5.1. HMI (HUMAN-MACHINE INTERFACE)

5.1.1. PRESENTATION OF THE HMI

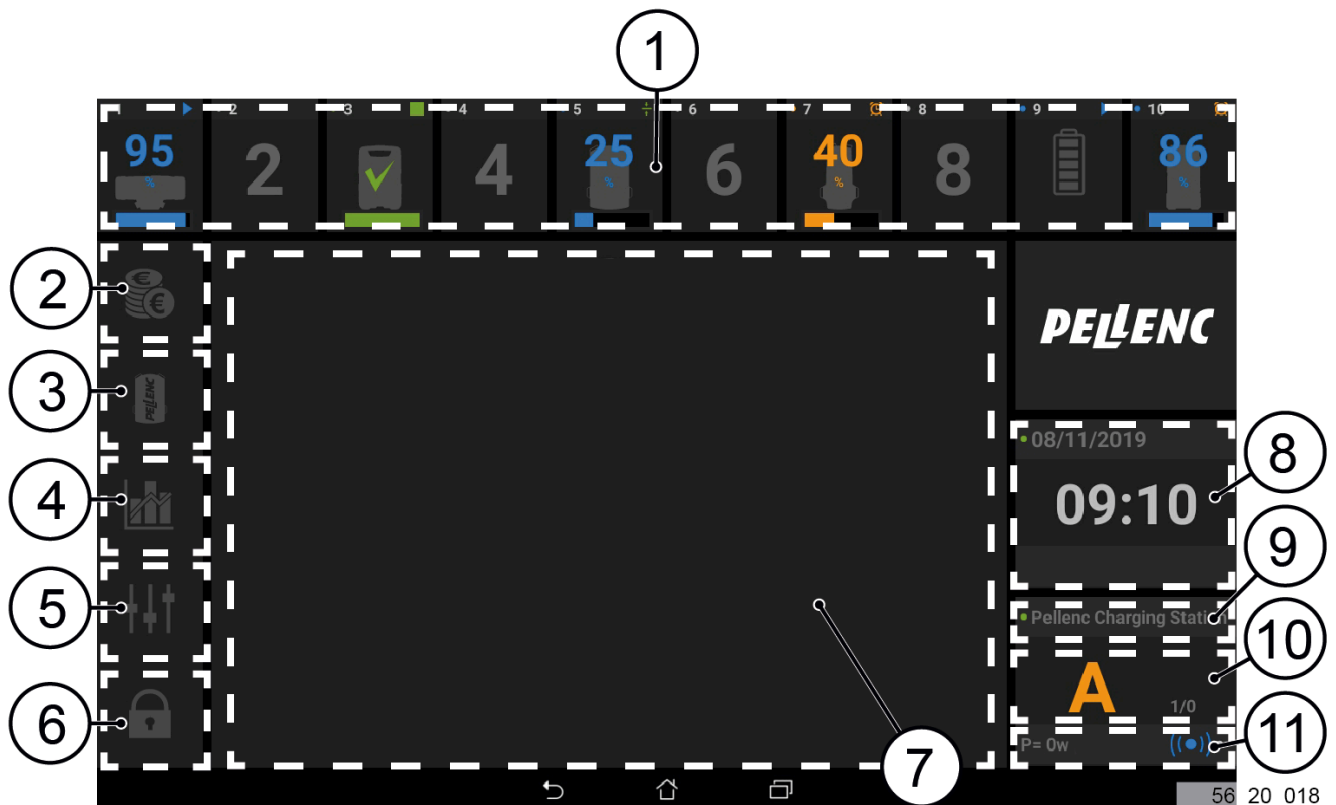

- | | |
|---|--|
| 1. Visualization of the distribution of batteries according to the chargers connected in the charging station | 7. Main screen / display of selected menu |
| 2. savings / consumption / environment menus | 8. Date and time |
| 3. Battery settings menu | 9. Name: PELLENC CHARGING STATION (by default) |
| 4. Statistics menu | 10. Name and identification of connected charging stations |
| 5. Settings / conversions menu | 11. Real time power consumption of chargers / Bluetooth connection indicator |
| 6. Locking menu | |

5.1.2. SETTINGS / CONVERSIONS MENU

This menu is used to enter the data needed to calculate the numerical data in the “savings, consumption, environment” menu.

The statistics calculated by the charging station depend on the data entered by the user. These data have to be kept up to date regularly, so that the calculations correspond as closely as possible to the real situation.



Select the Settings menu, **zone A**, then the Conversions tab **zone B** to access the above page.

Zone C: Estimation of power consumption of a PELLENC portable power tool and consumption of a petrol-powered tool (fuel mixture).

Zone D: Price

1. D1: 1- Price per kWh according to electricity supplier rates.
2. D2: 2- Price of a litre of fuel (mixture).

Note

Adjust values according to current price rates.

Zone E: CO₂ emissions

1. E1: CO₂ emissions to produce 1kWh.
2. E2: CO₂ emissions for production and consumption of 1 litre of fuel (mixture).

Note

Adjust values as a function of the quantity of CO₂ emissions.

Zone F: Conversion rate

1. Select the different boxes one after another.
2. Enter the values using the numeric keypad that is displayed on screen.
3. Confirm input with the "Enter" key.

Note

Once the user has defined his parameters, it is possible to lock the data by pressing on the "padlock" icon. The unlock code to use is 57182.

5.1.3. DETAILS OF CALCULATIONS FOR SAVINGS MADE

1 kWh battery corresponds on average to around 3.5L of mixture (fuel + oil) used to operate a petrol-driven tool.

Important

The following calculations give examples taken from estimated values at the time the manual was produced. The statistics calculated by the charging station depend on the data entered by the user. These data have to be kept up to date regularly, so that the calculations correspond as closely as possible to the current real situation.

- 5.1.3.1. CALCULATION OF AVERAGE SAVINGS MADE

In the application on the tablet, the default price displayed of the fuel mixture is 1.5 € per litre.

So 1kWh consumed by a Pellenc portable power tool is the equivalent of $3.5 \times 1.5 = 5.25$ € fuel mix consumed to run a petrol-driven tool.

In France the price of 1 kWh is 0.16 €.

For 1kWh consumed using a PELLENC power tool, the average saving compared to use of a petrol-driven tool is: $5.25 - 0.16 = 5.09$ €.

- 5.1.3.2. CALCULATION OF CO₂ EMISSIONS SAVINGS

The carbon footprint of fuel mixture is 2.54kg / L of CO₂.

So CO₂ consumed by a PELLENC portable power tool is the equivalent of $3.5 \times 2.54 = 8.90$ kg of CO₂ emitted by using a petrol-driven tool.

For 1 kWh consumed when using a PELLENC power tool, the average saving in CO emissions₂ compared to the use of a petrol-driven tool is: $8.90 - 0.09 = 8.81$ kg de CO₂.

5.1.4. SAVINGS / CONSUMPTION / ENVIRONMENT MENU

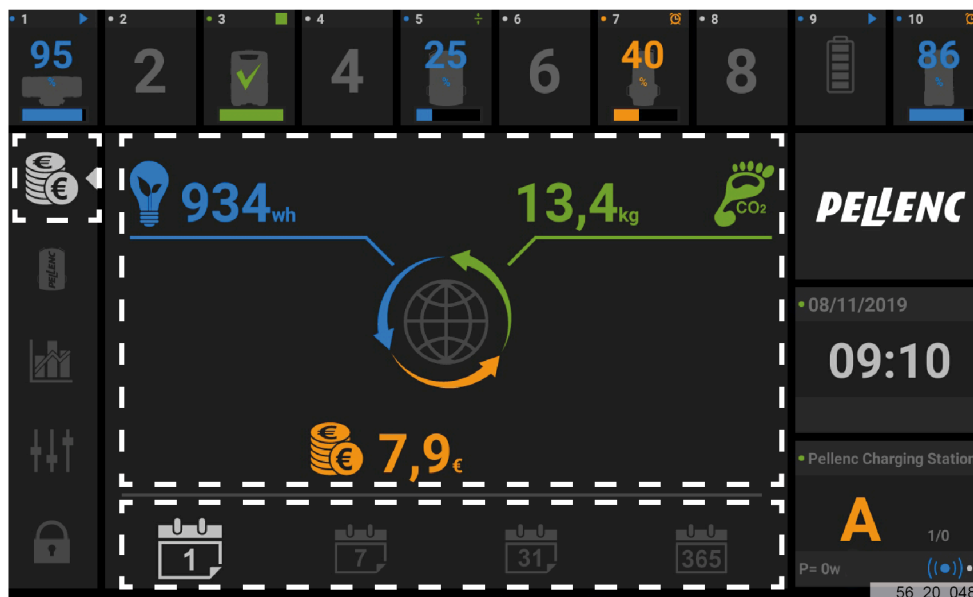

Display of numerical data:

- In orange: average saving using a power tool instead of a petrol-driven tool (parameters of application need to be set).
- In blue: average electrical power consumed by the Charging station to recharge the batteries.

- In green: CO2 emissions avoided relative to a petrol-driven tool

Data available per day, per week, per month or per year.

5.1.5. BATTERY SETTINGS MENU

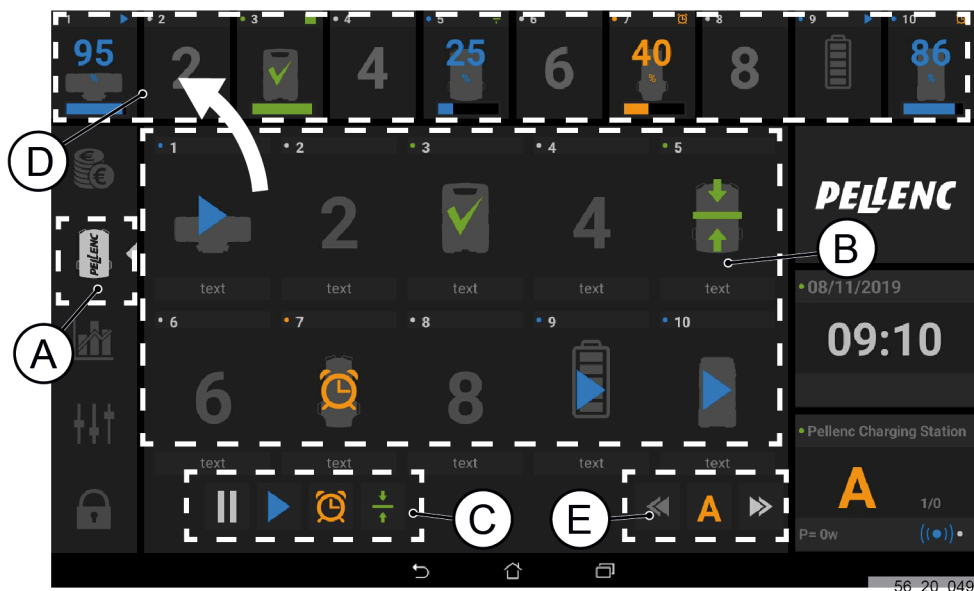

Zone A : selection of the battery setting menu





Note

A press and hold on one of the icons representing one of the batteries in zone A activates this battery (we speak of activating the channel).

If the battery is already activated, a press and hold will switch off the activation.

Zone B : selection screen, allocation of actions on the batteries

Zone C : actions available:

	Stop charging
	Activate charging
	Delay charging (see Section 5.1.6, "Charging time (day-time/nighttime) setting menu")
	Maintain battery charged

To apply an action on one / more batteries: select the battery (ies) in zone B, then press release on the icon representing the chosen action (zone C).

To apply an action to all batteries: press and hold on the icon representing the chosen action (zone C)

Zone D : display of the distribution and status of the connected batteries (strip visible on all screens) according to the 10 chargers in the charging station.

Battery charging	Battery 95% charged
Location empty	
Battery charge completed	Battery 100% charged
Battery charging, maintain charged once 100% charged	Battery 25% charged
Charge delayed	Battery 40% charged
Battery charging	Battery not recognised, information not available

Zone E : selection of the charging station (in the case where several charging stations are connected).

5.1.6. CHARGING TIME (DAYTIME/NIGHTTIME) SETTING MENU

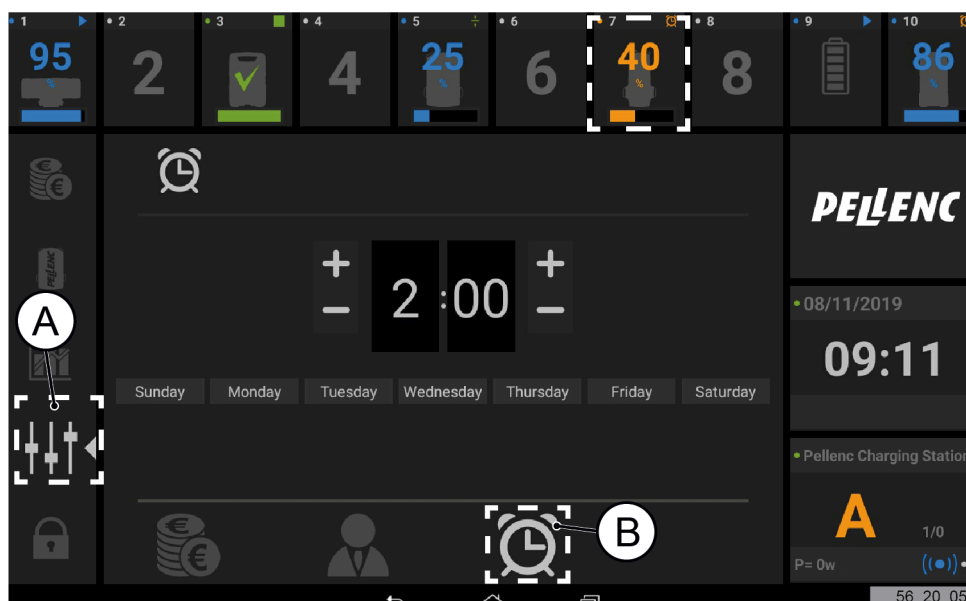

1. From the settings menu (A) select the delayed charging time setting for batteries (B).

Note

By default, on first use, the charging start time is set at 2am, and every day is selected.

It is possible to set hours, minutes and days of the week.

If no day is selected, the delayed charge will not be enabled.

Batteries shown in orange will be automatically recharged from the time set on the selected days.

5.1.7. STATISTICS MENU

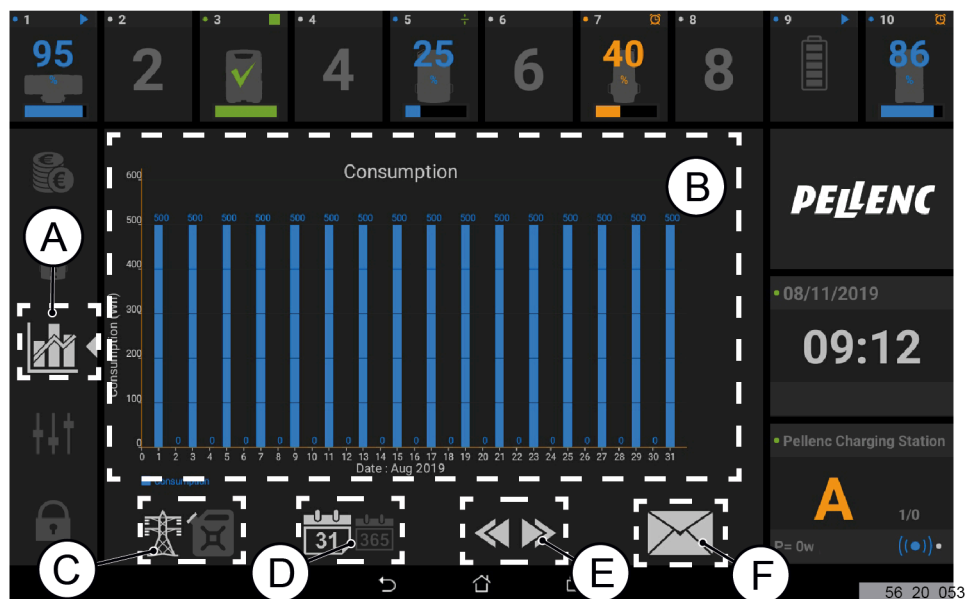

Zone A: Selection of Statistics menu

Zone B: Display statistics

Zone C: Equivalent fuel consumption

Zone D: Display period, by month or year

Zone E: Scroll through data

Zone F: Sending data by email (to define the email address for receiving mail, refer to Section 5.1.8, "Defining the email address for receiving mail").

5.1.8. DEFINING THE EMAIL ADDRESS FOR RECEIVING MAIL

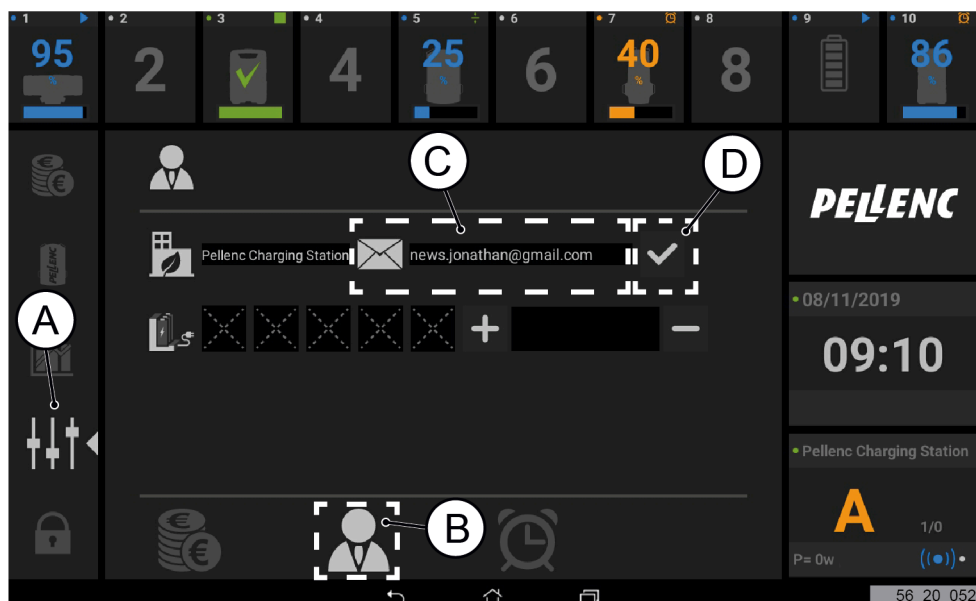

1. Select the Settings menu by pressing on the zone (A).

2. Press on the Customization menu (B).
3. Fill in the zone (C) with the email address which will receive the information concerning the Charging station.
4. Validate the email address by pressing on (D).

5.2. CHANGING TABLET - SAVING DATA

If there is a problem with the tablet, contact the PELLENC after-sales service

5.2.1. REPLACING THE TOUCHSCREEN TABLET

1. Disconnect the power supply cord of the tablet.
2. Carry out the entire procedure presented in Section 4.6, "Installation of touchscreen tablet."

5.2.2. SAVING DATA

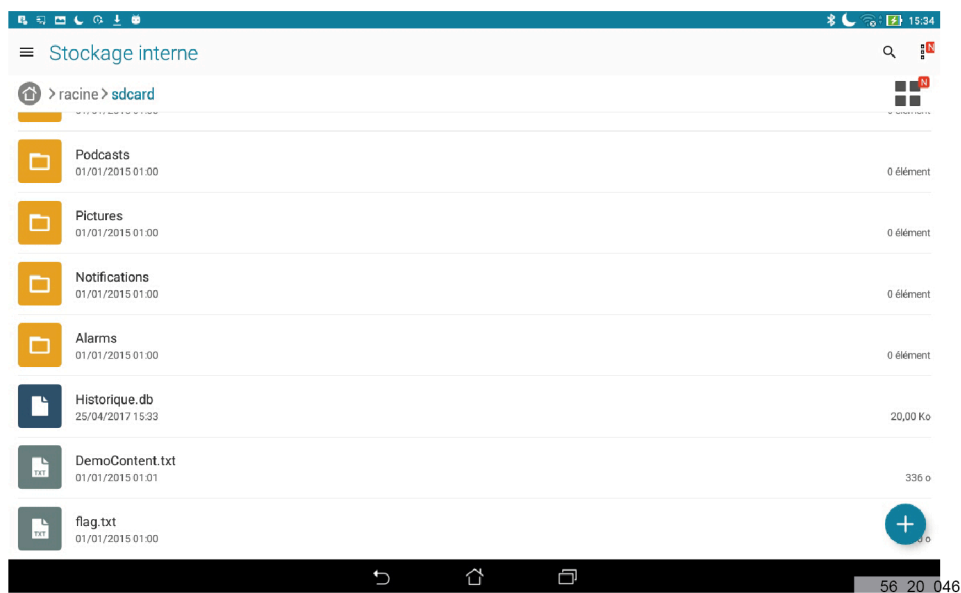

The data in the app are backed up automatically on the tablet every day. Back-up file: Historique.db

The user has the possibility of making a new backup of this file outside the tablet to recover his data and transfer them to a new tablet in the event of a failure.

The Historique.db file can be transferred by WIFI or Bluetooth, or straight onto a memory card inserted into the tablet (micro SD card not supplied).

The Historique.db can only be used by the Charging Station application.

5.2.3. CONNECTION BETWEEN TABLET AND CHARGING STATION

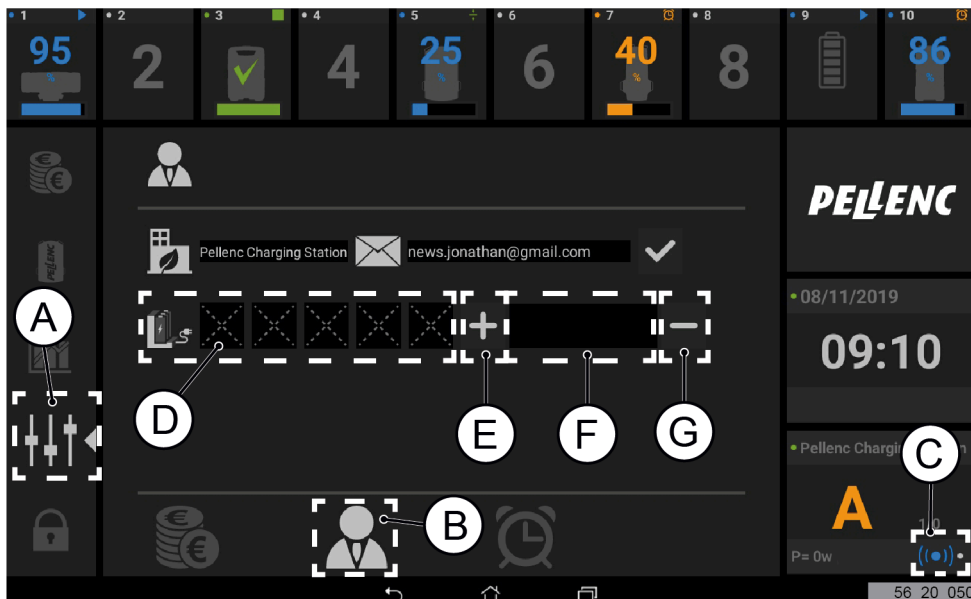

1. Select the Settings menu by pressing on the zone (A).
2. Press on the Customization menu (B).
3. Press + (E) to start a Bluetooth scan.
4. Connection suggestions are displayed.

Select "Pellenc BLE".

The connection indicator (C) in the bottom right corner of the screen indicates the connection status of the Charging station :

- if the indicator is grey and blinking: the charging station cabinet is not connected, a search for peripherals is in progress.
- If the indicator is green: the charging station cabinet and the tablet are paired.

Note

Zone (D) shows the charging station(s) which is/are synchronized with the tablet. Each icon in this area represents a charging station.

Each charging station is associated with a letter, visible in the lower right corner of the screen (and visible in all menus).

Up to 5 charging stations can be connected, identified by letters A, B, C, D and E.

5. Repeat the search for peripherals to connect another charging station.

To delete an already paired charging station:

1. select in the zone (F) the Bluetooth identifier of the charging station to be deleted,
2. press "-" (marked G). The charging station is then deleted.

6. SERVICE



Warning

Any intervention in the electrical box and its installation must be done by a professional electrician (risk of electric shock).

7. INCIDENTS AND TROUBLESHOOTING

7.1. INCIDENT AND TROUBLESHOOTING TABLE

Symptoms	Bluetooth link icon status	Probable cause	Check	Solutions	Repairer
Commands are no longer exchanged between the tablet and the charging station	Indicator	Installation powered-off	Circuit-breaker of the line to which the charging station is connected	Re-energize the line after verification	Qualified technician
	Indicator	The charging station is not paired with the tablet application	No charging station is paired.	Refer to the pairing procedure in the instruction manual	User
	Indicator	Tablet Bluetooth is not activated	The Bluetooth status of the tablet is deactivated	Activate Bluetooth in tablet Settings	User
	Indicator	The charging station is powered on, but the tablet no longer detects the charging station Bluetooth	Do a Bluetooth scan to check the absent charging station signal	Turn off the tablet's Bluetooth for 10 seconds and then turn it on again. Relaunch the Charging Station application	User
	Indicator	The electronic circuit board is defective	PELENC authorised distributor	Change the circuit board	PELENC authorised distributor
Battery not recognized	Fixed	The battery is not compatible with this function	Check the list of compatible batteries		
	Fixed	The electronic circuit board is defective	PELENC authorised distributor	Change the circuit board	PELENC authorised distributor
Sending email does not work	Fixed	The tablet is not connected to a WIFI Internet network	Check the WIFI status in the tablet settings	Activate and configure the tablet WIFI	User
	Fixed	User email address is not configured	Check the email address configured in the appropriate section	See the configuration procedure	User

8. WARRANTIES

8.1. GENERAL WARRANTIES

8.1.1. STATUTORY WARRANTY

- 8.1.1.1. LATENT DEFECTS WARRANTY

Apart from the commercial warranty provided for under Article II, Article 1641 of the Civil Code provides that "the seller is bound to a warranty on account of latent defects of the object sold which render it unfit for the use for which it was intended, or which would impair said use to the extent that the buyer would not have acquired it, or would only have given a lesser price for it, had he known of them".

Article 1648 of the Civil Code "The action resulting from latent defects must be brought by the purchaser within two years after the discovery of the defect. "

- 8.1.1.2. LEGAL WARRANTY OF CONFORMITY

Article L.217-4 of the Consumer Code "The seller delivers goods in conformity with the contract and is liable for defects of conformity existing upon delivery.

The seller is also liable for any lack of compliance resulting from the packaging, assembly or installation instructions whenever its contractual liability is engaged in this regard or the latter are carried out under its responsibility

Article L.217-5 of the French Consumer Code "Goods are compliant with the contract":

1. Where they are fit for the purpose normally expected of similar goods and, where applicable:
 - If it matches the description given by the seller and possesses the qualities that were presented to the purchaser in the form of a sample or model;
 - If it possesses the qualities that a purchaser can reasonably expect given the public statements made by the seller, the producer or its representative, especially in advertising or labelling;
2. Or, if it has the characteristics defined by mutual agreement of the parties or is fit for any particular purpose that the buyer made known to the seller and that the latter accepted.

Article L.217-12 of the Consumer Code "legal action resulting from lack of conformity lapses two years after delivery of the goods".

8.1.2. COMMERCIAL WARRANTY PELLENC

- 8.1.2.1. CONTENT

8.1.2.1.1. GENERAL INFORMATION

In addition to legal warranties, client users benefit from the commercial warranty on products PELLENC covering the exchange and replacement of parts recognised as being out of order, due to machining defects, assembly defects or material defects, whatever the cause.

The warranty is fully integral to the product sold by PELLENC.

8.1.2.1.2. SPARE PARTS

The commercial warranty also covers original PELLENC spare parts, excluding labour and to the exclusion of certain parts of each product provided at delivery.

- 8.1.2.2. DURATION OF THE WARRANTY**8.1.2.2.1. GENERAL INFORMATION**

PELLENC Products are guaranteed under the commercial warranty as from delivery to the customer for a period of two (2) years for products connected to a PELLENC battery, and for a period of one (1) year for other PELLENC products.

8.1.2.2.2. SPARE PARTS

PELLENC Replacement parts replaced under the product warranty are guaranteed under the commercial warranty as from delivery of the PELLENC product to the customer user for a period of two (2) years for products connected to a PELLENC battery, and for a period of one (1) year for other PELLENC products.

In the case of products connected to a PELLENC battery, parts that are replaced under the product warranty after the 12th month of use, are covered for a period of one (1) year.

8.1.2.2.3. WARRANTY EXCLUSIONS

Excluded from the commercial warranty are products that have been subject to abnormal use, or were used under conditions and for purposes other than those for which they were manufactured, especially in the case of non-compliance with conditions stipulated in this user manual.

It does not apply in case of shock, fall, neglect, lack of supervision or maintenance or in case of transformation of the product. Also excluded from the warranty are products that have been subject to tampering, alteration or modification by the client user.

Wear parts and/or consumables cannot be covered by the warranty.

- 8.1.2.3. IMPLEMENTATION OF THE COMMERCIAL WARRANTY**8.1.2.3.1. PRODUCT COMMISSIONING AND COMMISSIONING DECLARATION**

The DISTRIBUTOR undertakes to complete the computer commissioning declaration form, no later than eight days after the delivery of the property to the user customer, in order to activate the latter on the www.pellenc.com website under "warranties and training" in the "extranet" menu, using the identifier previously provided to them by PELLENC.

Failing that, commissioning declaration will not be effective and implementation of the commercial warranty PELLENC will not occur. As a consequence thereof, the DISTRIBUTOR must ensure the financial burden of its intervention under the warranty without being able to pass on the cost to the client user.

The DISTRIBUTOR shall also undertake to complete the warranty card or the certificate of warranty and commissioning for self-propelled equipment provided with the product after having the client user sign and date it.

8.1.3. PAID AFTER-SALES SERVICE**- 8.1.3.1. GENERAL INFORMATION**

Malfunctions, breakdowns, breakages resulting from misuse, neglect or improper maintenance by the client user as well as malfunctions resulting from normal wear of the product are subject to the payment of after-sales service, even during the period of the legal and commercial warranty. After-sales service repairs that fall outside of the legal and commercial warranty also include maintenance, adjustments, diagnostics of all types, and cleaning without the present list being exhaustive.

- 8.1.3.2. WEAR PARTS AND CONSUMABLES

Wear parts and consumables also fall within the after-sales service.

- 8.1.3.3. SPARE PARTS

Paid after-sales service also covers original PELLENC spare parts, excluding labour and outside the legal and commercial warranty period.

In case of replacement of original PELLENC spare parts in the context of after-sales service, said latter are covered by a warranty of one year as from the installation date.

9. EC STATEMENT OF COMPLIANCE

9.1. "EC" DECLARATION OF CONFORMITY: PELLENC CHARGING STATION

MANUFACTURER	PELENC
ADDRESS	Quartier Notre-Dame - 84120 Pertuis (France)

ENTITY AUTHORIZED TO COMPILE THE TECHNICAL FILE	PELENC
ADDRESS	Quartier Notre-Dame - 84120 Pertuis (France)

We hereby declare that the machine referred to below as:

GENERIC DENOMINATION	CHARGE MONITOR
FUNCTION	For organising charging of PELLENC tool batteries
COMMERCIAL NAME	PELENC CHARGING STATION
TYPE	PELENC CHARGING STATION
MODEL	PELENC CHARGING STATION
SERIAL No.	56U00001 - 56U99999 56V00001 - 56V99999 56W00001 - 56W99999

Is in conformity with the following other directives and/or relevant provisions:

- 2014/53/EU RED Directive
- 2011/65/EU ROHS Directive
- 1907/2006 REACH Regulation
- 2012/19/EU WEEE Directive

The following harmonised European standards have been used in whole or in part:

- EN 300 328 V2.1.1: 2016

THE FOLLOWING OTHER STANDARDS AND TECHNICAL SPECIFICATIONS HAVE BEEN USED:

- EN 301 489-1 V2.2.0: 2017
- EN 301 489-17 V3.2.0: 2017
- EN 60335-1: 2012 + A1C: 2014 + A11: 2014
- EN 60335-2-29: 2004 + A1: 2004 + A2: 2010

ISSUED IN PERTUIS, 01/12/2017

JEAN-MARC GIALIS

CEO



PELLENC

   www.pellenc.com

PELLENC
Quartier Notre Dame - 84120 Pertuis (France)

