

ENG

Translation of the original operating instructions manual



HEDGE-TRIMMER HELION ALPHA

Operating instructions

54_146380-D
06/2022

READ THE USER GUIDE CAREFULLY BEFORE USE



www.pellenc.com

PELLENC

TABLE OF CONTENTS

1. INTRODUCTION	5
2. SAFETY	6
2.1. INTENDED USAGE	6
2.2. GENERAL POWER TOOL SAFETY WARNINGS	6
2.2.1. WORK AREA SAFETY	6
2.2.2. ELECTRICAL SAFETY	6
2.2.3. PERSONAL SAFETY	7
2.2.4. POWER TOOL USE AND CARE	7
2.2.5. BATTERY TOOL USE AND CARE	7
2.2.6. SERVICING	8
2.2.7. MANAGEMENT OF THE RECYCLING AND RECOVERY OF WASTE FROM YOUR TOOL	8
2.3. SAFETY WARNING FOR THE HEDGE TRIMMER	8
2.4. SAFETY WARNINGS FOR THE POLE HEDGE-TRIMMER	8
2.5. SAFETY SIGNAGE	9
2.6. PERSONAL PROTECTION EQUIPMENT (PPE)	10
3. DESCRIPTION AND TECHNICAL FEATURES	10
3.1. DESCRIPTION OF THE HEDGE-TRIMMER	10
3.2. TECHNICAL FEATURES	11
3.2.1. TOOL FEATURES	11
3.2.2. VIBRATION AND NOISE EMISSION VALUES	11
4. COMMISSIONING	12
4.1. UNFOLDING THE HEDGE-TRIMMER BLADE	12
4.2. CONNECTING AND DISCONNECTING THE PELENC ALPHA 260 OR 520 BATTERY	12
4.2.1. BATTERY CONNECTION	13
4.2.2. DISCONNECTING THE BATTERY	13
5. USE	14
5.1. PROTECTIVE SLEEVE	14
5.2. ADJUSTING THE HEDGE-TRIMMER BLADE ANGLE	15
5.2.1. HEDGE-TRIMMER BLADE WORKING POSITION	15
5.2.2. TRANSPORT POSITION / FOLDING THE HEDGE-TRIMMER BLADE	15
5.3. ADJUSTING THE WORKING POSITION	16
5.3.1. HOLDING THE TOOL	16
5.3.2. ADJUSTING THE CARRYING STRAP	17
5.4. POWER ON OR OFF	19
5.4.1. POWER "ON"	19
5.4.2. POWERING OFF	20
5.5. CUTTING SPEED ADJUSTMENT	20
5.5.1. CUTTING SPEED RECOMMENDATION	20
5.5.2. SPEED SELECTION	21
5.6. START-UP	21

5.7. HEDGE TRIMMING TECHNIQUES	22
5.7.1. HORIZONTAL TRIMMING	23
5.7.2. TRIMMING AT HEIGHT	23
5.7.3. TRIMMING AT LOW LEVEL	23
6. SERVICE	24
6.1. ANNUAL OVERHAUL	24
6.2. MAINTENANCE ADVICE	24
6.3. TOOL MAINTENANCE TABLE	25
6.4. TIGHTENING BLADES	25
6.5. CLEANING THE BLADES	26
6.6. SHARPENING THE BLADES	27
6.7. HEDGE-TRIMMER BLADE LUBRICATION	28
7. INCIDENTS AND TROUBLESHOOTING	29
7.1. TABLE OF INCIDENTS AND BREAKDOWNS - TROUBLESHOOTING	29
7.2. SUMMARY OF DISPLAY MESSAGES	30
8. STORAGE AND TRANSPORT	30
8.1. STORAGE	30
8.2. TRANSPORT	30
9. ACCESSORIES AND CONSUMABLES	31
9.1. ACCESSORIES INCLUDED	31
9.2. OPTIONAL ACCESSORIES	31
9.3. CONSUMABLES	31
10. WARRANTIES	32
10.1. GENERAL WARRANTIES	32
10.1.1. STATUTORY WARRANTY	32
10.1.2. COMMERCIAL WARRANTYPELLENC	32
10.1.3. PAID AFTER-SALES SERVICE	33
11. EC STATEMENT OF COMPLIANCE	35
11.1. "EC" DECLARATION OF CONFORMITY: HELION ALPHA	35
11.2. "UK" DECLARATION OF CONFORMITY: HELION ALPHA	36

1. INTRODUCTION

Dear Customer,

Thank you for purchasing your Hedge-trimmer Helion Alpha. Properly used and maintained, this equipment will give you years of satisfaction.



Warning

In accordance with product liability laws, we are not responsible for damage caused by our product if the product includes an accessory that is not from the manufacturer or is not approved by the manufacturer. The use of any other accessory may increase the risk of injury.



Warning

Your machine contains numerous recoverable or recyclable materials. Return it to your dealer or, failing this, to an approved servicing centre to be treated.



Comply with the regulations in force in your country as concerns environmental protection associated with your activity.



Warning

It is imperative that you read through the ENTIRE user's manual guide before using or servicing the tool. Always comply with the instructions and illustrations provided in the user's manual.

Throughout the user's manual guide you will find advisory notes and information entitled: NOTE, IMPORTANT, ATTENTION and WARNING.

Points marked "NOTE" indicate additional information.

Points marked "IMPORTANT" warn the user of a potential risk for the equipment.

Points marked "ATTENTION" warn the user of a potentially hazardous situations which if not avoided may result in minor injuries.

Points marked "WARNING" warn the user of a potentially hazardous situation which if not avoided may result in serious injury or death.

The warning  indicates that damage resulting from failure to comply with the procedures and instructions is not covered by the warranty and the owner will be liable for any repair costs.

Safety indications are also given on the tool; they remind you of the safety precautions to be taken. Identify and read these indications before using the tool. Immediately replace any indications that may become partially illegible or deteriorated.

Refer to Section 2.5, "Safety signage" for the location diagram of the safety stickers affixed to the tool.

No part of this manual may be reproduced without the written permission of the company PELLENC. The illustrations provided in this manual are for information purposes only and are in no way contractual. The PELLENC company reserves the right to make any modification or improvement to its products as deemed necessary without inform-

ing customers already in possession of a similar model. This manual forms an integral part of the tool and must accompany the tool if it changes hands.

2. SAFETY

2.1. INTENDED USAGE

- The Hedge-trimmer Helion Alpha is a professional tool whose use is reserved exclusively for trimming vegetation.
- The PELLENC company accepts no responsibility for any damage caused by improper or unspecified use different from its original intention.
- The PELLENC company accepts no responsibility for any damage caused by the use of non-original parts or accessories.

2.2. GENERAL POWER TOOL SAFETY WARNINGS



Warning

Read all safety warnings, instructions, illustrations and specifications provided with this power tool. Failure to follow all instructions listed below may result in electric shock, fire and/or serious injury.

Note

Save all warnings and instructions for future reference.

The term "power tool" in the warnings refers to your mains-operated (corded) power tool or battery-operated (cordless) power tool.

2.2.1. WORK AREA SAFETY

1. **Keep the work area clean and well lit.** Cluttered or dark areas invite accidents.
2. **Do not operate power tools in explosive atmospheres, such as in the presence of flammable liquids, gases or dust.** Power tools create sparks, which may ignite the dust or fumes.
3. **Keep children and bystanders away while operating a power tool.** Distractions can cause you to lose control of the tool.

2.2.2. ELECTRICAL SAFETY

1. **Power tool plugs must match the outlet. Never modify the plug in any way. Do not use any adapter plugs with earthed (grounded) power tools.** Unmodified plugs and matching outlets will reduce risk of electric shock.
2. **Avoid body contact with earthed surfaces or grounded surfaces such as pipes, radiators, ranges, and refrigerators.** There is an increased risk of electric shock if your body is earthed or grounded.
3. **Do not expose power tools to rain or wet conditions.** Water entering a power tool will increase the risk of electric shock.
4. **Do not abuse the cord. Never use the cord for carrying, pulling or unplugging the power tool. Keep cord away from heat, oil, sharp edges or moving parts.** Damaged or entangled cords increase the risk of electric shock.
5. **When operating a power tool outdoors, use an extension cord suitable for outdoor use.** Use of a cord suitable for outdoor use reduces the risk of electric shock.
6. **If operating a power tool in a damp location is unavoidable, use a residual current device (RCD) protected supply.** Use of an RCD reduces the risk of electric shock.

2.2.3. PERSONAL SAFETY

1. **Stay alert, watch what you are doing, and use common sense when operating a power tool. Do not use a power tool while you are tired or under the influence of drugs, alcohol or medication.** A moment of inattention while operating power tools may result in serious personal injury.
2. **Use personal protective equipment. Always wear eye protection.** Protective equipment such as dust mask, non-skid safety shoes, hard hat, or hearing protection used for appropriate conditions will reduce personal injuries.
3. **Prevent unintentional starting. Ensure the switch is in the off-position before connecting to power source and/or battery pack, picking up or carrying the tool.** Carrying power tools with your finger on the switch or plugging in power tools with the switch in the on position can cause accidents.
4. **Remove any adjusting key or wrench before turning the power tool on.** A wrench or a key left attached to a rotating part of the power tool may result in personal injury.
5. **Do not overreach. Keep proper footing and balance at all times.** This enables better control of the power tool in unexpected situations.
6. **Dress properly. Do not wear loose clothing or jewelry. Keep your hair and clothing away from moving parts.** Loose clothes, jewelry or long hair can be caught in moving parts.
7. **If devices are provided for connection of dust extraction and collection facilities, ensure these are connected and properly used.** Use of dust collection can reduce dust-related hazards.
8. **Do not let familiarity gained from frequent use of tools allow you to become complacent and ignore tool safety principles.** A careless action can cause severe injury within a fraction of a second.

2.2.4. POWER TOOL USE AND CARE

1. **Do not force the power tool. Use the correct power tool for your application.** The correct power tool will do the job better and safer at the rate for which it was designed.
2. **Do not use the power tool if the switch does not turn it on and off.** Any power tool that cannot be controlled with the switch is dangerous and must be repaired.
3. **Disconnect the plug from the power source and/or remove the battery pack, if detachable, if from the power tool before making any adjustment, changing accessories, or storing power tools.** Such preventive safety measures reduce the risk of starting the power tool accidentally.
4. **Store idle power tools out of the reach of children and do not allow persons unfamiliar with the power tool or these instructions to operate the power tool.** Power tools are dangerous in the hands of untrained users.
5. **Maintain power tools and accessories. Check for misalignment or binding of moving parts, breakage of parts and any other condition that may affect the power tool's operation. If damaged, have the power tool repaired before use.** Many accidents are caused by poorly maintained power tools.
6. **Keep cutting tools sharp and clean.** Properly maintained cutting tools with sharp cutting edges are less likely to bind and are easier to control.
7. **Use the power tool, accessories and tool bits etc. in accordance with these instructions, taking into account the working conditions and the work to be performed.** Use of the power tool for operations different from those intended could result in a hazardous situation.
8. **Keep handles and grasping surfaces dry, clean and free from oil and grease.** Slippery handles and grasping surfaces do not allow for safe handling and control of the tool in unexpected situations.

2.2.5. BATTERY TOOL USE AND CARE

1. **Recharge only with the charger specified by the manufacturer.** A charger that is suitable for one type of battery pack may create a risk of fire when used with another battery pack.
2. **Use power tools only with specifically designated battery packs.** Use of any other battery packs may create a risk of injury and fire.
3. **When battery pack is not in use, keep it away from other metal objects, like paper clips, coins, keys, nails, screws or other small metal objects, that can make a connection from one terminal to another.** Shorting the battery terminals together may cause burns or a fire.
4. **Under abusive conditions, liquid may be ejected from the battery; avoid contact. If contact accidentally occurs, flush with water. If liquid contacts eyes, additionally seek medical help.** Liquid ejected from the battery may cause irritation or burns.

5. **Do not use a battery pack or tool that is damaged or modified.** Damaged or modified batteries may exhibit unpredictable behaviour resulting in fire, explosion or risk of injury.
6. **Do not expose a battery pack or tool to fire or excessive temperature.** Exposure to fire or temperature above 130 °C (or 265°F) may cause explosion.
7. **Follow all charging instructions and do not charge the battery pack or tool outside the temperature range specified in the instructions.** Charging improperly or at temperatures outside the specified range may damage the battery and increase the risk of fire.

2.2.6. SERVICING

1. **Have your power tool serviced by a qualified repair person using only identical replacement parts.** This will ensure that the safety of the power tool is maintained.
2. **Never service damaged battery packs.** Service of battery packs should only be performed by the manufacturer or authorized service providers.

2.2.7. MANAGEMENT OF THE RECYCLING AND RECOVERY OF WASTE FROM YOUR TOOL

1. **When the tool reaches the end of its life, PELLENC keeps the end of life sheet of the equipment at disposal.** The end of life sheet provides instructions for safely removing components.

2.3. SAFETY WARNING FOR THE HEDGE TRIMMER

1. **Keep all parts of the body away from the cutting blade. Do not clear away cut materials or hold elements when blades are moving.** The cutting blades continue to move after powering off. A moment of inattention while operating a hedge trimmer may result in serious personal injury.
2. **Carry the hedge trimmer by the handle with the cutter bar stopped and being careful not to press the On/Off switch.** Proper transportation of the hedge trimmer reduces the risk of inadvertent starting of the machine and bodily injuries from the blades.
3. **When transporting or storing the hedge trimmer, always install the blade protector sleeve.** Correct use of the hedge trimmer reduces the risk of bodily injury from the blades.
4. **When clearing jams or repairing the machine, make sure all power switches are off and the power cable is removed or disconnected.** Unintentional activation of the hedge trimmer when clearing jams or undertaking repairs can result in serious injury.
5. **Hold the hedge trimmer with both hands on the insulated gripping surfaces only, as the blade may come into contact with hidden electrical wires.** Blades that come in contact with an "active" wire may "electrify" the exposed metal parts of the hedge trimmer and expose the operator to electrical shock.
6. **Keep all power cords and cables away from the cutting area.** Power cords and cables may be hidden in hedges or bushes and can be accidentally cut by the blade.
7. **Do not use the hedge trimmer in adverse weather conditions, especially if there is a risk of lightning.** This decreases the risk of being struck by lightning.

2.4. SAFETY WARNINGS FOR THE POLE HEDGE-TRIMMER

1. **To reduce the risk of electric shock, never use the pole hedge-trimmer near power lines.** Contact with power lines or use near power lines can cause serious injury or electric shock resulting in death.
2. **Always use both hands when using the pole hedge-trimmer.** Hold the pole hedge-trimmer with both hands to prevent loss of control.
3. **Always wear protective headgear when using the pole hedge-trimmer overhead.** Falling debris can cause serious injury.

2.5. SAFETY SIGNAGE

California State Proposition 65:



Caution

This product contains or emits a chemical recognized by the State of California to cause cancer, birth defects or other reproductive harm.

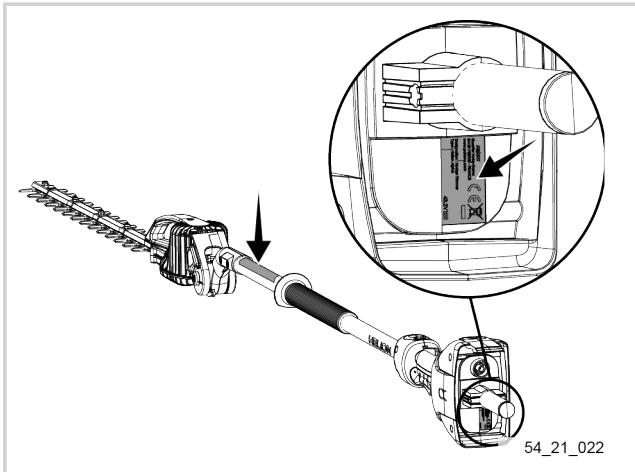

Sharp cutting tool: Keep your hands away from the hedge-trimmer blade.



Risk of burns



IP54 product protection rating (Protection against dust and water spray from all directions).



Labelling for North America only. Use the tool only with the battery models specified on the sticker.



Tool compliant with EC standards.



LWA sound powerlevel guaranteed



Tool compliant with Moroccan standards.



Please read the operating instructions.



Tool compliant with British standards



Safety goggles, hearing protection and a protective helmet must be worn.



Lithium-ion battery.

At the end of its life, the battery must be returned to the authorized distributor from whom it was purchased to be recycled in accordance with waste regulations.



Safety distance to be respected. Keep at least 10 metres back from the machine working area.

2.6. PERSONAL PROTECTION EQUIPMENT (PPE)

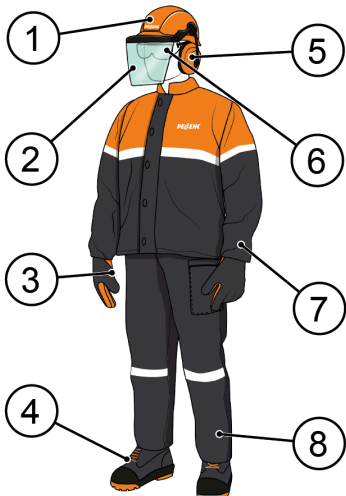

00_20_028

	Equipment	Wearing of
1	Safety helmet	Mandatory
2	Protective visor	Recommended
3	Protective gloves	Recommended
4	Safety footwear	Recommended
5	Ear protection	Mandatory
6	Protective goggles	Mandatory
7	Jacket or over-sleeves	Recommended
8	Work trousers	Recommended

3. DESCRIPTION AND TECHNICAL FEATURES

3.1. DESCRIPTION OF THE HEDGE-TRIMMER

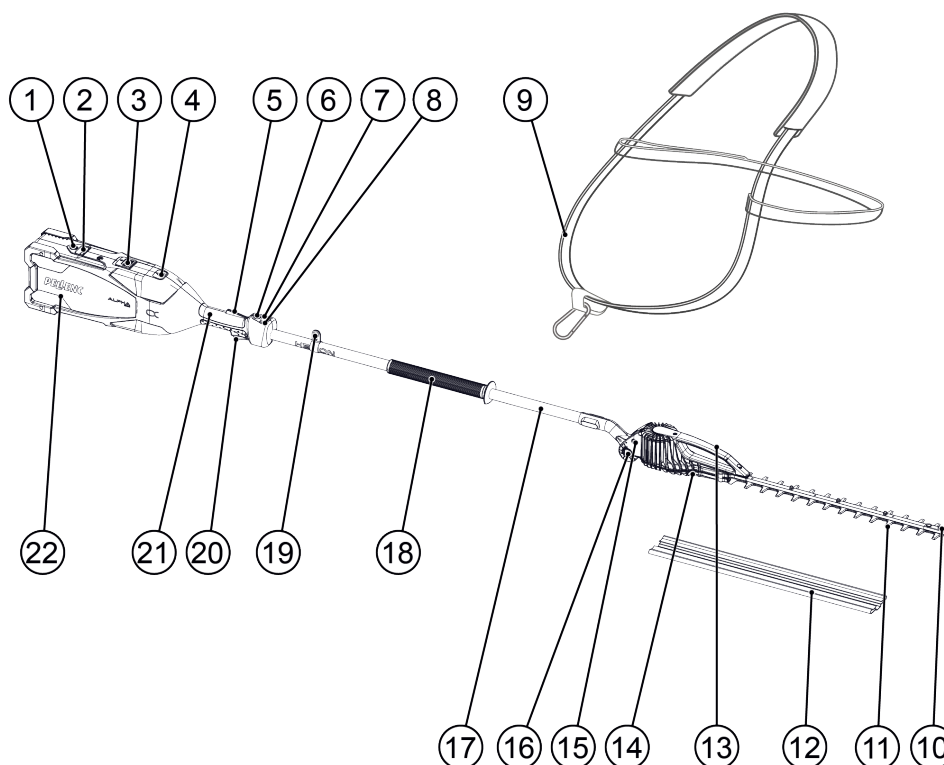

54_20_001

1. Battery On / Off button: turns the battery on or off.
2. Digital battery display: displays information related to the battery.
3. Battery safety lock
4. Battery locking clip
5. Safety throttle: prevents inadvertent actuation of the control trigger.
6. Tool handle On / Off button: turns the tool on or off, and selects the speed.
7. Tool handle digital display: displays information related to the battery and the tool (Charge rate, faults, etc.).
8. LEDs: display the selected speed.
9. Carrying strap
10. Anti-kickback guard: protects the blades from coming into contact fence posts, masonry, etc.
11. Hedge-trimmer blade.
12. Protective sleeve: protects the hedge-trimmer blade.
13. Upper handle
14. Screw: allows access for lubrication of the hedge-trimmer blade gear block
15. Pivot unlocking button: allows you to unlock the pivot lock of the hedge-trimmer blade.
16. Pivot axis: allows adjustment of the pivot stiffness of the hedge-trimmer blade.
17. Tube
18. Front handle
19. Carrying strap eyelet: allows attachment the carrying strap (not included with the tool).
20. Control trigger: allows the speed of the hedge-trimmer blade to be increased/decreased gradually.
21. Rear handle
22. Battery alpha 260 / alpha 520 (supplied separately)

3.2. TECHNICAL FEATURES

3.2.1. TOOL FEATURES

Model	Helion Alpha
Power	900 W
Power supply voltage	43.2 V
Weight (without battery)	3.75 kg
Dimensions (L x W x H) in mm	2181 x 93 x 153
Effective cutting length / Hedge-trimmer blade	510 mm
Space between teeth	33 mm
Teeth height	23 mm
Blade speed	3200 to 3800 cuts/min
Adjustable angle hedge-trimmer blade	- 180° (Transport) -90° / + 45°
Battery life	Depends on use and battery type

3.2.2. VIBRATION AND NOISE EMISSION VALUES

The determination of noise levels and vibration rates is based on operating conditions at maximum rated speed according to a standardised test method. It can be used to compare two machines.

Sound power values

Measured sound power level L_{WAm} (uncertainty K_{WAm} : 3 dB(A))	96 dB(A)
Guaranteed sound power level L_{WAg}	92 dB(A)

The measured sound level and the guaranteed sound power level were measured according to a procedure in accordance with Directive 2000/14 / EC Annex V.

Vibration values

Vibration values measured at maximum rated speed*	ah = 3.4 m/s ²
---	---------------------------

*Measurement uncertainty: $KWA = 1.5 \text{ m/s}^2$

The total declared values for vibration and noise emissions can be used for a preliminary exposure assessment.

Caution

Vibrations and noise emissions during actual use of the machine may differ from the total declared value, depending on how the machine is used

It is necessary to identify safety measures to protect the operator, based on an estimate of exposure under actual operating conditions (taking into account all parts of the operating cycle, such as the time the machine is switched off and the time it is idling, in addition to the working time).

4. COMMISSIONING

For information about mandatory PPE when handling your tool, refer to Section 2.6, "Personal Protection Equipment (PPE)".

The Hedge-trimmer Helion Alpha is delivered pre-assembled. Unfold the hedge-trimmer blade, charge and connect the battery, the tool is ready to use.

4.1. UNFOLDING THE HEDGE-TRIMMER BLADE

1. Press the hedge-trimmer blade pivot unlocking button.
2. Unfold the hedge-trimmer blade to the desired position/angle using the upper handle.
3. Release the hedge-trimmer blade pivot unlocking button.

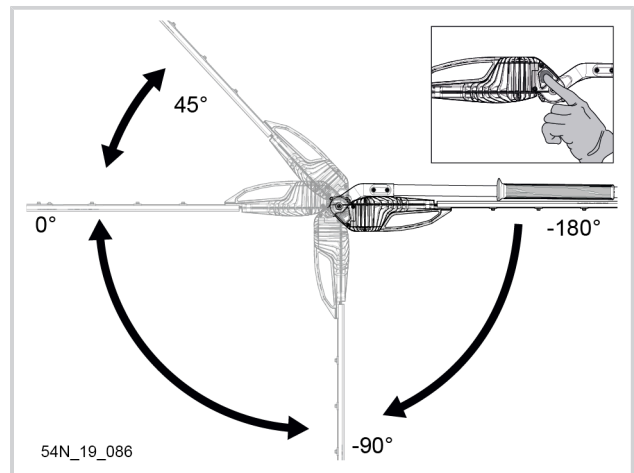

4.2. CONNECTING AND DISCONNECTING THE PELENC ALPHA 260 OR 520 BATTERY



Caution



Use only PELENC ALPHA 260 or PELENC ALPHA 520 batteries to power the tool.

4.2.1. BATTERY CONNECTION

1. Position the battery with the digital display of the battery facing up.
2. Push in the battery until the locking clip engages and the safety lock is closed.

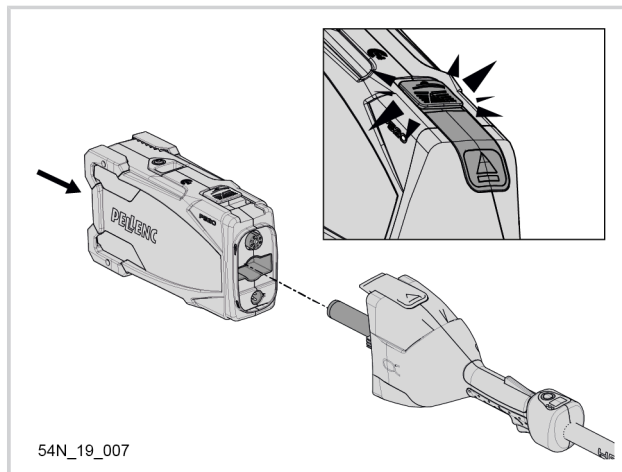
**4.2.2. DISCONNECTING THE BATTERY**

1. Pull the security lock to open it.
2. Press the locking clip while keeping the safety lock open.
3. Remove the battery.

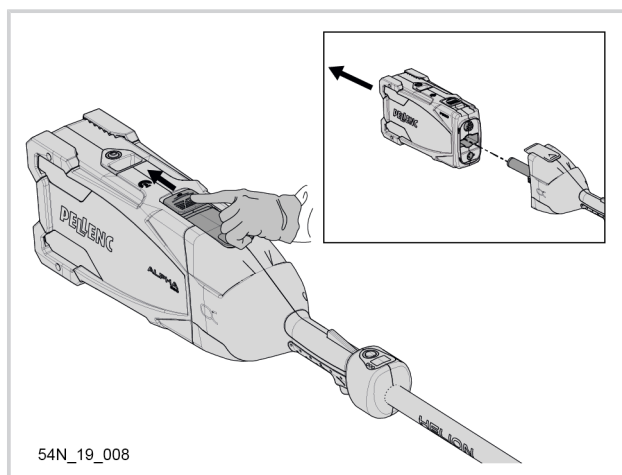

5. USE

5.1. PROTECTIVE SLEEVE

The protective sleeve protects both the hedge-trimmer blade and the user.

Important

Always disconnect the battery from the tool before removing or putting on the protective sleeve.

Remove the protective sleeve

- Before using the tool.

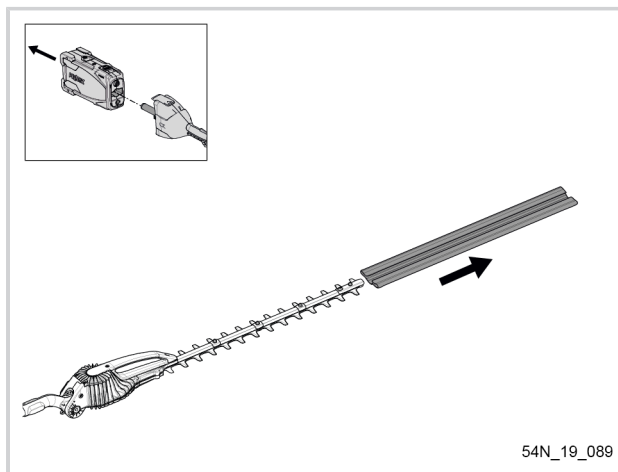

Fit the protective sleeve

- After using the tool.
- When adjusting the blades cutter bar angle.
- For storage.
- For transport.

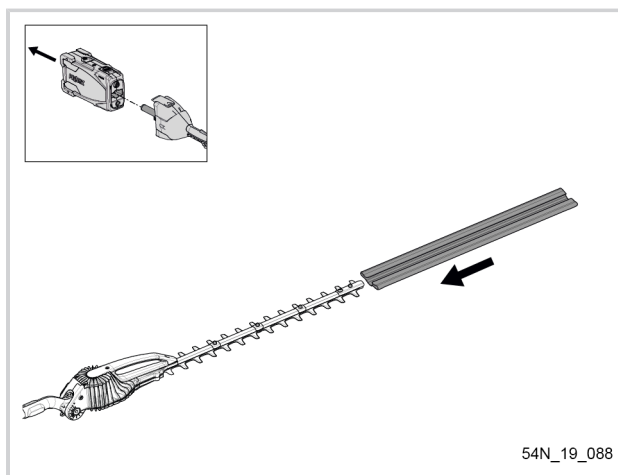

5.2. ADJUSTING THE HEDGE-TRIMMER BLADE ANGLE

5.2.1. HEDGE-TRIMMER BLADE WORKING POSITION

Adjust the angle of the hedge-trimmer blade according to the work to be done and to allow a comfortable working position.

1. Press the hedge-trimmer blade pivot unlocking button.
2. Adjust the hedge-trimmer blade to the correct angle for the work to be done using the upper handle.

The hedge-trimmer blade pivots in 15° increments.

The hedge-trimmer blade has an angle amplitude of -90° to 45°.

3. Release the hedge-trimmer blade pivot unlocking button.

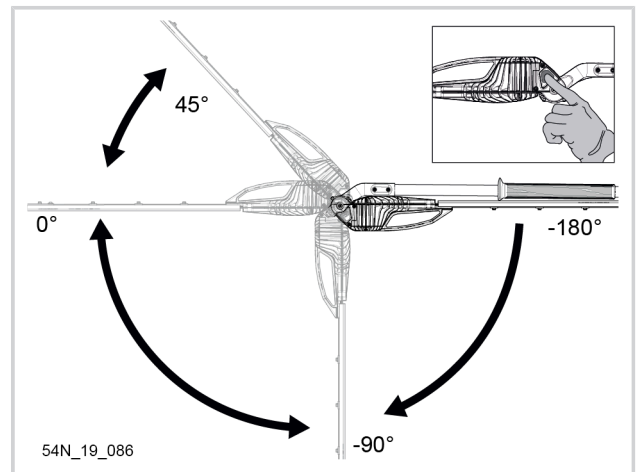

5.2.2. TRANSPORT POSITION / FOLDING THE HEDGE-TRIMMER BLADE

1. Press the hedge-trimmer blade pivot unlocking button.
2. Adjust the angle of the hedge-trimmer blade to 180° using the upper handle.
3. Release the hedge-trimmer blade pivot unlocking button.

* In the transport position, the tool is inactive (Message E8, see Section 7.2, “**Summary of display messages**”).

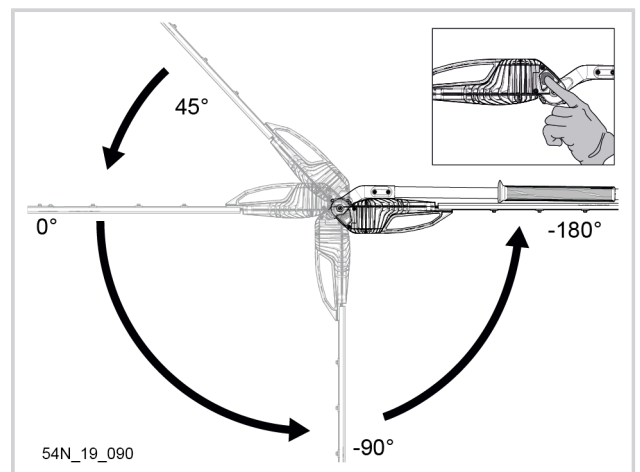

5.3. ADJUSTING THE WORKING POSITION

The working position must be adjusted according to the size of the operator.

It should allow easy use requiring little effort.

The user should not work with arms stretched or completely bent.

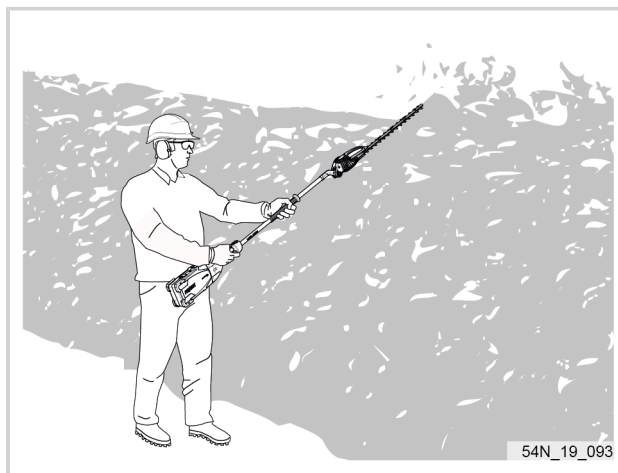

5.3.1. HOLDING THE TOOL

Hold the tool using the back and front handles.

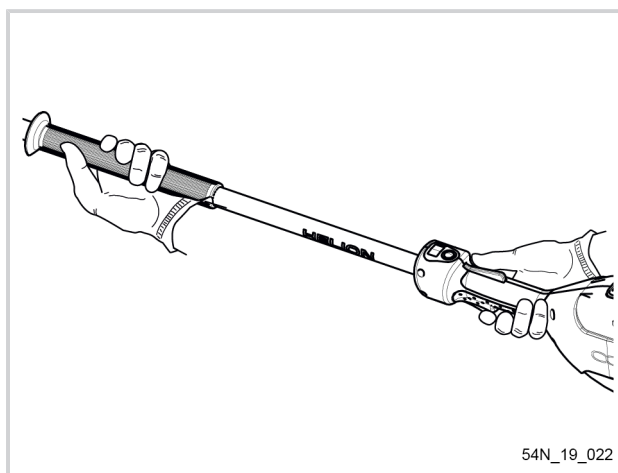

The tool is well balanced to reduce user effort.

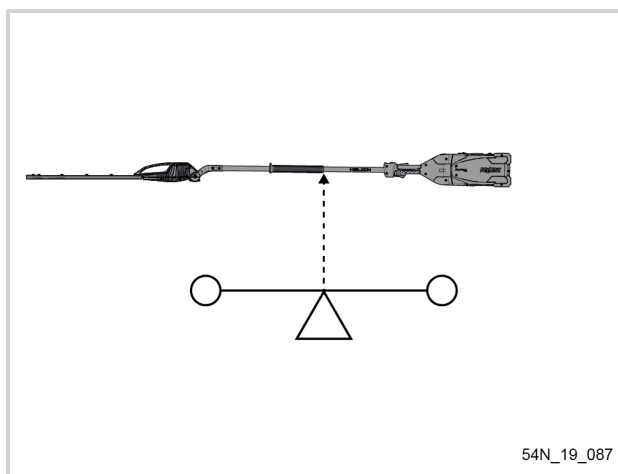

5.3.2. ADJUSTING THE CARRYING STRAP

1. Put on the carrying strap.
2. Adjust the length.



3. Pass the self-attaching fastener end of the strap under the main carrying strap.
4. Fold the self-attaching fastener over the main strap.



5. Mount the carrying eyelet on the tool pole.
6. Position the carrying eyelet so that the tool is balanced.
7. Fit and tighten the Torx screw.

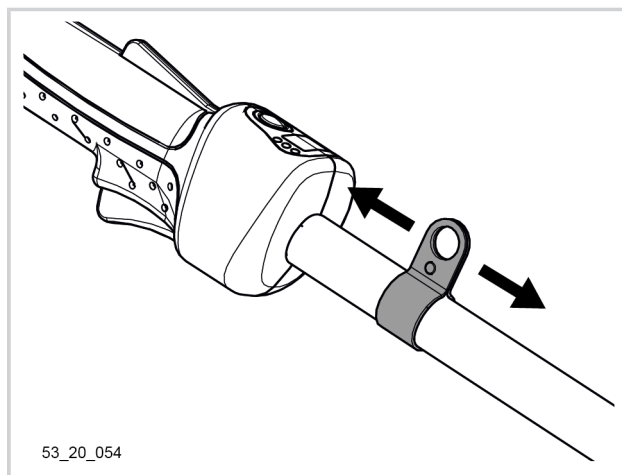

8. Hook the carrying strap on the tool carrying eyelet.

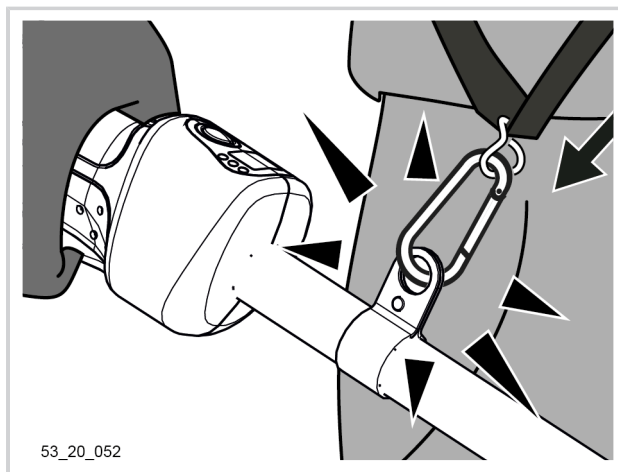

5.4. POWER ON OR OFF

5.4.1. POWER "ON"

Check that the charge level is displayed on the battery display:

The charge level is not displayed on the battery display:

- Press the battery On/Off button.
The battery should emit a beep.
Then the charge level is displayed on the battery display.

The charge level is displayed on the battery display:

Powering up can be done in 2 ways:

- Press the battery On/Off button.
The 3 "speed" LEDs should light up on the tool handle.
Then the charge level is displayed on the handle display.
The current speed LEDs light up.

or

- Press the On / Off button on the tool handle for 1 second.
The battery should emit a beep.
The 3 "speed" LEDs should light up on the tool handle.
Then the charge level is displayed on the handle display.
The current speed LEDs light up.

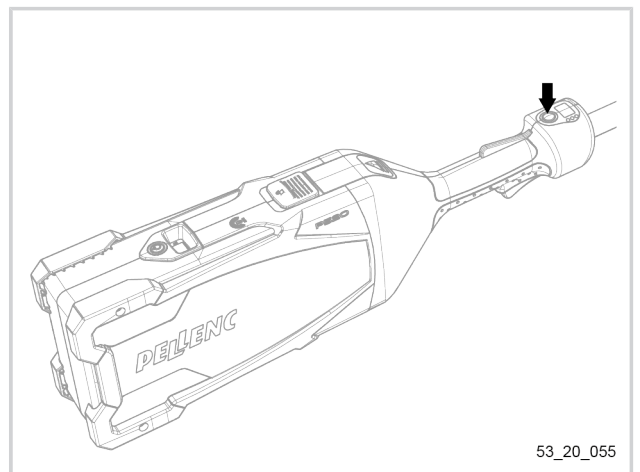
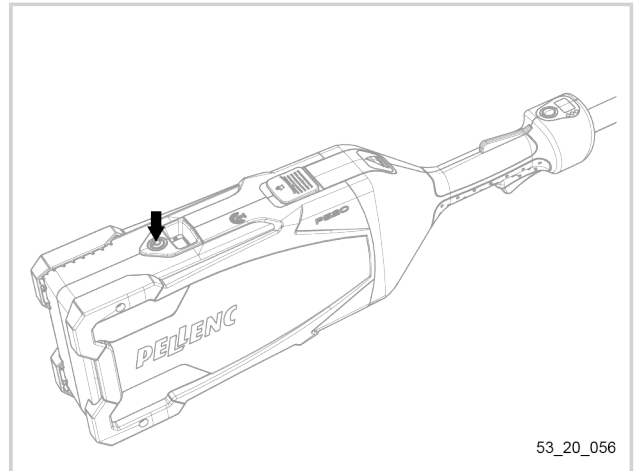

5.4.2. POWERING OFF

Powering off can be done in 2 ways:

- Press and hold the On / Off button on the tool handle for 3 seconds.
- "BY" is displayed on the handle display.

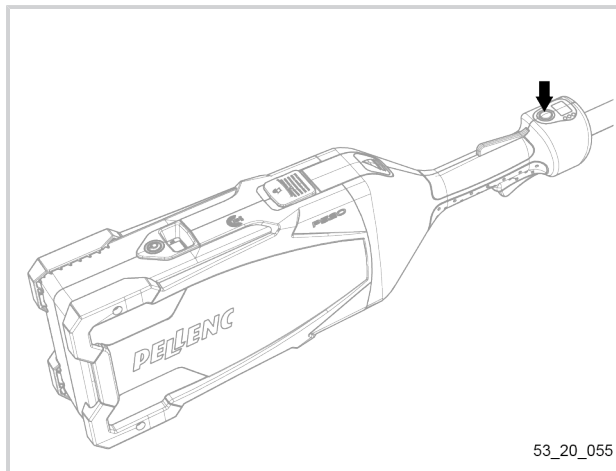

Or

- Press the On / Off button on the battery.
- "BY" is displayed on the tool handle display.

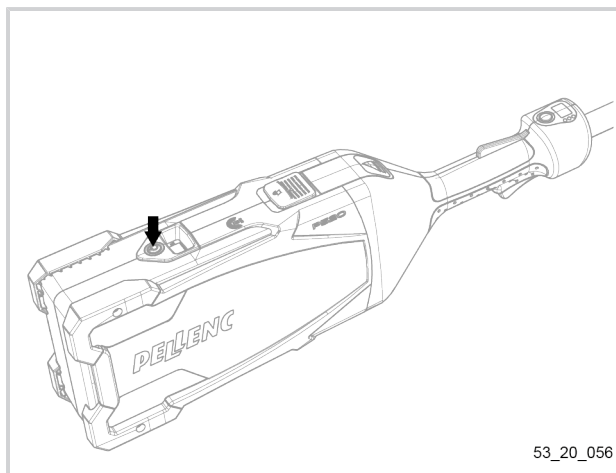

5.5. CUTTING SPEED ADJUSTMENT

5.5.1. CUTTING SPEED RECOMMENDATION

	Leaf size	Recommended blade cutting speed	Cutting speed cuts/minute
	Large	Speed 1	3200 cuts/min
	Medium	Speed 2	3500 cuts/min
	Small	Speed 3	3800 cuts/min

Note

Reduce the speed to the minimum for greater autonomy or when the flashing message "°C" appears on the display (thermal safety shutdown near).

The tool remembers the last used speed and it will be selected by default the next time the tool is switched on.

Important

Do not cut anything other than vegetation.

5.5.2. SPEED SELECTION

Low speed: speed 1

- Press once on the tool On / Off button.
- 1 LED lights up.

Medium speed = speed 2

- Press twice on the tool On / Off button.
- 2 LEDs light up.

High speed = speed 3

- Press three times on the tool On / Off button.
- 3 LEDs light up.

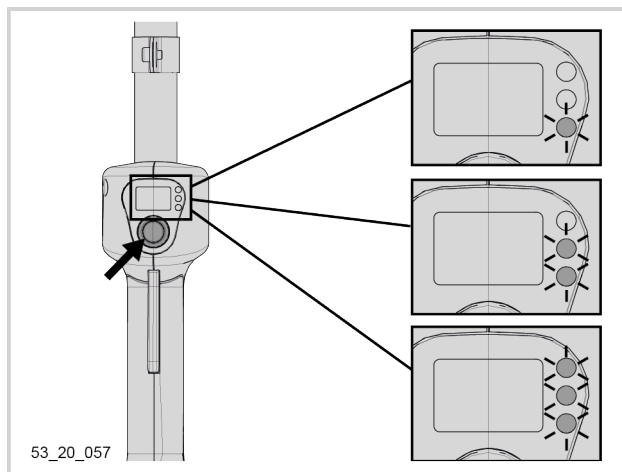

Caution

Flashing "°C" message on the handle display when the tool temperature approaches the safety shutdown temperature. Reduce the speed to a minimum or take a break.

5.6. START-UP



Caution

Check that the safety devices are running properly before starting work.

Before starting work, check that:

- The work area is clear.
- The tool protective sleeve is removed.
- The battery is properly connected.
- The battery charge level is displayed.
- The selected speed is correct.

1. Press the safety trigger.

Keep the safety trigger pressed.

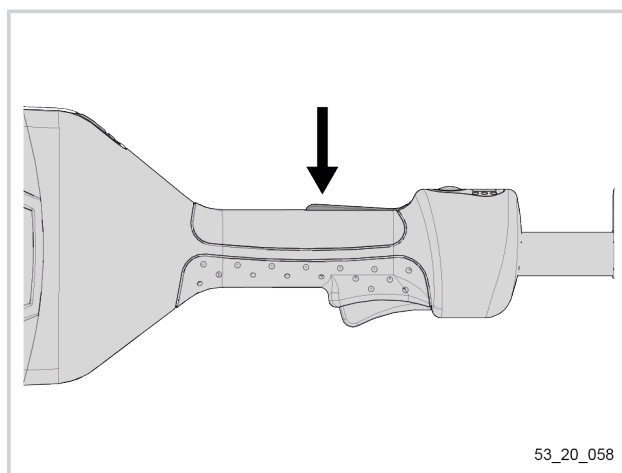

2. Press the control trigger twice to prime.

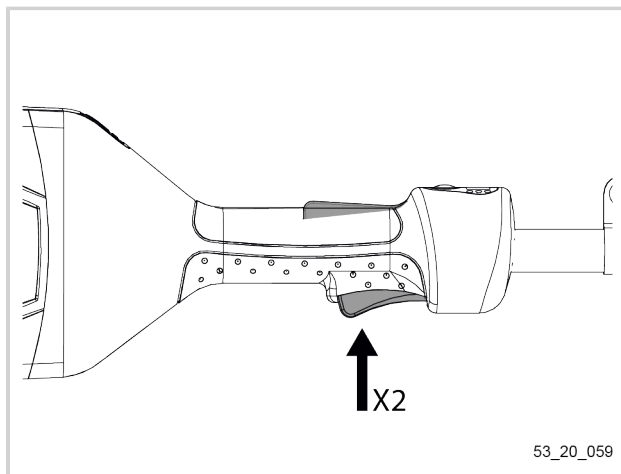

3. Keep the 2 triggers pressed for the tool to work.

Note

Repeat priming if you have released the control handle for more than 3 seconds.

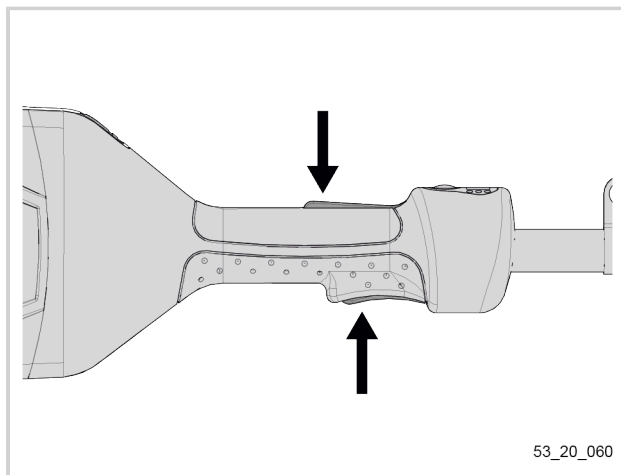

5.7. HEDGE TRIMMING TECHNIQUES

Important

Always start the motor before bringing the hedge-trimmer blade into contact with the plant foliage.

Do not cut anything other than vegetation.

- Tilt the hedge-trimmer blade at an angle between 0° and 10° to the vegetation.
- Advance the tool to the cutting plane for a cleaner cut.

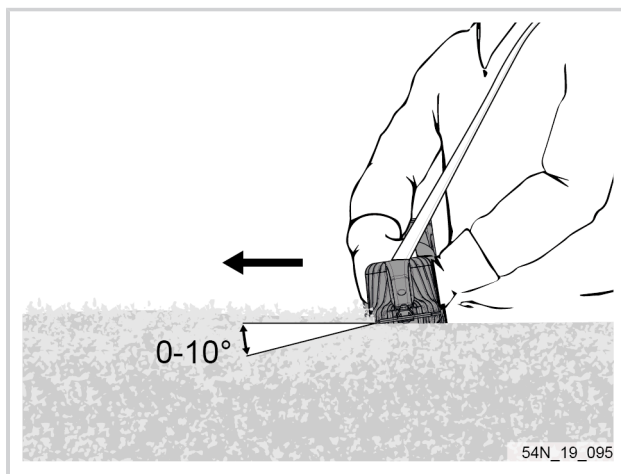

5.7.1. HORIZONTAL TRIMMING

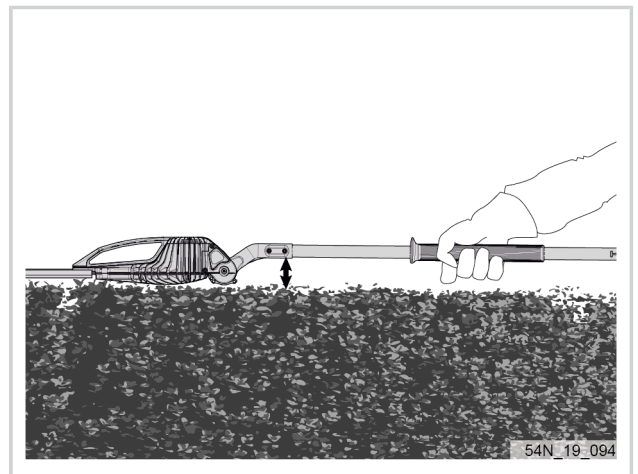
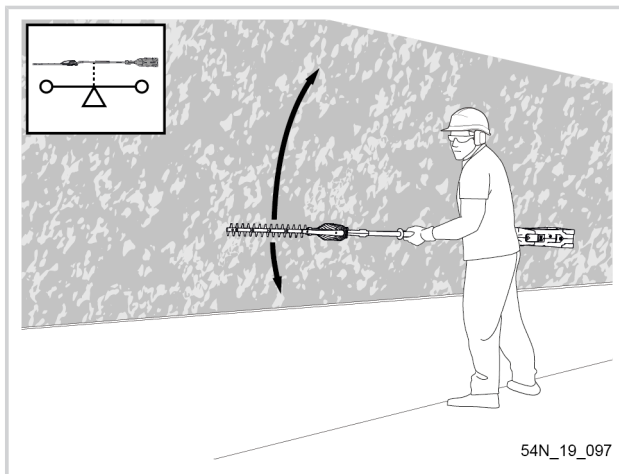

5.7.2. TRIMMING AT HEIGHT

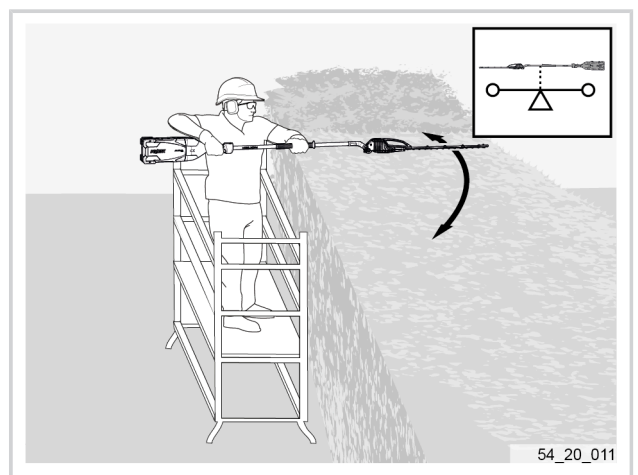
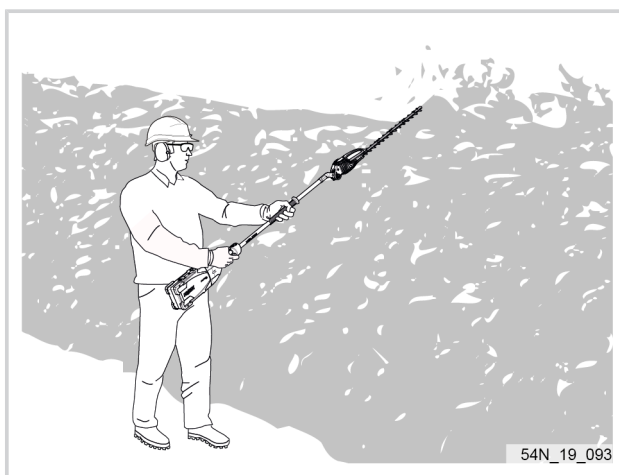

5.7.3. TRIMMING AT LOW LEVEL

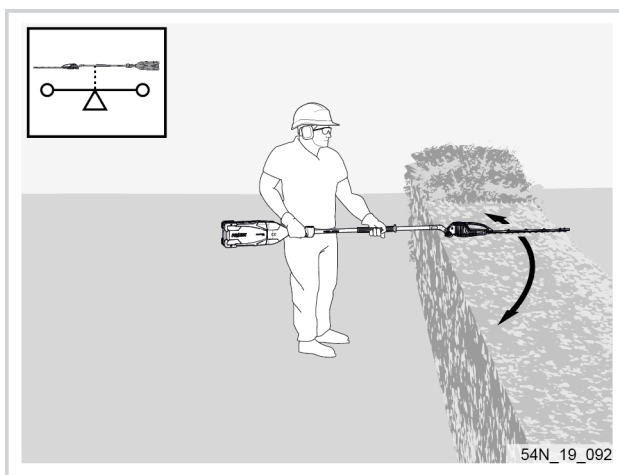

6. SERVICE

6.1. ANNUAL OVERHAUL

Important

Have your machine serviced every 200 hours or at least once a year by a PELENC authorised distributor.

These parts must be replaced as a precautionary measure or at least once a year:

Name	reference
Protective plate	71297
Hedge trimmer screws and fittings kit	120445
Anti-kickback guard	146494
Hedge-trimmer blade strip	117541

6.2. MAINTENANCE ADVICE



Caution

Always disconnect the tool battery before starting tool maintenance.

- Use products recommended by PELENC.
- In the event of any problem, consult an authorised PELENC distributor.

6.3. TOOL MAINTENANCE TABLE

Elements concerned	Operations	Frequency				Repairer	Notes
		Prior to each use	After each use	Every 50 hours	When necessary		
General appearance	Visual inspection	X	X			User	
	Cleaning		X			User	
Hedge trimmer blade	Cleaning		X			User	See Section 6.5, "Cleaning the blades"
	Lubrication	X	X			User	See Section 6.5, "Cleaning the blades"
	Screws and fittings	X				User	See Section 6.4, "Tightening blades"
	Ultra-quick				X	User	See Section 6.6, "Sharpening the blades"
	Adjustment				X	PELLENC authorised distributor	Check the height of the hedge-trimmer blade spacers.
Reducing gear	Lubrication			X		User	See Section 6.7, "Hedge-trimmer blade lubrication"
Handles / Triggers	Operation	X				User	See Section 5.6, "Start-up"
Hardware (excluding blade)	Tightening				X	User	
Battery	Please refer to the battery operating instructions						

6.4. TIGHTENING BLADES

1. Tighten the screw (1) to a torque of 3 N.m using a Torx screwdriver.

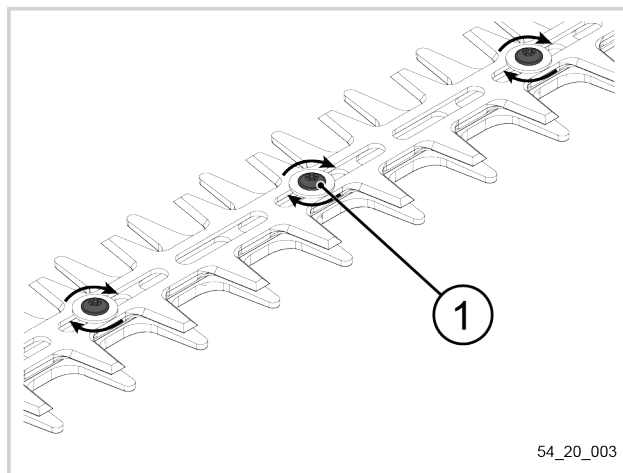

54_20_003

2. Tighten the lock nut (2) to a torque of 3 N.m with a torque wrench.

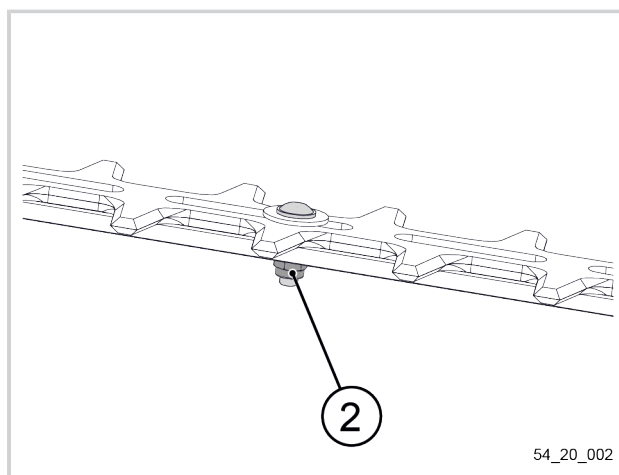

3. Check the position of the blades, using a set of spacing shims.

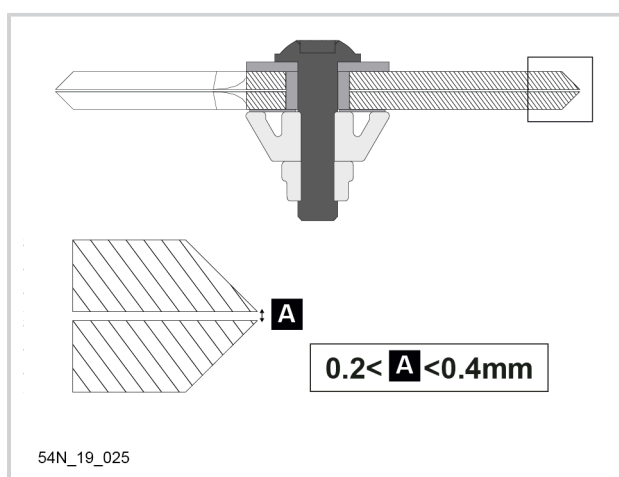

6.5. CLEANING THE BLADES

Important

Energy consumption varies depending on the state of cleanliness of the tool.

1. Clean the blades with a damp cloth.

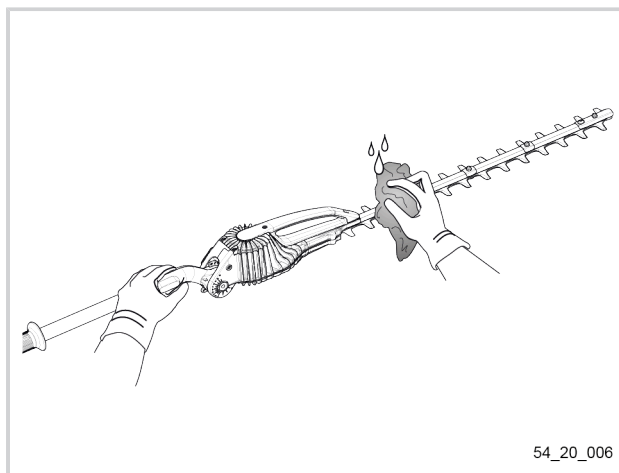

2. Check that there is no residue between the blades.

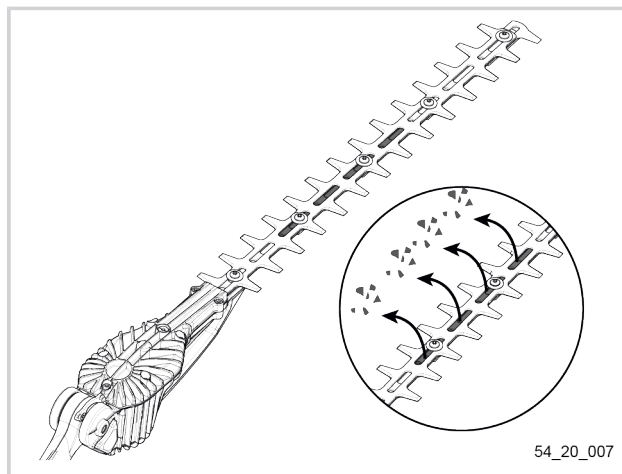

3. Clean and lubricate the blades with the cleaning / lubricating spray recommended by PELENC, see Section 9.3, "Consumables".

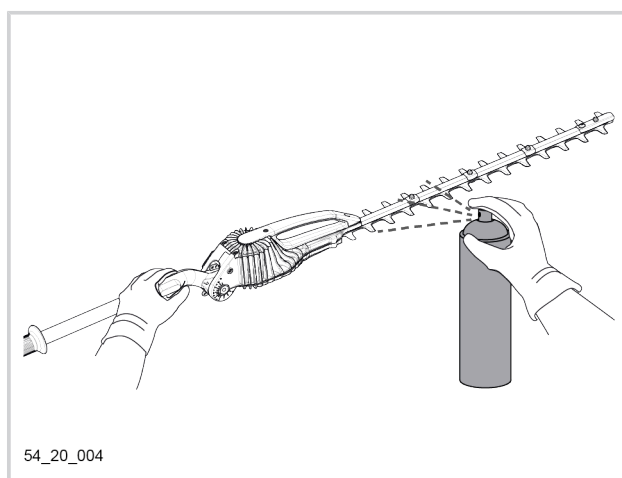

Warning

Ⓢ Never use solvents (trichloroethylene, white spirit, petrol, etc.) to clean the tool.

6.6. SHARPENING THE BLADES

Sharpen the blades regularly.

Regularly check how sharp the blades are during the first few hours of use to determine the optimum frequency of sharpening.

Ensure the blade is at a 45° angle during sharpening.

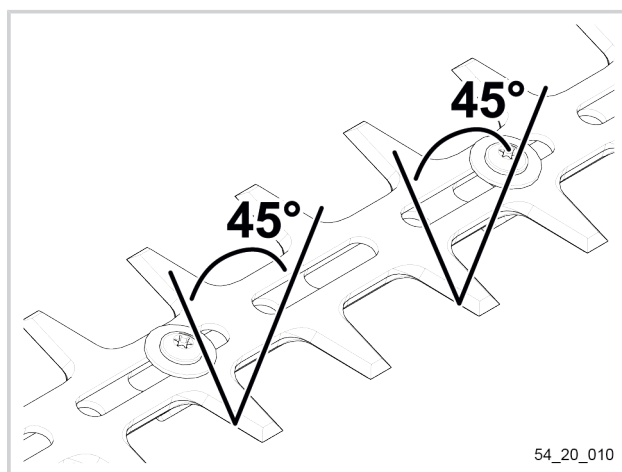

6.7. HEDGE-TRIMMER BLADE LUBRICATION

1. Loosen the screw which gives access to the lubrication area of the hedge-trimmer blade reducer using a T25 screwdriver.
2. Remove the screw.

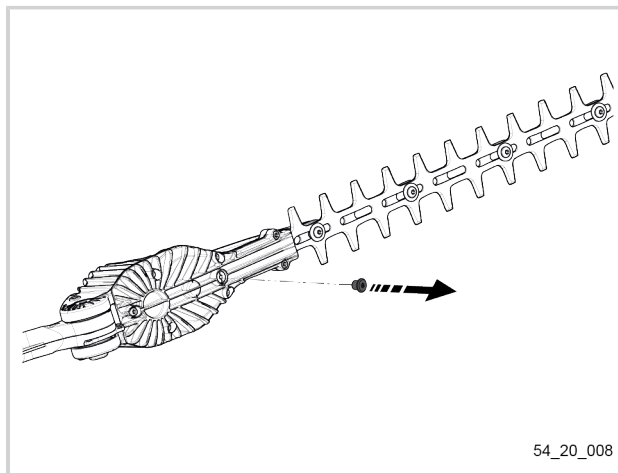

3. Grease the reducer with the grease gun (20g maximum grease) recommended by PELENC, see Section 9.3, "Consumables".

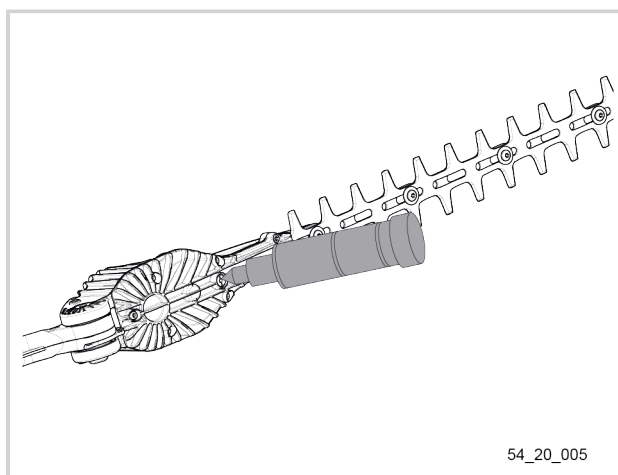

4. Refit the screw.
5. Tighten to a torque of 3 N.m using a T25 Torx screwdriver.

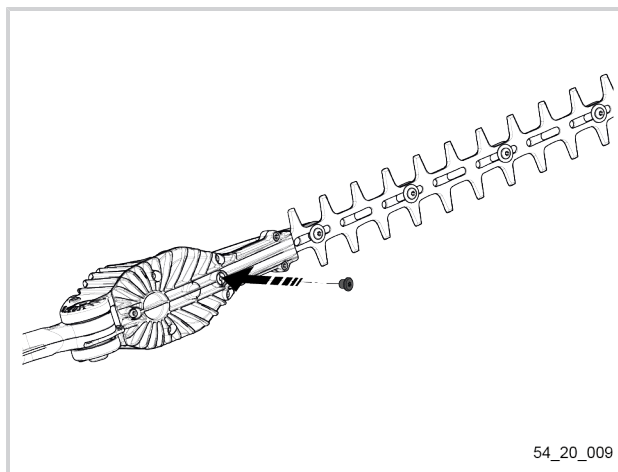

Note

The hedge-trimmer blade gears must be lubricated after the first 25 hours of operation and every 50 hours thereafter.

7. INCIDENTS AND TROUBLESHOOTING

7.1. TABLE OF INCIDENTS AND BREAKDOWNS - TROUBLESHOOTING

Incident / breakdown	LED status		Probable cause	Checks	Solutions	Repairer
	on/off button	of the tool handle				
The tool does not start	0	Off	Battery is off	Battery switch	Flip the battery switch	User
	I	Off	Communication problem with battery	Check that the battery is properly connected	Connect the battery correctly	User
			Battery	Check that the battery is not completely discharged	Recharge the battery	User
			Electronic circuit board	At an authorised PELLENC distributor	Change the electronic control board if the LEDs remain off after starting up and after checking of the previous point.	PELLENC authorised distributor
		On	Trigger no longer functions	At an authorised PELLENC distributor	Change the trigger or sensor	PELLENC authorised distributor
			Electronic circuit board	At an authorised PELLENC distributor	Change the circuit board	PELLENC authorised distributor
The hedge-trimmer blade makes an unusual noise	I	On	Blades are clogged	Check for residue between the blades	Clean the blades, see Section 6.5, "Cleaning the blades"	User
			Tighten hedge-trimmer blade screws	Tightening to 3 N.m max	Tightening to 3 N.m max	User
			Protective casing damaged	Check casing around screw studs	Change casing	Authorised PELLENC distributor
Display of "°C" flashing on the handle display	I	On	The tool is close to its temperature limit	Display of "°C" flashing on the handle display	Reduce speed of hedge-trimmer blade or take a break	User
The tool stops during use	I	Off	The tool has reached its temperature limit	4 beeps from the battery	Let the tool cool down for roughly 5 minutes	User
		Stop then restart the battery, and see "The tool does not start"				

7.2. SUMMARY OF DISPLAY MESSAGES

Note

When the battery is connected to the tool, the information is shown on the tool digital display, and is no longer displayed on the battery digital display.

Diagnostics display codes	Name
E1	Abnormal current
E2	Voltage too low
E3	Tool head problem
E4	Tool temperature too high
E5	Trigger problem

Info display codes	Name
E8	Hedge-trimmer blade in transport position (tool Off)
E9	Trigger pressed during powering on

Important

Ⓒ Never attempt to dismantle the tool, under penalty of cancellation of the warranty. Contact your authorised repair person.

8. STORAGE AND TRANSPORT

8.1. STORAGE

- Switch off the tool (see Section 5.4, “Power on or off”).
- Remove the battery, (see Section 4.2, “Connecting and disconnecting the Pellenc ALPHA 260 or 520 battery”).
- Store the battery (refer to the battery operating instructions).
- Clean the tool (see Section 6.5, “Cleaning the blades”).
- Store the tool in a dry place out of children's reach.
- Always store the tool with a greased blade.
- Always store the tool with a greased blade.
- Always store the tool with the protective sleeve on, see Section 5.1, “Protective sleeve”.
- Put the tool in the transport position, see Section 5.2.2, “Transport position / Folding the hedge-trimmer blade”.

8.2. TRANSPORT

- Switch off the tool (see Section 5.4, “Power on or off”).
- Disconnect the battery, see Section 4.2, “Connecting and disconnecting the Pellenc ALPHA 260 or 520 battery”.
- Put on the hedge-trimmer blade protective sleeve, see Section 5.1, “Protective sleeve”.
- Put the tool in the transport position, see Section 5.2.2, “Transport position / Folding the hedge-trimmer blade”.
- Ensure that the tool and the battery are secured in the transport vehicle.

9. ACCESSORIES AND CONSUMABLES

9.1. ACCESSORIES INCLUDED

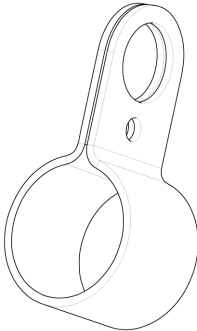
Name	Reference	
Carrying strap	133937	 54N_19_082
Carrying eyelet + bolt	134822	 54N_19_083

9.2. OPTIONAL ACCESSORIES

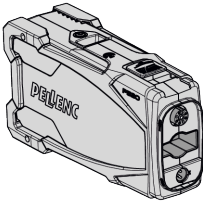
Name	Reference	
PELLENC ALPHA 260 battery	57192	 53_20_071
PELLENC ALPHA 520 battery	57193	

9.3. CONSUMABLES

Name	Reference
Grease gun	68518
PELLENC 400g Grease cartridge	115174
PELLENC lubricant and cleaning spray	121633

10. WARRANTIES

10.1. GENERAL WARRANTIES

10.1.1. STATUTORY WARRANTY

10.1.1.1. LATENT DEFECTS WARRANTY

Apart from the commercial warranty provided for under Article II, Article 1641 of the Civil Code provides that "the seller is bound to a warranty on account of latent defects of the object sold which render it unfit for the use for which it was intended, or which would impair said use to the extent that the buyer would not have acquired it, or would only have given a lesser price for it, had he known of them".

Article 1648 of the Civil Code "The action resulting from latent defects must be brought by the purchaser within two years after the discovery of the defect."

10.1.1.2. LEGAL WARRANTY OF CONFORMITY

Article L.217-4 of the French Consumer Code "The seller delivers goods in conformity with the contract and is liable for defects of conformity existing upon delivery".

The seller is also liable for any lack of compliance resulting from the packaging, assembly or installation instructions whenever its contractual liability is engaged in this regard or the latter are carried out under its responsibility.

Article L.217-5 of the French Consumer Code "Goods are compliant with the contract":

1. Where they are fit for the purpose normally expected of similar goods and, where applicable:
 - If it matches the description given by the seller and possesses the qualities that were presented to the purchaser in the form of a sample or model;
 - If it possesses the qualities that a purchaser can reasonably expect given the public statements made by the seller, the producer or its representative, especially in advertising or labelling;
2. Or, if it has the characteristics defined by mutual agreement of the parties or is fit for any particular purpose that the buyer made known to the seller and that the latter accepted.

Article L.217-12 of the Consumer Code "legal action resulting from lack of conformity lapses two years after delivery of the goods".

10.1.2. COMMERCIAL WARRANTY PELLENC

10.1.2.1. CONTENT

10.1.2.1.1. GENERAL INFORMATION

In addition to legal warranties, client users benefit from the commercial warranty on products PELLENC covering the exchange and replacement of parts recognised as being out of order, due to machining defects, assembly defects or material defects, whatever the cause.

The warranty is fully integral to the product sold by PELLENC.

10.1.2.1.2. SPARE PARTS

The commercial warranty also covers original PELLENC spare parts, excluding labour and to the exclusion of certain parts of each product provided at delivery.

10.1.2.2. DURATION OF THE WARRANTY**10.1.2.2.1. GENERAL INFORMATION**

PELLENC Products are guaranteed under the commercial warranty as from delivery to the customer for a period of two (2) years for products connected to a PELLENC battery, and for a period of one (1) year for other PELLENC products.

10.1.2.2.2. SPARE PARTS

PELLENC Replacement parts replaced under the product warranty are guaranteed under the commercial warranty as from delivery of the PELLENC product to the customer user for a period of two (2) years for products connected to a PELLENC battery, and for a period of one (1) year for other PELLENC products.

In the case of products connected to a PELLENC battery, parts that are replaced under the product warranty after the 12th month of use, are covered for a period of one (1) year.

10.1.2.2.3. WARRANTY EXCLUSIONS

Excluded from the commercial warranty are products that have been subject to abnormal use, or were used under conditions and for purposes other than those for which they were manufactured, especially in the case of non-compliance with conditions stipulated in this operating instructions manual.

It does not apply in case of shock, fall, neglect, lack of supervision or maintenance or in case of transformation of the product. Also excluded from the warranty are products that have been subject to tampering, alteration or modification by the customer user.

Wear parts and/or consumables cannot be covered by the warranty.

10.1.2.3. IMPLEMENTATION OF THE COMMERCIAL WARRANTY**10.1.2.3.1. PRODUCT COMMISSIONING AND COMMISSIONING DECLARATION**

No later than eight days after the delivery of the goods to the customer user, the DISTRIBUTOR shall complete the computerized declaration of commissioning form in order to activate the latter on the website www.pellenc.com, under the heading "extranet", menu "Pellenc Extranet Service", using the identifier previously issued by PELLENC.

Failing that, commissioning declaration will not be effective and implementation of the commercial warranty PELLENC will not occur. As a consequence thereof, the DISTRIBUTOR must ensure the financial burden of its intervention under the warranty without being able to pass on the cost to the client user.

The DISTRIBUTOR shall also undertake to complete the warranty card or the certificate of warranty and commissioning for self-propelled equipment provided with the product after having the client user sign and date it.

10.1.3. PAID AFTER-SALES SERVICE**10.1.3.1. GENERAL INFORMATION**

Malfunctions, breakdowns, breakages resulting from misuse, neglect or improper maintenance by the client user as well as malfunctions resulting from normal wear of the product are subject to the payment of after-sales service, even during the period of the legal and commercial warranty. After-sales service repairs that fall outside of the legal and commercial warranty also include maintenance, adjustments, diagnostics of all types, and cleaning without the present list being exhaustive.

10.1.3.2. WEAR PARTS AND CONSUMABLES

Wear parts and consumables also fall within the after-sales service.

10.1.3.3. SPARE PARTS

Paid after-sales service also covers original PELLENC spare parts, excluding labour and outside the legal and commercial warranty period.

In case of replacement of original PELLENC spare parts in the context of after-sales service, said latter are covered by a warranty of one year as from the installation date.

11. EC STATEMENT OF COMPLIANCE**11.1. "EC" DECLARATION OF CONFORMITY: HELION ALPHA**

MANUFACTURER/ENTITY AUTHORISED TO COMPILE THE TECHNICAL FILE	PELENC
ADDRESS	Quartier Notre-Dame - 84120 Pertuis (France)

We hereby declare that the machine referred to below as:

GENERIC DENOMINATION	HEDGE-TRIMMER		
FUNCTION	ELECTRIC BATTERY POWERED HEDGE-TRIMMER INTENDED FOR TRIMMING BUSHES / HEDGES		
COMMERCIAL NAME	HELION ALPHA		
TYPE	HELION ALPHA		
MODEL	HELION ALPHA		
SERIAL No.	54W00001 - 54W49999	54X00001 - 54X49999	54Y00001 - 54Y49999

Complies with the relevant provisions of the machinery directive 2006/42/EC.

Complies with the provisions of the following European directives:

- 2014/30/EU EMC Directive
- 2011/65/EU ROHS Directive
- 1907/2006 REACH Regulation
- 2012/19/EU WEEE Directive

The following harmonised European standards have been used in whole or in part:

- EN 62841-1: 2015; EN 62841-4-2: 2019 ; EN 60529 :1991 + A2: 2013 + AC: 2019; EN 55014-1: 2017; EN 55014-2: 2015

Sound power level:

- Measured sound power level L_{WAm} : 92 dB(A)
- Guaranteed sound power level L_{WAg} : 96 dB(A)

The measured sound level and the guaranteed sound power level were measured by the notified body SGS-CSTC Shanghai, 588 West Jindu Road, Xinqiao, Songjiang, 201612 Shanghai, China, according to a procedure compliant with Directive 2000/14/EC Annex V. The certificate are identified by the following numbers: SHES190902225371.

SIGNED IN PERTUIS, DATED
19/05/2022

JEAN-MARC GIALIS
CHIEF EXECUTIVE OFFICER



11.2. "UK" DECLARATION OF CONFORMITY: HELION ALPHA

MANUFACTURER / ENTITY AUTHORIZED TO COMPILE THE TECHNICAL FILE	PELENC
ADDRESS	Quartier Notre-Dame - 84120 Pertuis (France)

We hereby declare that the product referred to below as:

GENERIC DENOMINATION	HEDGE-TRIMMER		
FUNCTION	ELECTRIC BATTERY POWERED HEDGE-TRIMMER INTENDED FOR TRIMMING BUSHES / HEDGES		
COMMERCIAL NAME	HELION ALPHA		
TYPE	HELION ALPHA		
MODEL	HELION ALPHA		
SERIAL No.	54W00001 - 54W49999	54X00001 - 54X49999	54Y00001 - 54Y49999

Complies with the relevant provisions of the Supply of Machinery (Safety) Regulations 2008.

Complies with the provisions of the following European directives:

- Electromagnetic Compatibility Regulations 2016 ; The Restriction of the Use of Certain Hazardous Substances in Electrical and Electronic Equipment Regulations 2012 ; 1907/2006 REACH Regulations ; The Waste Electrical and Electronic Equipment Regulations 2013

The following harmonised European standards have been used in whole or in part:

- BS EN 62841-1 : 2015 ; BS EN 62841-4-2 : 2017 ; BS EN 60529:1992+A2:2013 ; BS EN 55014-1 : 2017 ; BS EN 55014-2 : 2015

Sound Power Level :

- Measured sound power level L_{WAm} : 92 dB (A)
- Guaranteed sound power level L_{WAq} : 96 dB (A)

The measured sound level and the guaranteed sound power level were measured by the body SGS-CSTC Shanghai, 588 West Jindu Road, Xinqiao, Songjiang, 201612 Shanghai, China according to a procedure compliant with Directive 2000/14 / EC Annex V. The report is identified by the following number : SHES190902225371.

SIGNED IN PERTUIS, DATED 19/05/2022

JEAN-MARC GIALIS

CEO



PELLENC

   www.pellenc.com

PELLENC
Quartier Notre Dame - 84120 Pertuis (France)