

ENG

Translated from the original operating instructions



ELECTRIC HEDGE TRIMMER HELION 3

Operating Instructions

54_161520-D
01/2024

READ THE USER OPERATING GUIDE CAREFULLY BEFORE USE



www.pellenc.com

PELLENC

TABLE OF CONTENTS

1. INTRODUCTION	5
2. SAFETY	6
2.1. INTENDED USES	6
2.2. GENERAL SAFETY INSTRUCTIONS FOR THE ELECTRICAL TOOL	6
2.2.1. WORK AREA SAFETY	6
2.2.2. ELECTRICAL SAFETY	6
2.2.3. PERSONAL SAFETY	7
2.2.4. USE AND CARE OF THE POWER TOOL	7
2.2.5. BATTERY TOOL USE AND CARE	7
2.2.6. MAINTENANCE	8
2.2.7. MANAGEMENT OF THE RECYCLING AND RECOVERY OF WASTE FROM YOUR TOOL	8
2.3. SAFETY WARNING FOR THE HEDGE TRIMMER	8
2.4. SAFETY SIGNS	9
2.5. PERSONAL PROTECTIVE EQUIPMENT	10
3. DESCRIPTION AND TECHNICAL FEATURES	10
3.1. DESCRIPTION OF THE TOOL	10
3.2. TECHNICAL FEATURES	11
3.2.1. TOOL FEATURES	11
3.2.2. CHARGERS AND BATTERIES COMPATIBILITY	11
3.2.3. COMPATIBLE BLADES	11
3.2.4. VIBRATION VALUES AND NOISE LEVELS	12
4. START-UP	12
4.1. PACKAGE CONTENTS	12
4.2. MOUNTING THE HANDLE	13
4.3. MOUNTING THE BLADE	13
4.4. POSITION OF THE HANDLE	14
4.5. FITTING THE BATTERY ON THE HARNESS	14
4.6. CONNECTING THE TOOL TO THE BATTERY	15
4.7. DISCONNECTING THE TOOL FROM THE BATTERY	15
5. USE	15
5.1. SWITCHING THE BATTERY ON AND OFF	15
5.2. STARTING THE TOOL	16
5.3. STOPPING THE TOOL	17
5.4. HEDGE-TRIMMING SPEED MANAGEMENT	17
5.5. TIPS FOR USING THE ADAPTABLE CUTTER BAR	18
5.6. WORKING TECHNIQUES	18
6. MAINTENANCE	19
6.1. FREQUENCY OF OPERATIONS	19

6.2. ANNUAL OVERHAUL	20
6.3. TIGHTENING BLADES	20
6.4. CLEANING THE BLADES	21
6.5. HEDGE-TRIMMER BLADE LUBRICATION	22
6.6. SHARPENING THE BLADES	23
7. INCIDENTS AND TROUBLESHOOTING	24
7.1. SYMPTOMS OF THE HELION 3ELECTRIC HEDGE TRIMMER	24
8. STORAGE AND TRANSPORT	25
8.1. STORAGE	25
8.1.1. PUTTING THE TOOL INTO STORAGE POSITION	25
8.2. STORAGE	26
8.3. TRANSPORT	26
9. ACCESSORIES AND CONSUMABLES	26
9.1. INCLUDED ACCESSORIES	26
9.2. INTRODUCTION TO CUTTER BARS	26
9.2.1. ACCESSORIES PROVIDED WITH EACH BLADE	27
9.3. OPTIONAL ACCESSORIES	27
9.4. CONSUMABLES	27
10. WARRANTIES	27
10.1. GENERAL WARRANTIES	27
10.1.1. STATUTORY WARRANTY	27
10.1.2. COMMERCIAL WARRANTY PELLENC	28
10.1.3. PAID AFTER-SALES SERVICE	29
11. COMPLIANCE STATEMENTS	30
11.1. DECLARATION  OF CONFORMITY: HELION 3	30

1. INTRODUCTION

Dear Customer,

Thank you for purchasing your Electric hedge trimmer Helion 3. Properly used and maintained, this equipment will give you years of satisfaction.



Warning

In accordance with product liability laws, we are not responsible for damage caused by our product if the product includes an accessory that is not from the manufacturer or is not approved by the manufacturer. The use of any other accessory may increase the risk of injury.



Warning

Your device contains numerous recoverable or recyclable materials. Return it to your dealer or, failing this, to an approved servicing centre to be treated.



Comply with the regulations in force in your country as concerns environmental protection associated with your activity.



Warning

It is imperative that you read through the ENTIRE user's manual guide before using or servicing the tool. Always comply with the instructions and illustrations in the manual.

All through this user guide you will find advisory notes and information entitled: NOTE, IMPORTANT, ATTENTION and WARNING.

Points marked "NOTE" indicate additional information.

Points marked "IMPORTANT" warn the user of a potential risk for the equipment.

Points marked "CAUTION" warn the user of a potentially hazardous situation which if not avoided may result in minor injuries.

Points marked "WARNING" warn the user of a potentially hazardous situation which if not avoided may result in serious injury or death.

Warning  indicates the guarantee will not cover any damage resulting from failure to comply with the procedures and instructions, for which the owner will incur the repair costs.

Safety signs on the picker also indicate the safety precautions to be observed. Locate these signs and read them before using your machine. Any partially illegible or damaged sign should be replaced immediately.

Refer to 2.4. Safety signs, page 9 for the location diagram of the safety stickers affixed to the tool.

No part of this manual may be reproduced without the written permission of the company PELLENC. The illustrations provided in this manual are for information purposes only and are in no way contractual. The company PELLENC reserves the right to make any modification or improvement to its products as deemed necessary without informing customers already in possession of a similar model. This manual forms an integral part of the tool and must accompany the tool if it changes hands.

2. SAFETY

2.1. INTENDED USES

- The Electric hedge trimmer Helion 3 is a professional tool designed exclusively for trimming vegetation.
- The Electric hedge trimmer Helion 3 is intended to be used by the operator at ground level and not while standing on ladders or unstable supports.
- Any other use of this tool is not intended.
- The company PELLENC accepts no responsibility for any damage caused by improper or unspecified use different from its original intention.
- The user is responsible for any accident resulting from improper use or unauthorized modification of this tool.
- The company PELLENC accepts no responsibility for any damage caused by the use of non-original parts or accessories.

2.2. GENERAL SAFETY INSTRUCTIONS FOR THE ELECTRICAL TOOL



Warning

Read all safety warnings, instructions, illustrations and specifications provided with this power tool. Failure to follow the warnings and instructions may result in electric shock, fire and/or serious injury.

Note

Retain all the safety measures and instructions for later reading.

The term "power tool" in the safety warnings refers to your battery-powered electric tool (without power cord).

2.2.1. WORK AREA SAFETY

1. **Keep the work area clean and well lit.** Cluttered or dark areas invite accidents.
2. **Do not operate power tools in an explosive atmosphere, for example in the presence of flammable liquids, gases, or dust.** Power tools create sparks, which can ignite dust or fumes.
3. **Keep children and bystanders away while operating the power tool.** Distractions can cause you to lose control of the tool.

2.2.2. ELECTRICAL SAFETY

1. **The plugs of the electric tool must be adapted to the base. Never modify the plug in any way. Do not use adapter plugs with earthed (grounded) power tools.** Unmodified plugs and suitable sockets reduce the risk of electric shock.
2. **Avoid contact with earthed surfaces such as pipes, radiators, cookers, and refrigerators.** There is an increased risk of electric shock if your body is in direct contact with the ground.
3. **Do not expose power tools to rain or damp conditions.** Water entering a power tool will increase the risk of electric shock (Except for tools for which an "IP" index is specified).
4. **Do not abuse the cord. Never use the cord for carrying, pulling or unplugging the power tool. Keep cord away from heat, oil, sharp edges, and moving parts.** Damaged or entangled cords increase the risk of electric shock.
5. **Use an extension cord suitable for outdoor use when operating power tools outdoors.** Use a cord suitable for outdoors to reduce the risk of electric shock.

6. **If operating a power tool in a damp location is unavoidable, use a residual current device (RCD) protected supply.** Use of an RCD reduces the risk of electric shock.

2.2.3. PERSONAL SAFETY

1. **Stay alert, watch what you are doing, and use common sense when operating the power tool. Do not use a power tool when you are tired or under the influence of drugs, alcohol, or medication.** A moment of inattention when using a power tool can result in serious personal injury.
2. **Use personal protective equipment. Always wear eye protection.** Protective equipment such as dust mask, non-skid safety shoes, hard hat, or hearing protection used for appropriate conditions will reduce personal injuries.
3. **Prevent unintentional starting. Make sure the switch is in the off position before you connect the tool to the power source and/or battery pack, pick it up, or carry it.** Carrying power tools with your finger on the switch or plugging in power tools with the switch in the on position can cause accidents.
4. **Remove any adjusting wrench before switching the electric tool on.** A wrench or a key left attached to a rotating part of the power tool may result in personal injury.
5. **Do not overreach. Keep proper footing and balance at all times.** This provides better control of the power tool in unexpected situations.
6. **Wear appropriate clothing. Do not wear loose clothing or jewelry. Keep your hair and clothing away from moving parts.** Loose clothes, jewellery or long hair can get caught in moving parts.
7. **If devices are provided for connecting dust extraction and collection equipment, ensure that these are connected and properly used.** Use dust collectors to reduce the risk caused by dust.
8. **Do not let familiarity gained from frequent use of tools allow you to become complacent and ignore tool safety principles.** A moment of inattention can result in serious personal injury.

2.2.4. USE AND CARE OF THE POWER TOOL

1. **Do not force the power tool. Use the correct power tool for your application.** The adapted power tool does the work better and more safely at the speed it was built to operate at.
2. **Do not use the power tool if the switch does not turn it on and off.** Power tools that cannot be controlled by a switch are dangerous and must be repaired.
3. **Unplug the tool from the socket or remove the battery (if possible) before any adjustment, change of accessory or storage.** These preventive safety measures reduce the risk of accidentally starting the power tool.
4. **When not in use, keep power tools out of the reach of children and do not allow persons unfamiliar with the power tool or these instructions to operate it.** Power tools are dangerous when operated by inexperienced users.
5. **Complying with the maintenance of the power tool and its accessories is mandatory. Check for misalignment or binding of moving parts, breakage of parts and any other condition that may affect the power tool's operation. If damaged, have the power tool repaired before use.** Many accidents are due to poorly maintained power tools.
6. **Keep the cutting elements sharp and clean.** Properly maintained cutting tools with sharp cutting elements are less likely to jam and are easier to control.
7. **Use the power tool, accessories, blades, etc. in accordance with these instructions, taking into account the working conditions and the work to be done.** Using the power tool for operations other than those specified can result in hazardous situations.
8. **Handles and gripping surfaces must be kept dry, clean and free from oils and grease.** Slippery handles and grasping surfaces do not allow for safe handling and control of the tool in unexpected situations.

2.2.5. BATTERY TOOL USE AND CARE

1. **Recharge only with the charger specified by the manufacturer.** A charger that is suitable for a specific battery pack may create a fire hazard when used with another type of battery pack.
2. **Use power tools only with specifically designated battery packs.** Use of any other battery pack may create a risk of injury and fire.
3. **When battery pack is not in use, keep it away from other metal objects, like paper clips, coins, keys, nails, screws or other small metal objects, that can make a connection from one terminal to another.** A short-circuit between the battery terminals may cause burns or fire.

4. **Under abusive conditions, liquid may be ejected from the battery; avoid contact. If contact accidentally occurs, wash away with water. If liquid contacts eyes, additionally seek medical help.** Liquid ejected from the battery may cause irritation or burns.
5. **Do not use a battery pack or tool that is damaged or modified.** Damaged or modified batteries may exhibit unpredictable behaviour resulting in fire, explosion or risk of injury.
6. **Do not expose a battery pack or tool to fire or excessive temperature.** Exposure to fire or temperature above 130°C (or 265°F) may cause explosion.
7. **Follow all charging instructions and do not charge the battery pack or tool outside the temperature range specified in the instructions.** Charging improperly or at temperatures outside the specified range may damage the battery and increase the risk of fire.

2.2.6. MAINTENANCE

1. **Have the power tool serviced by a qualified technician, using only identical spare parts.** This will ensure that the safety of the power tool is maintained.
2. **Never service damaged battery packs.** Service of battery packs should only be performed by the manufacturer or authorized service providers.

2.2.7. MANAGEMENT OF THE RECYCLING AND RECOVERY OF WASTE FROM YOUR TOOL

1. **When the tool reaches the end of its life, PELLENC keeps the end of life sheet of the equipment at disposal.** The end-of-life sheet provides instructions for safely removing components.

2.3. SAFETY WARNING FOR THE HEDGE TRIMMER

1. **Keep all parts of the body away from the cutting blade. Do not clear away cut materials or hold elements when blades are moving.** The cutting blades continue to move after powering off. A moment of inattention while operating a hedge trimmer may result in serious personal injury.
2. **Carry the hedge-trimmer by the handle with the cutter bar stopped and being careful not to press the On/Off switch.** Proper transportation of the hedge trimmer reduces the risk of inadvertent starting of the machine and bodily injuries from the blades.
3. **When transporting or storing the hedge-trimmer, always install the blade protector sheath.** Correct use of the hedge-trimmer reduces the risk of bodily injury from the blades.
4. **When clearing jams or repairing the machine, make sure all power switches are off and the power cable is removed or disconnected.** Unintentional activation of the hedge-trimmer when clearing jams or undertaking repairs can result in serious injury.
5. **Hold the hedge trimmer with both hands on the insulated gripping surfaces only, as the blade may come into contact with hidden electrical wires.** Blades that come in contact with an "active" wire may "electrify" the exposed metal parts of the hedge trimmer and expose the operator to electrical shock.
6. **Keep all power cords and cables away from the cutting area.** Power cords and cables may be hidden in hedges or bushes and can be accidentally cut by the blade.
7. **Do not use the hedge trimmer in adverse weather conditions, especially if there is a risk of lightning.** This decreases the risk of being struck by lightning.

2.4. SAFETY SIGNS

California State Proposition 65:



Caution

This product contains or emits a chemical recognized by the State of California to cause cancer, birth defects or other reproductive harm.

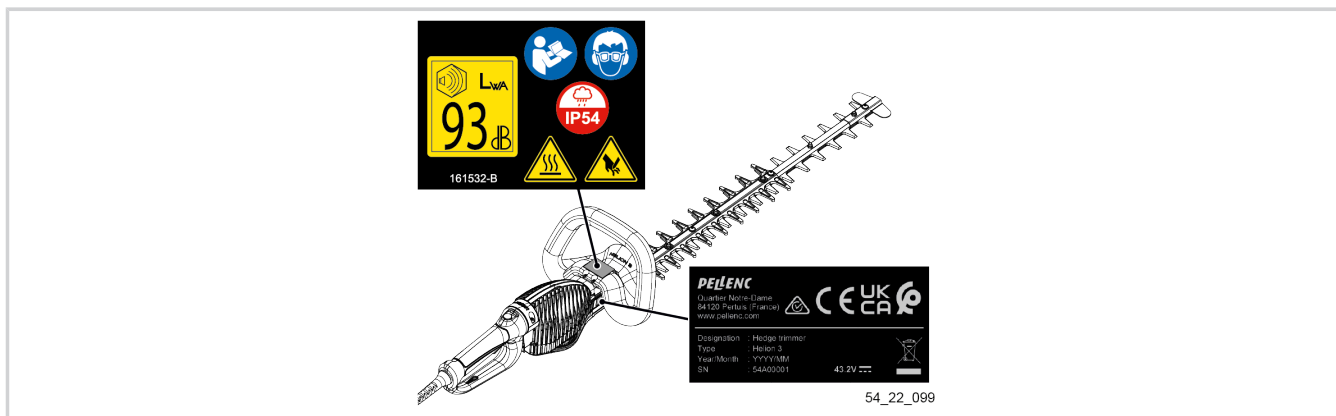

LWA sound power level guaranteed.



Please read the operating instructions.



Wearing glasses and hearing protection is required.



Protection rating IP54 (All-over protection against dust and water spray).



Risk of burns.



Sharp tools: Keep your hands away from the blade.



Regulatory Compliance Mark (RCM).

The product complies with the regulatory requirements of Australia and New Zealand for electrical safety, electromagnetic compatibility, radio frequency.



Tool compliant with EC standards.



Tool compliant with British standards



Tool compliant with Moroccan standards.



Waste electrical and electronic equipment.

At the end of its life, the tool and the battery must be returned to the authorized distributor from whom they were purchased to be recycled in accordance with waste regulations.

2.5. PERSONAL PROTECTIVE EQUIPMENT

A full-body diagram of a person wearing various personal protective equipment (PPE). Numbered callouts point to specific items: 1. Safety helmet, 2. Protective visor, 3. Hard-wearing gloves, 4. Robust, non-slip safety shoes, 5. Hearing protection (earplugs), 6. Protective glasses, 7. Safety jacket or over-sleeves, 8. Work trousers, 9. Shin pads. The person is wearing an orange and grey work jacket with 'ergotec' written on it, dark trousers, and orange knee pads. The diagram is labeled '00_20_054' at the bottom right.

	Equipment	Wearing of	Description
1	Safety helmet	Recommended	Mandatory if there is a risk of falling objects.
2	Protective visor	Recommended	Risk of projections.
3	Hard-wearing gloves	Recommended	Wear hand protection especially when working on the cutting tool.
4	Robust, non-slip safety shoes	Recommended	When operating the machine, always wear non-slip safety shoes. Do not operate the machine bare-foot or with sandals on.
5	Hearing protection	Mandatory	Wear approved ear protectors with sufficient noise attenuating effect. Prolonged exposure to noise can cause permanent hearing damage.
6	Protective glasses	Mandatory	Wear approved eye protection.
7	Safety jacket or over-sleeves	Recommended	Risk of projections.
8	Work trousers	Recommended	Always wear clothing that covers the operator's legs when the machine is in operation.
9	Shin pads	Optional	Risk of projections.

3. DESCRIPTION AND TECHNICAL FEATURES

3.1. DESCRIPTION OF THE TOOL

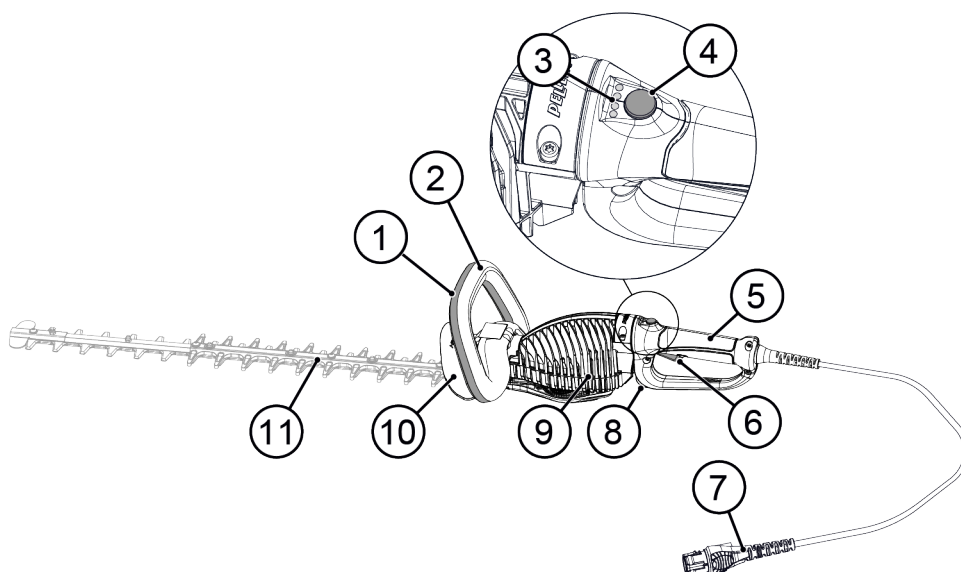

54_21_001

- | | |
|------------------------------------|---------------------------|
| 1. Front handle safety trigger | 7. Quick connector |
| 2. Front handle | 8. Handle rotation button |
| 3. Power "On" and speed indicators | 9. Crankcase |
| 4. Speed selector | 10. Hand guard |
| 5. Rear handle | 11. Blade (not included) |
| 6. Operating trigger | |

3.2. TECHNICAL FEATURES

3.2.1. TOOL FEATURES

	HELION 3		
Power	1200 W		
Tool voltage	43.2V		
Hedge trimmer blade	L51	L63	L75
Cutter blade weight	1,2 kg	1,3 kg	1,4 kg
Tool + cutter bar weight	3,4 kg	3,55 kg	3,7 kg
Dimensions (L x W x H) in mm	985x232x181	1105x232x181	1225x232x181
Effective cutting length / blade	510 mm	630 mm	750 mm
Space between teeth	33 mm		
Tooth height	23 mm		
Blade speed	3200 to 3800 cuts/min		
Battery life	Depending on the use and type of battery		
Protection rating	IP54		
Ambient operating temperatures	0°C - 35°C		
Ambient charging temperatures	10°C - 35°C		
Ambient storage temperatures	10°C - 35°C		

3.2.2. CHARGERS AND BATTERIES COMPATIBILITY

Battery	Charger	Remarques
ALPHA 260	CB5022 ; CB5022HV	*with adapter cord ref. 57248
ALPHA 520	CB5022 ; CB5022HV	*with adapter cord ref. 57248
ULIB 750	CB5022; CB5022HV	*with adapter cord ref. 57238

3.2.3. COMPATIBLE BLADES

Blade type	References
L51	56205
L63	56206
L75	56207

3.2.4. VIBRATION VALUES AND NOISE LEVELS

Noise and vibration levels are determined on the basis of operating conditions at maximum rated speed using a standardised test method. They can be used to compare two machines.

Sound pressure values

Maximum sound pressure level at the user's position (uncertainty K_{pA} : 1.5 dB (A))	$L_{pA} = 79$ dB (A)
Sound pressure level: peaks at the user position	$L_{pc} < 130$ dB (C)

Sound power values

Measured sound power level L_{WA} (uncertainty K_{WA} : 0.6 dB(A))	$L_{WAm} = 92$ dB
Guaranteed sound power level L_{WAg}	$L_{WAg} = 93$ dB

The measured sound power level and the guaranteed sound power level were measured on a hedge trimmer with a 750 mm long blade.

The measured noise level and the guaranteed noise level were measured according to a procedure in accordance with Directive 2000/14 / EC Annex V.

Vibration values

Vibratory emission values at the handle determined in accordance with EN 62841-4-2: 2009 (uncertainty of $K = 1.5$ m / s ²)	$a_h = 3.4$ m/s ²
---	------------------------------

The total declared values for vibrations and sound emissions may be used for a preliminary exposure assessment.

Caution

Vibrations during actual working use of the machine may differ from the total declared value, depending on the way the machine is used

It is necessary to identify safety measures to protect the operator, based on an estimate of exposure under actual operating conditions (taking into account all parts of the operating cycle, such as the time the machine is switched off and the time it is idling, in addition to the working time).

4. START-UP

4.1. PACKAGE CONTENTS

Check that the tool is delivered with:

- 1 hedge trimmer without blade (handle removed)
- 1 Torx wrench
- 5 M5x25 screws
- 1 Operating instructions manual
- 1 warranty notice

4.2. MOUNTING THE HANDLE

1. Take the tool out of its packaging.
2. Retrieve 2 M5x25 screws from the zip bag supplied with the tool.
3. Position the front handle on the tool.
4. Attach the handle with the two M5x25 screws.

Important

Tightening torque: 2.5 N.m.

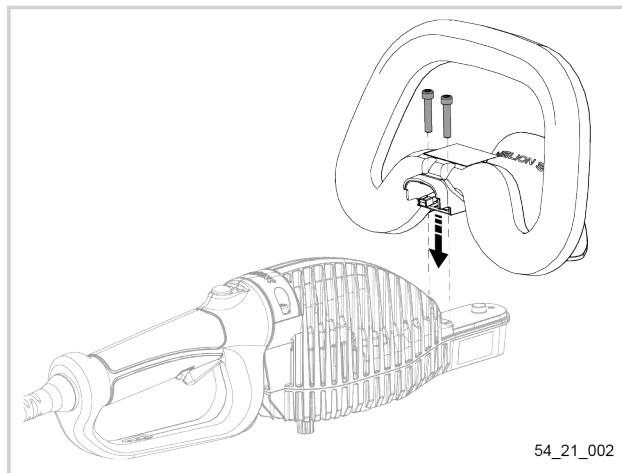

54_21_002

4.3. MOUNTING THE BLADE



Caution

Before working on the tool, check that the battery is switched off and then disconnect the power cord from the battery.

1. Retrieve three M5x25 screws from the zip bag supplied with the tool.
2. Locate the motor shaft over the safety casing and the reducer over the hedge trimmer blade.
3. Position the motor shaft halfway into the reducer.
4. If necessary, rotate the blade slightly to align it with the safety casing.

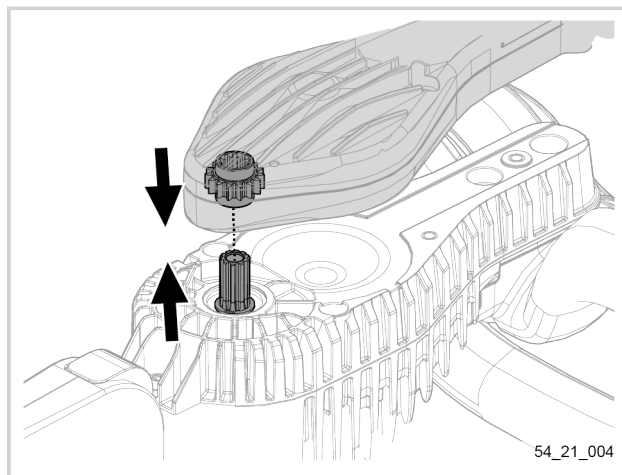

54_21_004

5. Attach the blade with the three M5x25 screws.

Important

Tightening torque: 4 N.m.

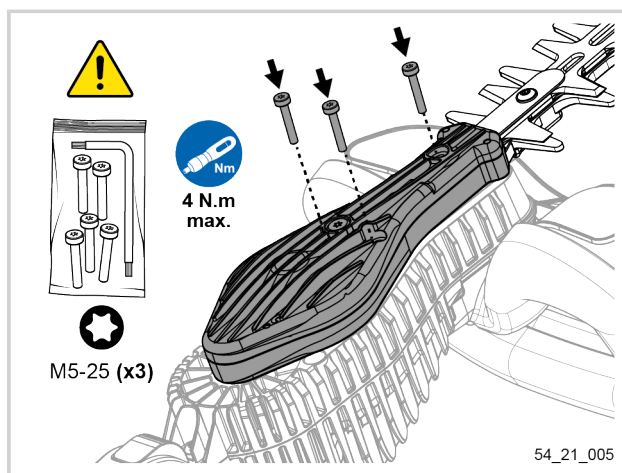

54_21_005



Caution

Ⓒ Only ever use blades supplied by PELLENC to avoid the risk of injury.



Warning

Ⓒ Running-in of the blade must be done for 1 minute at each change of the blade in a dry run. Check the tightness of the blade after running-in.

4.4. POSITION OF THE HANDLE

1. Press and hold the handle rotation button (9) to unlock the handle rotation.
2. Rotate the handle to the desired position and release the button.

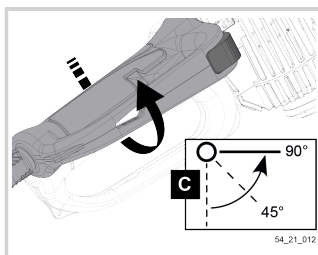
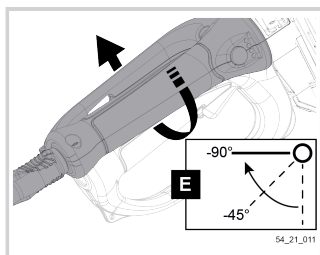

Note

The handle must be placed in one of the 5 lock positions in order to work.

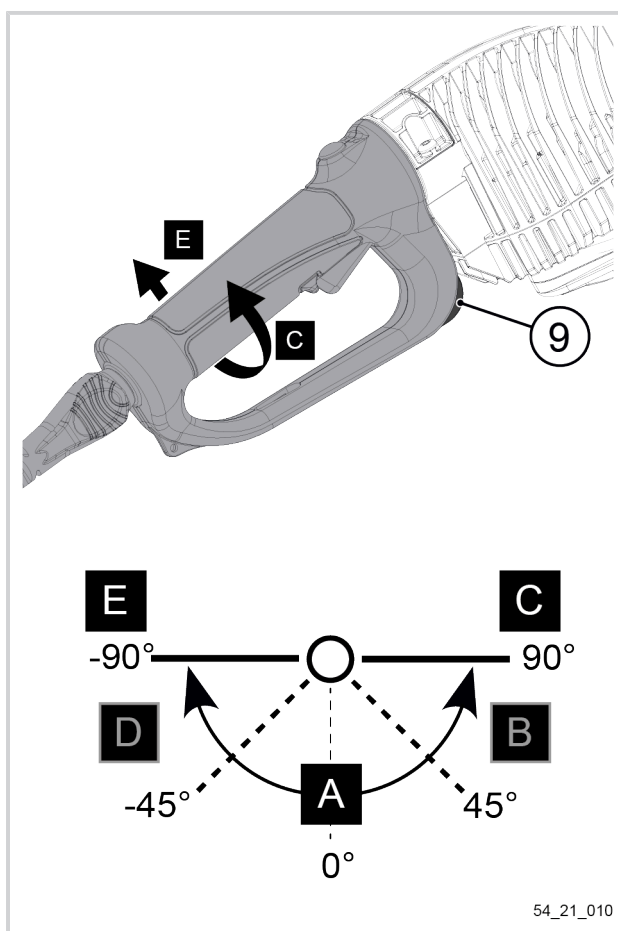

4.5. FITTING THE BATTERY ON THE HARNESS

To mount the battery on your harness, refer to the mounting instructions provided with your harness.

Important

After mounting, the battery must be solidly attached and secured on your harness. If this is not the case then the mounting needs to be checked.

4.6. CONNECTING THE TOOL TO THE BATTERY

Important

Always check the remaining battery-life before use. If necessary, recharge the battery using the charger.

To prolong the life of the connectors, they should be protected when unplugged. Avoid contact with abrasive or dirty surfaces, or subjecting them to heavy impacts (falls).

For more information on PELLEC batteries, please refer to the battery operating instructions.

1. Make sure that the battery is correctly fitted on the harness, see 4.5. Fitting the battery on the harness, page 14.
2. Make sure the battery is switched off, see 5.1. Switching the battery on and off, page 15.
3. Make sure the quick connector power cord is correctly connected to the battery.
4. Align the arrows on the tool power cord (2) and the quick connector (1).
5. Connect the tool power cord (2) to the quick connector (1).
6. Make sure that the quick connector (1) and the tool power cord (2) are correctly connected.

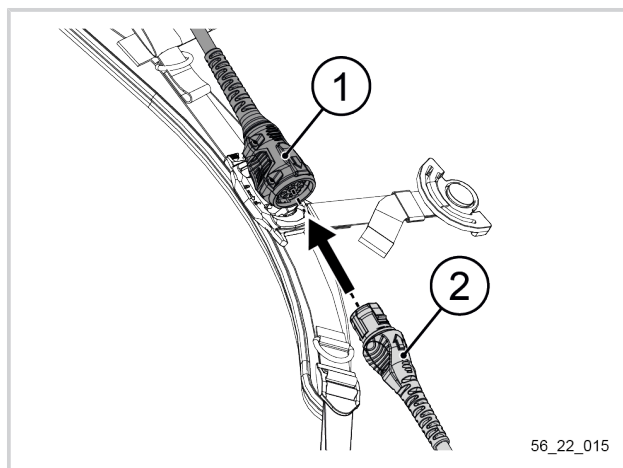

4.7. DISCONNECTING THE TOOL FROM THE BATTERY

1. Make sure the battery is switched off, see 5.1. Switching the battery on and off, page 15.
2. Disconnect the tool power cord (1) from the quick connector power cord (2).
3. To remove the battery from the harness, refer to the battery operating instructions and the harness mounting instructions.

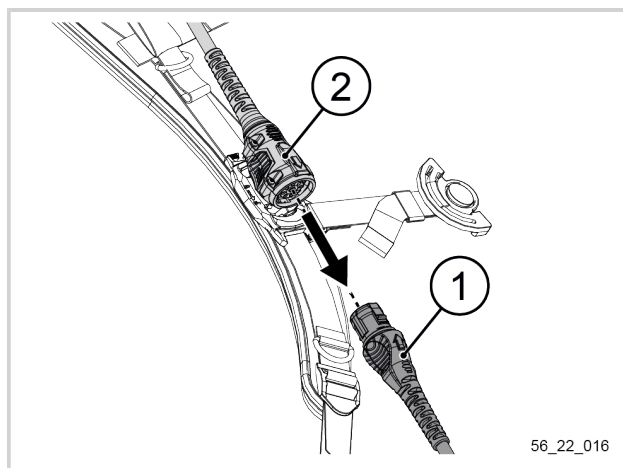

5. USE

5.1. SWITCHING THE BATTERY ON AND OFF

Refer to the battery operating instructions.

5.2. STARTING THE TOOL



Caution

Check that the safety devices are running properly before starting work.

1. Check the working area (fences, posts, etc.)
2. Place the rear handle in the correct position.
3. Connect the tool to the battery, see 4.6. Connecting the tool to the battery, page 15.
4. Turn on your battery.

Note

The front handle safety throttle trigger must be released when the power is turned on. If this is not the case, a flashing inside/outside LED appears and the tool remains non-functional.

Note

If at least 1 indicator light on the handle is on, the tool is powered up

To start the Helion 3 Electric hedge trimmer :

1. Hold the front handle safety throttle trigger (1) and pull the drive trigger (6) twice to start the tool.
2. Hold the front handle safety throttle trigger (1) and the drive trigger (6) while trimming.



54N_19_066

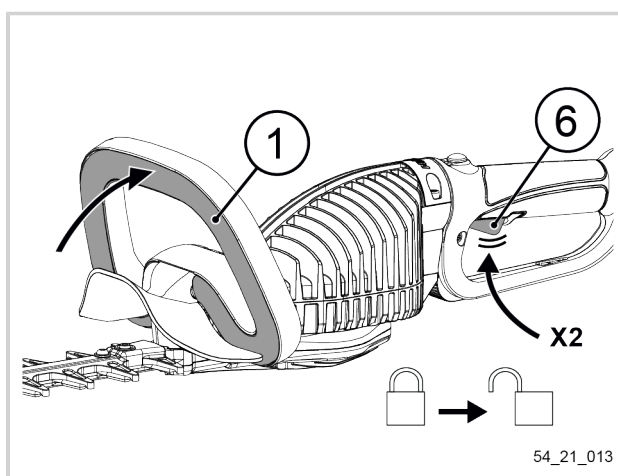

54_21_013

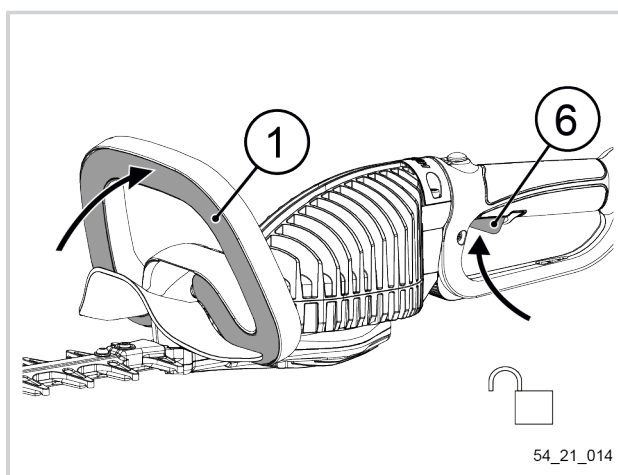

54_21_014

Note

If the control trigger is remains released for more than 5 minutes, repeat the above process to restart the tool.

The Helion 3 hedge trimmer allows quick connector connection / disconnection. To activate the function, the battery must remain on (switch on I)

Important

Always start the motor before bringing the blade into contact with the wood

5.3. STOPPING THE TOOL

1. Switch off the battery and disconnect the tool. 4.7.
2. Disconnecting the tool from the battery, page 15.
2. Fit the sleeve over the blade.

Note

Cover the cutter bar with the sheath in all of the following cases: transport, adjustment, handling and storage of the tool.

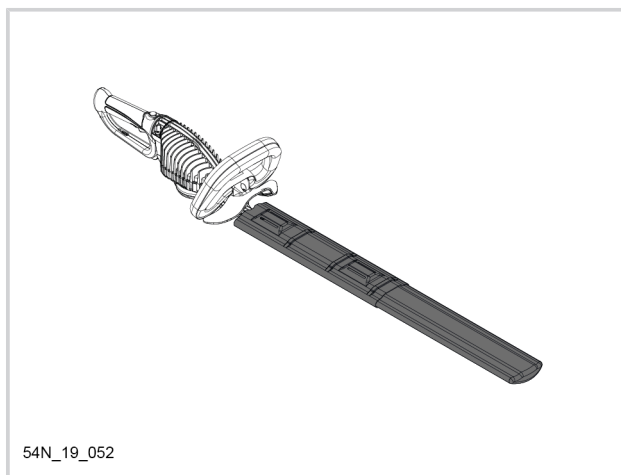

5.4. HEDGE-TRIMMING SPEED MANAGEMENT



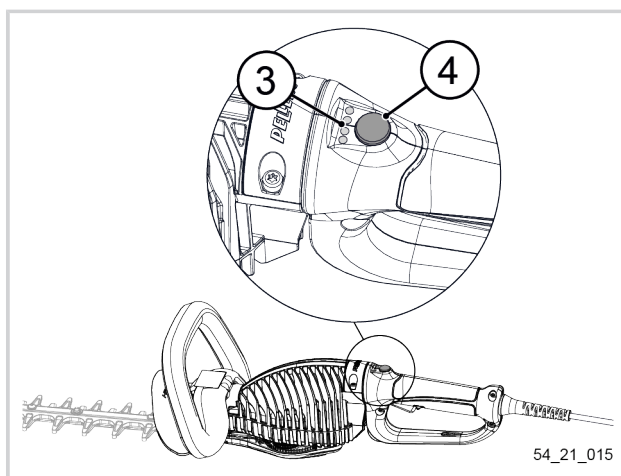

Speed setting

Your tool is equipped with a speed selector system. Changing speeds allows the desired quality of work to be optimised using the speed selector (4) located on the handle. **Four indicator LEDs (3) located on the handle indicate the selected speed level.**



Note

Reduce the speed to a minimum for increased battery autonomy or when the LEDS flash (close to thermal safety threshold stop).

	Speed 1 = 1 LED on (3200 cuts / min)
	Speed 2 = 2 LEDs on (3400 cuts / min)
	Speed 3 = 3 LEDs on (3600 cuts / min)
	Speed 4 = 4 LEDs on (3800 cuts / min)

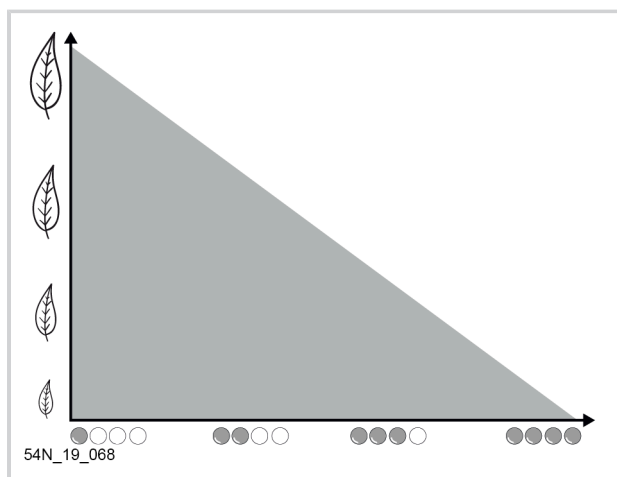

5.5. TIPS FOR USING THE ADAPTABLE CUTTER BAR

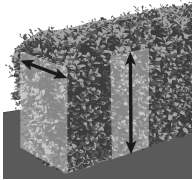
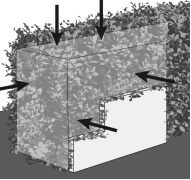
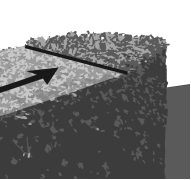
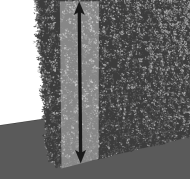
				
L51	“POSSIBLE USE”	“OPTIMAL USE” Pruning work over large sections	“POSSIBLE USE”	“POSSIBLE USE”
L63	“OPTIMAL USE” Dense vegetation in small sections	“POSSIBLE USE”	“POSSIBLE USE”	“POSSIBLE USE”
L75	“OPTIMAL USE” Gain depth of work on the top of the hedge	“POSSIBLE USE”	“POSSIBLE USE”	“OPTIMAL USE” Not very dense, output efficiency required.

5.6. WORKING TECHNIQUES



54_19_071

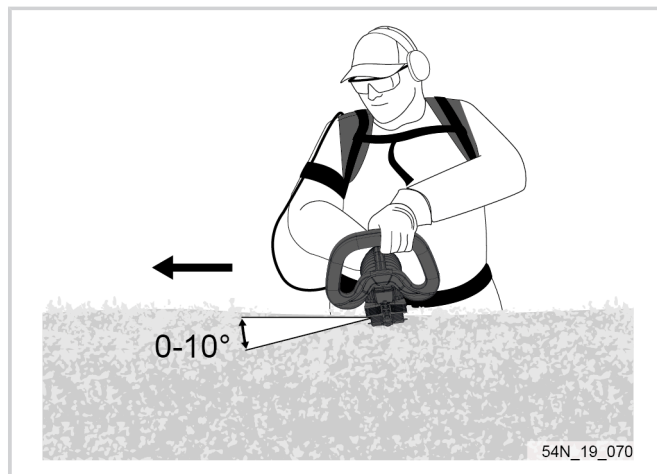
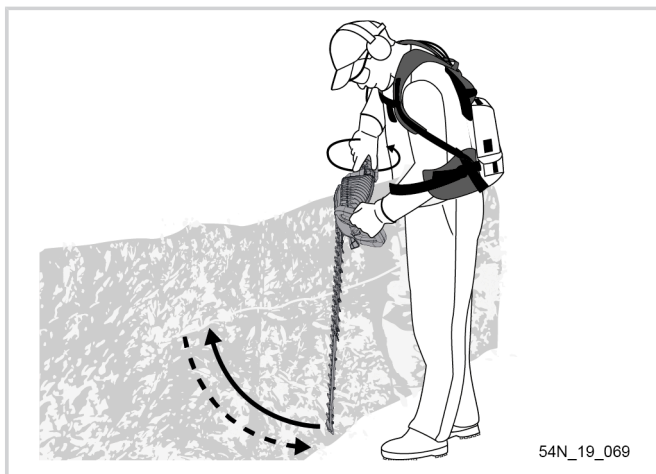

6. MAINTENANCE

6.1. FREQUENCY OF OPERATIONS



Caution

- All maintenance operations must be carried out with the battery switched off and the tool power cord disconnected from the battery, unless otherwise specified in the procedure.
- Use products recommended by PELLENC.
- Contact an authorised distributor PELLENC in the event of a problem.

Maintenance schedule

Operations	Frequency of operations			
	Prior to each use	Daily ¹	Every week	Every year or when necessary
Visually check the general condition of the tool.	X	X		
Check the operation of the handle and trigger.	X	X		
Check that the screws, bolts and nuts are tight.				If necessary
Clean the tool.		X		
Clean the quick connector base.				If necessary
Grease the gears. See 6.5. Hedge-trimmer blade lubrication, page 22.			X	Every 50 hours
Clean the blade. See 6.4. Cleaning the blades, page 21.		X		
Grease the blade.	X	X		

Operations	Frequency of operations			
	Prior to each use	Daily ¹	Every week	Every year or when necessary
Check the screws on the hedge trimmer blade.	X			If necessary Tightening torque for blade screws: 3.0 N.m Tightening torque for the 3 attachment screws: 4.0 N.m (5.0 N.m max)
Sharpen the blade. See 6.6. Sharpening the blades, page 23.				If necessary PELLENC authorised distributor
Adjust the blade.				If necessary
Have the tool checked by an authorised distributor PELLENC.				Every year or when necessary
Checking the battery.	Refer to the battery operating instructions.			

¹ Daily maintenance of the machine is understood to mean for daily use, after each working day.

6.2. ANNUAL OVERHAUL

Important

Ⓒ Have the machine serviced every 200 hours or at least once a year by an authorised distributor. PELLENC.

Always stock the tool clean and in a dry place, with the battery charged.

6.3. TIGHTENING BLADES



Caution

Always disconnect the hedge-trimmer from the battery before working on the blades.



Caution



Wear protective gloves when working on the blades.

Danger of accidental cuts.

The tightening of the blades is very important. This directly influences consumption (battery life).

1. Tighten the screw with a torque screwdriver.

Note

Tightening torque: 3 N.m.

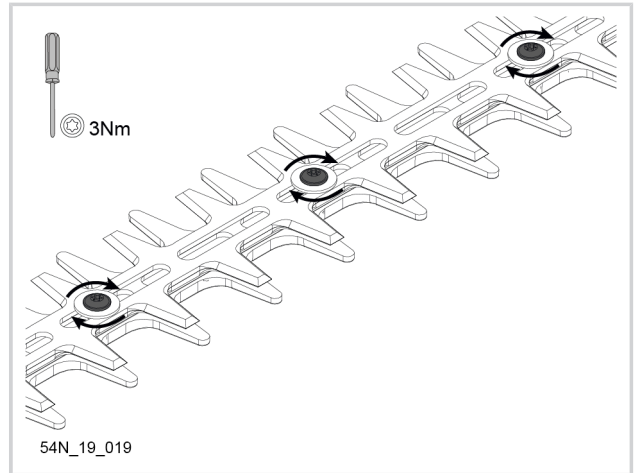

2. Check the position of the blades, using a set of spacing shims.

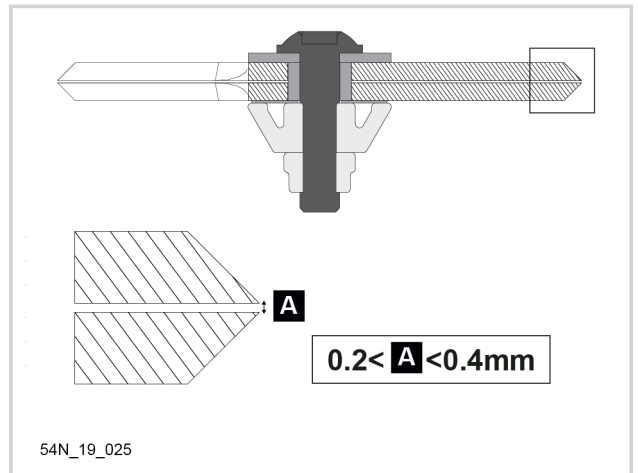

6.4. CLEANING THE BLADES



Caution

Always disconnect the hedge-trimmer from the battery before working on the blades.

Important

Energy consumption varies depending on the state of cleanliness of the tool.



Caution



Wear protective gloves when working on the blades.

Danger of accidental cuts.

1. Clean the blades with a damp cloth.

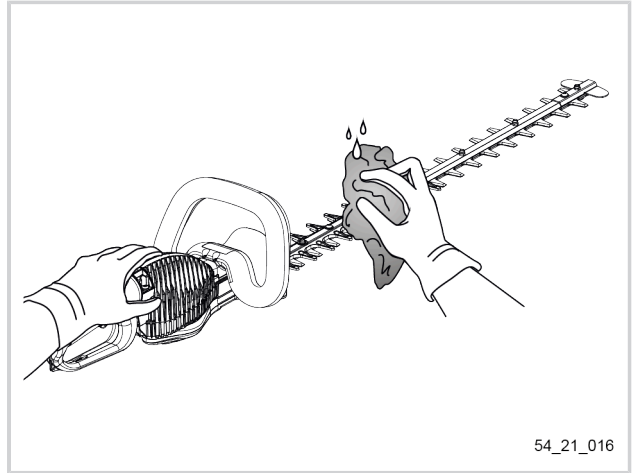

2. Check that there is no residue between the blades.

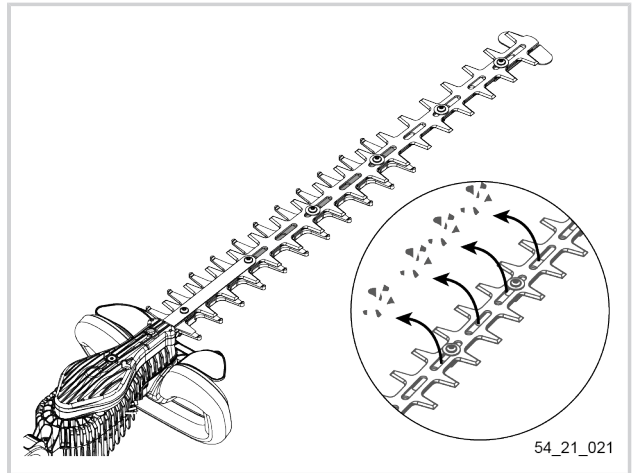

3. Clean and lubricate the blades with the cleaning/lubricating spray recommended by PELLENC (reference: 121633).



Warning

Ⓢ Never use solvents (trichloroethylene, white spirit, petrol, etc.) to clean the tool.

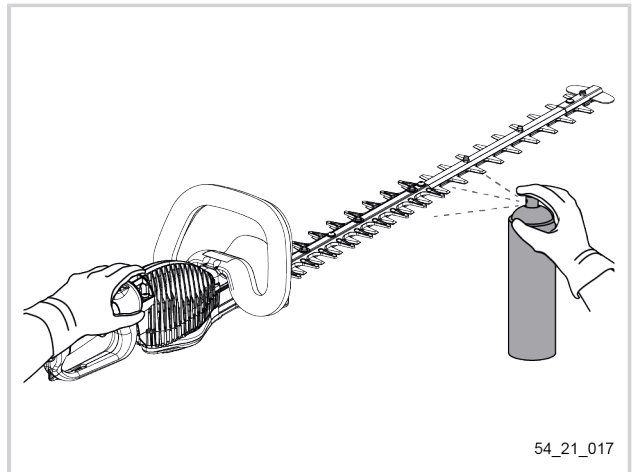

6.5. HEDGE-TRIMMER BLADE LUBRICATION



Caution

Always disconnect the hedge-trimmer from the battery before working on the blades.

1. Loosen the screw which gives access to the lubrication area of the hedge trimmer blade reducer using a T25 screwdriver.
2. Remove the screw.

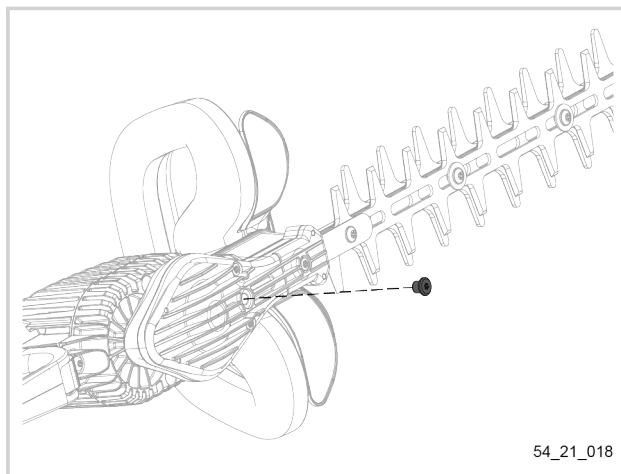

54_21_018

3. Grease the gears with the grease gun (20g grease maximum) recommended by PELLENC (reference: 74588 supplied with the blade or reference: 115174).
4. Refit the screw.
5. Tighten to torque using a T25 torque screwdriver.

Note

Tightening torque: 3 N.m.

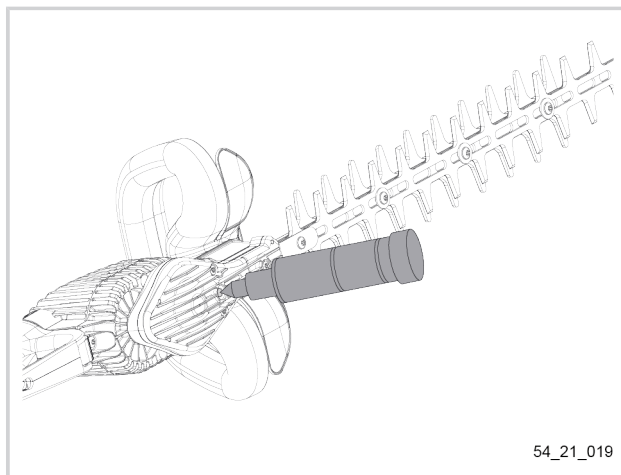

54_21_019

Note

The hedge trimmer blade reducer must be greased after the first 25 hours of operation and every 50 hours thereafter.

6.6. SHARPENING THE BLADES



Caution

Always disconnect the hedge-trimmer from the battery before working on the blades.



Caution

Wear protective gloves when working on the blades.

Danger of accidental cuts.

Sharpen the blades little and often. Regularly check how sharp the blades are for the first few hours to determine the required sharpening frequency.

Ensure the blade is at a 45° angle during sharpening.

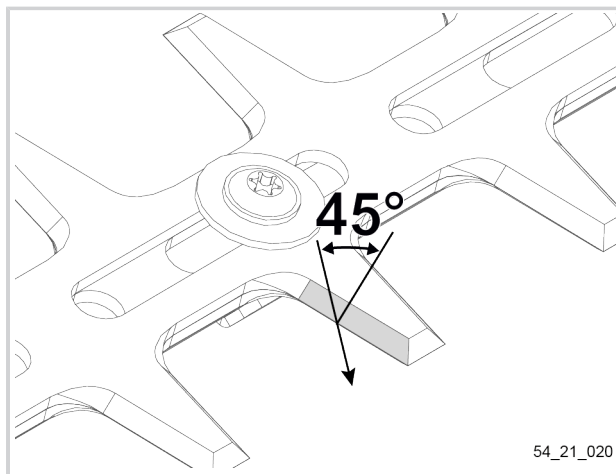

54_21_020

7. INCIDENTS AND TROUBLESHOOTING

Important

For any problems relating to the battery, please refer to the battery operating instructions. **PELENC recommends contacting an authorised PELENC dealer in all cases of breakdown.**

7.1. SYMPTOMS OF THE HELION 3 ELECTRIC HEDGE TRIMMER

Symptom	Check	Probable cause	Solutions
The hedge trimmer does not work	The LEDs are off	Battery discharged	Charge the battery
		Battery defective	Change the battery
		Wrong connection with the battery	Check the power cord
			Check the connections (tool and battery) Clean them with compressed air if necessary. Check that all switches are active. Repeat the operation if necessary.
	The LEDs are on	Safety at start-up/ Standby (Delay > 5min)	Double-click the trigger on the rear handle and pull the trigger on the front handle.
		The On/Off switches are defective	Unplug and replug the power cable. Restart the battery
		Cutting element blocked	Clean and lubricate the cutter bar
		Internal loose connection	Contact your authorised PELENC dealer
The hedge trimmer works intermittently	LEDs flashing inside/outside	Safety when switching on	Release the front handle
	The LEDs light-up intermittently	Damaged power cords	Change the power cable
	The LEDs are always on	Cutter bar is dirty	Clean and lubricate the cutter bar
		The On/Off switches are defective	Contact your authorised PELENC dealer

Tool protection

Symptom	Check	Probable cause	Solutions
The hedge trimmer shuts-down when working	LEDs flash before shut-down 1 long beep and 4 short beeps from battery before shutting down	Thermal protection of the tool	Clean and lubricate the cutter bar
			Allow the tool to cool down
	The LEDs are lit before shut-down	Internal loose connection	Contact your authorised PELENC dealer
		Over-voltage	Restart the tool
		Empty battery	Charge the battery

Caution

Always disconnect the hedge-trimmer from the battery before working on the blades.

8. STORAGE AND TRANSPORT

8.1. STORAGE

- Switch off the tool, refer to the battery operating instructions.
- Disconnect the battery, see 4.7. Disconnecting the tool from the battery, page 15.
- Put the tool in storage position, see 8.1.1. Putting the tool into storage position, page 25.
- Store the tool in a safe place, out of reach of children and unauthorized persons.
- When storing the battery, refer to the battery's operating instructions.

8.1.1. PUTTING THE TOOL INTO STORAGE POSITION

1. Install the blade guard of the cutter bar during transport and storage.

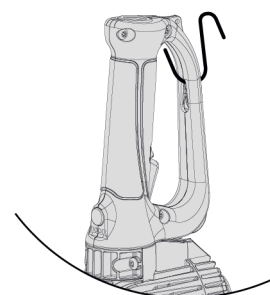
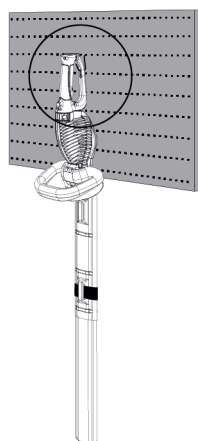

54N_19_080

8.2. STORAGE

Important

- In the case of prolonged storage, sharpen and lubricate the tool blade. See 6. Maintenance, page 19.
- Always store the tool with the gears greased.
- Make sure the chainsaw is always clean and the battery charged before storage.
- The Electric hedge trimmer Helion 3 should be stored away from heat, dust and moisture at an ambient temperature of between 10°C and 35°C.
- The machine and the battery must be stored in their original packaging, in a dry place and out of the reach of children.

8.3. TRANSPORT

Important

Never carry the tool or the battery by the power cord.

- Switch off the tool, see 5.1. Switching the battery on and off, page 15.
- Disconnect the battery, see 4.7. Disconnecting the tool from the battery, page 15.
- Put the tool in storage position, see 8.1.1. Putting the tool into storage position, page 25.
- Ensure that the tool and battery are packed and properly secured in the transport vehicle.

9. ACCESSORIES AND CONSUMABLES

9.1. INCLUDED ACCESSORIES

For a list of accessories included with the tool, see 4.1. Package contents, page 12.

9.2. INTRODUCTION TO CUTTER BARS

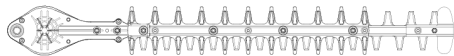
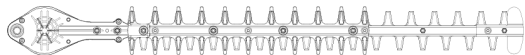
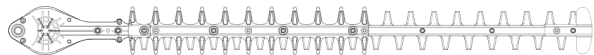
L51	Reference: 56205	 54N_19_035
L63	Reference: 56206	 54N_19_037
L75	Reference: 56207	 54N_19_038

9.2.1. ACCESSORIES PROVIDED WITH EACH BLADE

- Protective sleeve
- Assembly instructions
- The blade's certificate of conformity

9.3. OPTIONAL ACCESSORIES

Name	Part number
Battery adapter cord	57239
Power cord support clips	101056

9.4. CONSUMABLES

Name	Part number
PELLENC 400g Grease cartridge	115174
PELLENC cleaning spray	121633
Grease gun	68518

10. WARRANTIES

10.1. GENERAL WARRANTIES

10.1.1. STATUTORY WARRANTY

10.1.1.1. LATENT DEFECTS WARRANTY

Apart from the commercial warranty provided for under Article II, Article 1641 of the Civil Code provides that "the seller is bound to a warranty on account of latent defects of the object sold which render it unfit for the use for which it was intended, or which would impair said use to the extent that the buyer would not have acquired it, or would only have given a lesser price for it, had he known of them".

Article 1648 of the Civil Code "The action resulting from latent defects must be brought by the purchaser within two years after the discovery of the defect".

10.1.1.2. LEGAL WARRANTY OF CONFORMITY

Article L.217-4 of the Consumer Code "The seller delivers goods in conformity with the contract and is liable for defects of conformity existing upon delivery.

The seller is also liable for any lack of compliance resulting from the packaging, assembly or installation instructions whenever its contractual liability is engaged in this regard or the latter are carried out under its responsibility.

Article L.217-5 of the French Consumer Code "Goods are compliant with the contract":

1. Where they are fit for the purpose normally expected of similar goods and, where applicable:
 - If it matches the description given by the seller and possesses the qualities that were presented to the purchaser in the form of a sample or model;

- If it possesses the qualities that a purchaser can reasonably expect given the public statements made by the seller, the producer or its representative, especially in advertising or labelling;
- 2. Or if it has the characteristics defined by mutual agreement between the parties or be suitable for any special use sought by the buyer, brought to the attention of the seller and accepted by the latter.

Article L.217-12 of the Consumer Code "legal action resulting from lack of conformity lapses two years after delivery of the goods".

10.1.2. COMMERCIAL WARRANTY PELENC

10.1.2.1. CONTENTS

10.1.2.1.1. GENERAL INFORMATION

In addition to the legal guarantees, user customers benefit from the commercial guarantee on the products PELENC covering the exchange and replacement of parts recognized as out of use, by default of machining, by defect of assembly or by defect of material, whatever the cause.

The warranty is fully integral to the product sold by PELENC.

10.1.2.1.2. SPARE PARTS

The commercial warranty also covers original spare parts PELENC, excluding labour excluding certain spare parts of each product delivered on delivery.

10.1.2.2. DURATION OF WARRANTY

10.1.2.2.1. GENERAL INFORMATION

Products PELENC connected to a battery are covered by the commercial warranty from the date of delivery to the user customer for a period of two (2) years PELENC, and for a period of one (1) year in respect of other products PELENC.

10.1.2.2.2. SPARE PARTS

Spare parts PELENC replaced under the product warranty, are guaranteed under the commercial warranty from the delivery of the product PELENC to the user customer for a period of two (2) years in the case of products connected to a battery PELENC, and for a period of one (1) year in respect of other products PELENC.

In the case of products connected to a battery PELENC parts that are replaced under the product warranty after the 12th month of use, are covered for a period of one (1) year.

10.1.2.2.3. WARRANTY EXCLUSIONS

Products that have been subject to abnormal use, or that were used under conditions and for purposes other than those for which they were manufactured, especially in the case of non-compliance with conditions stipulated in this user manual are excluded from the commercial warranty.

It does not apply in case of shock, fall, neglect, lack of supervision or maintenance or in case of transformation of the product. Also excluded from the warranty are products that have been subject to tampering, alteration or modification by the customer user.

Wear parts and/or consumables are not covered by the warranty.

10.1.2.3. IMPLEMENTATION OF THE COMMERCIAL WARRANTY**10.1.2.3.1. PRODUCT COMMISSIONING AND COMMISSIONING DECLARATION**

No later than eight days after delivery of the goods to the customer-user, DISTRIBUTOR undertakes to complete the computerised declaration of the commissioning form in order to activate the latter on the website www.pellenc.com, under the heading "Extranet Access" in the "Pellenc Extranet Service" menu, using the identifier previously issued by PELLENC.

Otherwise, the declaration of commissioning will not be effective thus preventing any implementation of the commercial guarantee PELLENC, the DISTRIBUTOR must therefore ensure the financial burden alone without being able to pass on the cost of its intervention under the guarantee to the user customer.

The DISTRIBUTOR shall also undertake to complete the warranty card or the certificate of warranty and commissioning for self-propelled equipment provided with the product after having the client user sign and date it.

10.1.3. PAID AFTER-SALES SERVICE**10.1.3.1. GENERAL INFORMATION**

Malfunctions, breakdowns, breakages resulting from misuse, neglect or improper maintenance by the client user as well as malfunctions resulting from normal wear of the product are subject to the payment of after-sales service, even during the period of the legal and commercial warranty. After-sales service repairs that fall outside of the legal and commercial warranty also include maintenance, adjustments, diagnostics of all types, and cleaning without the present list being exhaustive.

10.1.3.2. WEAR PARTS AND CONSUMABLES

Wear parts and consumables also fall within the after-sales service.

10.1.3.3. SPARE PARTS

The commercial warranty also covers original spare parts PELLENC, excluding labour and outside the legal or commercial warranty period.

In case of replacement of original spare parts PELLENC in the context of after-sales service, said latter are covered by a warranty of one year as from the installation date.

11. COMPLIANCE STATEMENTS

11.1. DECLARATION OF CONFORMITY: HELION 3

MANUFACTURER / PERSON AUTHORISED TO COMPILE THE TECHNICAL FILE	PELENC
ADDRESS	Quartier Notre-Dame - 84120 Pertuis (France)

We hereby declare that the machine designated below:

GENERIC DENOMINATION	ELECTRIC HEDGE TRIMMER		
FUNCTION	ELECTRIC BATTERY POWERED HEDGE TRIMMER INTENDED FOR TRIMMING BUSHES / HEDGES		
COMMERCIAL NAME	HELION 3		
TYPE	HELION 3		
MODEL	HELION 3		
SERIAL NUMBER	54Y00001 - 54Y49999	54Z00001 - 54Z49999	54A00001 - 54A49999

This declaration of conformity is issued under the sole responsibility of the manufacturer.

The object of the declaration described above is in conformity with the relevant Union harmonisation legislation:

- Directive 2006/42/EC
 - EN 62841-1:2015
 - EN 62841-4-2:2019
- Directive 2014/30/EU
 - EN 55014-1:2017 + A11:2020
 - EN 55014-2:2015
- 2012/19/EU
- Directive 2000/14/EU
 - EN ISO 3744:1995
 - ISO 11094:1991
- 2011/65/EU
- Regulation (EC) No 1907/2006

Sound level at the maximum operating rating

MODEL	HELION 3
Measured sound power according to Directive 2000/14 /EC	$L_{WA} = 92 \text{ dB (A)}$
Guaranteed sound power according to Directive 2000/14 /EC	$L_{WA,d} = 93 \text{ dB (A)}$

The measured sound power level and the guaranteed sound power level were recorded by the notified body SGS-CSTC Shanghai, 588 West Jindu Road, Xinqiao, Songjiang, 201612 Shanghai, China following a procedure in accordance with Directive 2000/14/EC Annex V. The certificate numbers are: SHES210901802471.

Signed for and on behalf of:

Simon BARBEAU
 DIRECTEUR GÉNÉRAL



PERTUIS, 10/01/2024

PELENC

   www.pellenc.com

PELENC
Quartier Notre Dame - 84120 Pertuis (France)

