

ENG

Translate of the
original manual



PRUNING SHEARS C35

Operating instructions

26_153033-C
02/2023

READ THE USER OPERATING GUIDE CAREFULLY BEFORE USE

TABLE OF CONTENTS

1. INTRODUCTION	6
2. SAFETY	7
2.1. INTENDED USAGE	7
2.2. GENERAL SAFETY INSTRUCTIONS FOR THE ELECTRICAL TOOL	7
2.2.1. WORK AREA SAFETY	7
2.2.2. ELECTRICAL SAFETY	7
2.2.3. PERSONAL SAFETY	8
2.2.4. USE AND CARE OF THE POWER TOOL	8
2.2.5. BATTERY TOOL USE AND CARE	8
2.2.6. MAINTENANCE	9
2.2.7. MANAGEMENT OF THE RECYCLING AND RECOVERY OF WASTE FROM YOUR TOOL	9
2.3. SAFETY MEASURES RELATED TO THE USE OF THE BATTERY AND THE CHARGER PELLENC	9
2.4. SAFETY WARNINGS FOR BATTERY-POWERED SHEARS	9
2.5. SAFETY SIGNAGE	10
2.6. PERSONAL PROTECTIVE EQUIPMENT	11
3. DESCRIPTION AND TECHNICAL CHARACTERISTICS	12
3.1. DESCRIPTION OF THE TOOL	12
3.2. TECHNICAL FEATURES OF THE TOOL	12
3.2.1. GENERAL CHARACTERISTICS OF THE TOOL	12
3.2.2. BATTERY COMPATIBILITY	13
3.2.3. VIBRATION AND NOISE EMISSION VALUES	13
3.3. PRESENTATION OF ACTIV' SECURITY	14
4. START-UP	15
4.1. CONTENTS OF THE C35 CASE + ULIB 150 BATTERY	15
4.2. CONTENTS OF THE C35 CASE + ULIB 250 BATTERY	15
4.3. FITTING OF THE BATTERY ON THE HARNESS (ULIB 250 BATTERY)	15
4.4. FITTING THE HOLSTER TO THE BELT	15
4.5. CONNECTING THE TOOL TO THE ULIB 150 AND 250 BATTERIES	16
4.6. DISCONNECTING THE TOOL FROM THE ULIB 150 AND 250 BATTERIES	16
4.7. PUTTING THE LEAD AND ARMBAND IN PLACE	16
5. USING THE TOOL	17
5.1. SWITCHING THE BATTERY ON AND OFF	17
5.2. ACTIV' SECURITY TOOL ACTIVATED	17
5.3. ACTIV'SECURITY DEACTIVATED	18
5.3.1. DEACTIVATE ACTIV' SECURITY	18
5.3.2. STARTING THE TOOL WITH ACTIV' SECURITY DEACTIVATED	19
5.3.3. ACTIVATION OF ACTIV' SECURITY	20
5.4. BLADE OPENINGS	21
5.4.1. FULL OPENING OF THE BLADE	21

5.4.2. OPTICAL SENSOR AND HALF-OPENING	22
5.5. SWITCHING TO AND FROM STANDBY	22
5.5.1. AUTOMATIC STANDBY MODE	22
5.5.2. MANUAL STANDBY MODE	23
5.5.3. STANDBY EXIT	23
5.6. HMI (HUMAN MACHINE INTERFACE) SETTINGS OF THE TOOL	23
5.6.1. USAGE MODES	23
5.6.2. AUTHORISATION MODES	25
5.6.3. "FUNCTIONAL" SETTING MODES	27
6. MAINTENANCE	29
6.1. SERVICING FREQUENCY	29
6.2. MAINTENANCE ADVICE	30
6.3. CHECK	30
6.3.1. CHECKING THE OPERATION OF THE ACTIV'SECURITY AND THE CONDUCTIVITY OF THE GLOVES	30
6.3.2. VISUAL CHECK OF THE GENERAL CONDITION OF THE TOOL	31
6.3.3. CHECKING THE OPERATING TRIGGER	31
6.4. SHARPENING THE BLADE	32
6.5. CHECK THE TIGHTNESS OF THE BLADE	33
6.6. GREASING THE BLADE	33
6.7. CLEANING THE TOOL	33
6.8. CHECKING THE CROSSING OVER OF THE HOOK AND THE BLADE	34
6.9. CHANGING BLADE OR SHAFT	35
6.9.1. REMOVAL OF THE BLADE AND ITS PIN	35
6.9.2. FITTING OF THE BLADE AND ITS PINS	36
7. INCIDENTS AND TROUBLESHOOTING	38
7.1. TABLE OF INCIDENTS AND BREAKDOWNS	38
7.2. ACTIV' SECURITY LED CODES SUMMARY	39
8. STORAGE AND TRANSPORT	40
8.1. STORAGE	40
9. ACCESSORIES AND CONSUMABLES	40
9.1. ACCESSORIES INCLUDED	40
9.2. OPTIONAL ACCESSORIES	40
9.3. CONSUMABLES	40
10. WARRANTIES	41
10.1. GENERAL WARRANTIES	41
10.1.1. STATUTORY WARRANTY	41
10.1.2. COMMERCIAL WARRANTYPELLENC	41
10.1.3. PAID AFTER-SALES SERVICE	42
10.2. SPECIFIC WARRANTIES	43
11. STATEMENTS OF COMPLIANCE	44

11.1. DECLARATION  OF CONFORMITY: C35	44
--	----

1. INTRODUCTION

Dear Customer,

Thank you for purchasing your Pruning shears C35. Properly used and maintained, this equipment will give you years of satisfaction.



Warning

In accordance with product liability laws, we are not responsible for damage caused by our product if the product includes an accessory that is not from the manufacturer or is not approved by the manufacturer. The use of any other accessory may increase the risk of injury.



Warning

Your device contains numerous recoverable or recyclable materials. Return it to your dealer or, failing this, to an approved servicing centre to be treated.



Comply with the regulations in force in your country as concerns environmental protection associated with your activity.



Warning

It is imperative that you read through the ENTIRE user's manual guide before using or servicing the tool. Always comply with the instructions and illustrations in the manual.

All through this user guide you will find advisory notes and information entitled: NOTE, IMPORTANT, ATTENTION and WARNING.

Points marked "NOTE" indicate additional information.

Points marked "IMPORTANT" warn the user of a potential risk for the equipment.

Points marked "CAUTION" warn the user of a potentially hazardous situation which if not avoided may result in minor injuries.

Points marked "WARNING" warn the user of a potentially hazardous situation which if not avoided may result in serious injury or death.

Warning  indicates the guarantee will not cover any damage resulting from failure to comply with the procedures and instructions, for which the owner will incur the repair costs.

Safety signs on the tool also indicate the safety precautions to be observed. Locate these signs and read them before using your machine. Any partially illegible or damaged sign should be replaced immediately.

Refer to 2.5. Safety signage, page 10 for the location diagram of the safety stickers affixed to the tool.

No part of this manual may be reproduced without the written permission of the company PELLENC. The illustrations provided in this manual are for information purposes only and are in no way contractual. The company PELLENC reserves the right to make any modifications or improvements it deems necessary to its products without informing customers already in possession of a similar model. This manual forms an integral part of the tool and must accompany the tool if it changes hands.

2. SAFETY

2.1. INTENDED USAGE

- The Pruning shears C35 is intended for vineyard, fruit-tree, olive-growing and landscape maintenance pruning up to a diameter of 35 mm.
- The Pruning shears C35 must be operated from the ground or a suitable fully stable and secure platform.
- The Pruning shears C35 is only intended for outdoor use.
- The Pruning shears C35 is not intended for any other use.
- Only original or manufacturer approved spare parts (e.g. blade kit, maintenance kit) may be fitted to the Pruning shears C35.
- The user is responsible for any accident resulting from improper use or unauthorised modification of the Pruning shears C35.

2.2. GENERAL SAFETY INSTRUCTIONS FOR THE ELECTRICAL TOOL



Warning

Read all safety warnings, instructions, illustrations and specifications provided with this power tool. Failure to follow the warnings and instructions may result in electric shock, fire and/or serious injury.

Note

Retain all the safety measures and instructions for later reading.

The term "power tool" in the safety warnings refers to your battery-powered electric tool (without power cord).

2.2.1. WORK AREA SAFETY

1. **Keep the work area clean and well lit.** Cluttered or dark areas invite accidents.
2. **Do not operate power tools in an explosive atmosphere, for example in the presence of flammable liquids, gases, or dust.** Power tools create sparks, which can ignite dust or fumes.
3. **Keep children and bystanders away while operating the power tool.** Distractions can cause you to lose control of the tool.

2.2.2. ELECTRICAL SAFETY

1. **Power tool plugs must match the outlet. Never modify the plug in any way. Do not use adapter plugs with earthed (grounded) power tools.** Unmodified plugs and matching outlets will reduce risk of electric shock.
2. **Avoid body contact with earthed or grounded surfaces, such as pipes, radiators, ranges and refrigerators.** There is an increased risk of electric shock if your body is in direct contact with the ground.
3. **Do not expose power tools to rain or damp conditions.** Water entering a power tool will increase the risk of electric shock (Except for tools for which an "IP" index is specified).
4. **Do not abuse the cord. Never use the cord for carrying, pulling or unplugging the power tool. Keep cord away from heat, oil, sharp edges, and moving parts.** Damaged or entangled cords increase the risk of electric shock.
5. **Use an extension cord suitable for outdoor use when operating power tools outdoors.** Use a cord suitable for outdoors to reduce the risk of electric shock.
6. **If operating a power tool in a damp location is unavoidable, use a residual current device (RCD) protected supply.** Use of an RCD reduces the risk of electric shock.

2.2.3. PERSONAL SAFETY

1. **Stay alert, watch what you are doing, and use common sense when operating a power tool. Do not use a power tool when you are tired or under the influence of drugs, alcohol, or medication.** A moment of inattention when using a power tool can result in serious personal injury.
2. **Use personal protective equipment. Always wear eye protection.** Protective equipment such as dust mask, non-skid safety shoes, hard hat, or hearing protection used for appropriate conditions will reduce personal injuries.
3. **Prevent unintentional starting. Make sure the switch is in the off position before you connect the tool to the power source and/or battery pack, pick it up, or carry it.** Carrying power tools with your finger on the switch or plugging in power tools with the switch in the on position can cause accidents.
4. **Remove any adjusting wrench before switching the electric tool on.** A wrench or a key left attached to a rotating part of the power tool may result in personal injury.
5. **Do not overreach. Keep proper footing and balance at all times.** This enables better control of the power tool in unexpected situations.
6. **Dress properly. Do not wear loose clothing or jewelry. Keep your hair and clothing away from moving parts.** Loose clothes, jewellery or long hair can get caught in moving parts.
7. **If devices are provided for the connection of dust extraction and collection facilities, ensure that these are connected and properly used.** Use dust collectors to reduce the risk caused by dust.
8. **Do not let familiarity gained from frequent use of tools allow you to become complacent and ignore tool safety principles.** A moment of inattention can result in serious personal injury.

2.2.4. USE AND CARE OF THE POWER TOOL

1. **Do not force the power tool. Use the correct power tool for your application.** The correct power tool will do the job better and safer at the rate for which it was designed.
2. **Do not use the power tool if the switch does not turn it on and off.** Power tools that cannot be controlled by a switch are dangerous and must be repaired.
3. **Disconnect the plug from the power source and/or remove the battery pack, if detachable, from the power tool before making any adjustments, changing accessories, or storing power tools.** Such preventive safety measures reduce the risk of starting the power tool accidentally.
4. **Store idle power tools out of the reach of children and do not allow persons unfamiliar with the power tool or these instructions to operate the power tool.** Power tools are dangerous in the hands of untrained users.
5. **Maintain power tools and accessories. Check for misalignment or binding of moving parts, breakage of parts and any other condition that may affect the power tool's operation. If damaged, have the power tool repaired before use.** Many accidents are due to poorly maintained power tools.
6. **Keep the cutting tools sharp and clean.** Properly maintained cutting tools with sharp cutting elements are less likely to jam and are easier to control.
7. **Use the power tool, accessories, blades, etc. in accordance with these instructions, taking into account the working conditions and the work to be done.** Using the power tool for operations other than those specified can result in hazardous situations.
8. **Handles and gripping surfaces must be kept dry, clean and free from oils and grease.** Slippery handles and grasping surfaces do not allow for safe handling and control of the tool in unexpected situations.

2.2.5. BATTERY TOOL USE AND CARE

1. **Recharge only with the charger specified by the manufacturer.** A charger that is suitable for one type of battery pack may create a risk of fire when used with another battery pack.
2. **Use power tools only with specifically designated battery packs.** Use of any other battery pack may create a risk of injury and fire.
3. **When battery pack is not in use, keep it away from other metal objects, like paper clips, coins, keys, nails, screws or other small metal objects, that can make a connection from one terminal to another.** Shorting the battery terminals together may cause burns or a fire.
4. **Under abusive conditions, liquid may be ejected from the battery; avoid contact. If contact accidentally occurs, flush with water. If liquid contacts eyes, additionally seek medical help.** Liquid ejected from the battery may cause irritation or burns.

5. **Do not use a battery pack or tool that is damaged or modified.** Damaged or modified batteries may exhibit unpredictable behaviour resulting in fire, explosion or risk of injury.
6. **Do not expose a battery pack or tool to fire or excessive temperature.** Exposure to fire or temperature above 130°C (or 265°F) may cause explosion.
7. **Follow all charging instructions and do not charge the battery pack or tool outside the temperature range specified in the instructions.** Charging improperly or at temperatures outside the specified range may damage the battery and increase the risk of fire.

2.2.6. MAINTENANCE

1. **Have the power tool serviced by a qualified technician, using only identical spare parts.** This will ensure that the safety of the power tool is maintained.
2. **Never service damaged battery packs.** Service of battery packs should only be performed by the manufacturer or authorized service providers.

2.2.7. MANAGEMENT OF THE RECYCLING AND RECOVERY OF WASTE FROM YOUR TOOL

1. **When the tool reaches the end of its life, PELLENC provide the end-of-life sheet of the equipment.** The end-of-life sheet provides instructions for safely removing components.

2.3. SAFETY MEASURES RELATED TO THE USE OF THE BATTERY AND THE CHARGER PELLENC

Note

See the operating instructions for the battery.



Warning

Read all safety warnings and all instructions. Retain all the safety measures and instructions for later reading.

2.4. SAFETY WARNINGS FOR BATTERY-POWERED SHEARS

This device is not intended for use by individuals (including children) with reduced physical, sensory or mental capabilities, nor by anyone lacking in experience or knowledge, except if they are supervised or have received prior instructions from a person responsible for their safety.



Warning

Read carefully all the instructions on the Activ' Security for your Pruning shears C35 before use, see 5.3. Activ'Security deactivated, page 18.

1. Never modify the connector in any way whatsoever.
2. This tool may cause severe injuries. Carefully read the instructions regarding the proper handling, operation, maintenance, startup and stopping the shears. Familiarize yourself with all its controls and proper use.
3. When the tool is not in use, always switch off the battery (both LEDs on the tool should be off).
4. Do not leave the tool in the ground or exposed to the weather.
5. Make sure that the blade is not in contact with any object before starting the tool.
6. Never use the tool if it is damaged, incorrectly set or incompletely assembled.
7. Never remove or disable a safety device. Have the safety device repaired if is faulty.
8. Never disconnect the power cord from the tool without checking that the red and green LEDs on the left and right of the battery display are off.

9. Never carry the tool by the power cord.
10. Do not disassemble the tool.
11. Do not try to cut pieces of wood that are too large or other materials than wood.
12. Please test the tool before use to check that it is working properly.

2.5. SAFETY SIGNAGE

California State Proposition 65:



Caution

This product contains or emits a chemical recognized by the State of California to cause cancer, birth defects or other reproductive harm.

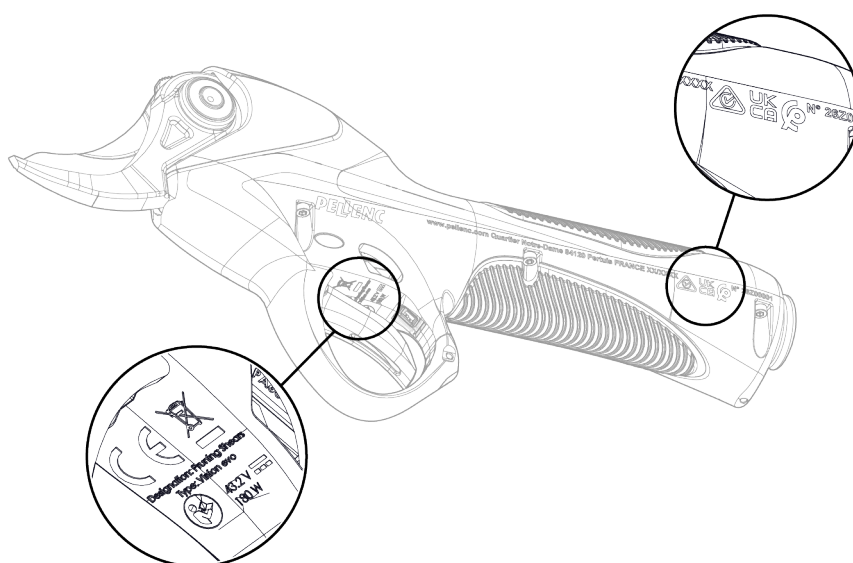

26_22_050



00_24_PICTO_019

Do not expose to rain.



Please read the operating instruction manual.

Read the manual carefully and follow the safety precautions.

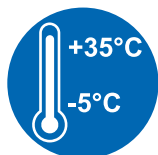

This equipment must be used at a temperature of -5° to +35°C.



Waste electrical and electronic equipment.

At the end of its life, the tool and the battery must be returned to the authorised distributor from whom they were purchased to be



Regulatory Compliance Mark (RCM).

The product complies with the regulatory requirements of Australia and New Zealand for electrical safety, electromagnetic compatibility, radio frequency.

Tool compliant with Moroccan standards.



Tool compliant with British standards.



Independent Communications Authority of South Africa

The product complies with the strict radio interference standards set by ICASA at the approved frequency.

recycled in accordance with waste regulations.

Tool compliant with EC standards.

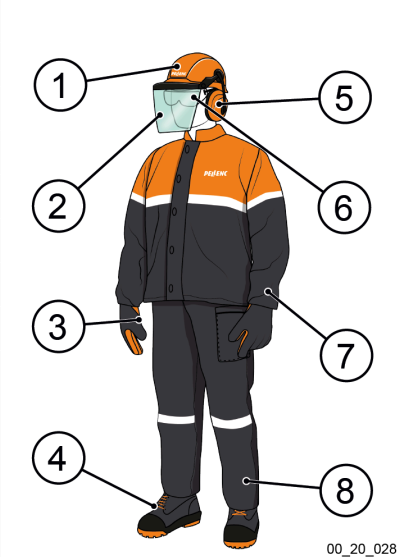

2.6. PERSONAL PROTECTIVE EQUIPMENT

	Equipment		Wear
	1	Safety helmet	--
	2	Protective visor	--
	3	Activ' Security PELLENC Gloves	Recommended
	4	Safety footwear	Mandatory
	5	Hearing protection	--
	6	Protective glasses	Recommended
	7	Safety jacket or over-sleeves	--
	8	Work trousers	--

3. DESCRIPTION AND TECHNICAL CHARACTERISTICS

3.1. DESCRIPTION OF THE TOOL

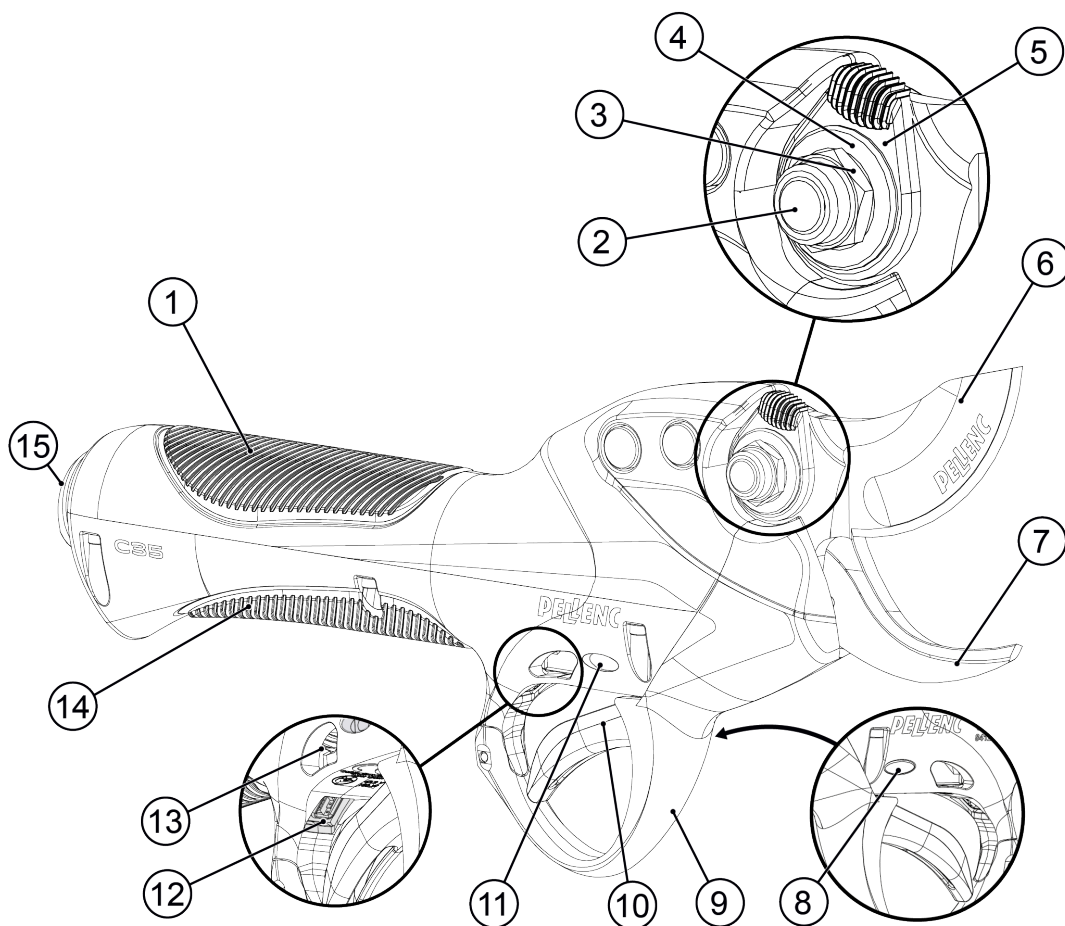

26_21_007

- | | |
|---|--|
| 1. Upper pad | 9. Guard |
| 2. Blade pin | 10. Drive trigger |
| 3. Nut | 11. Activ' Security indicator LED (right side of the tool) |
| 4. Washer | 12. Optical sensor |
| 5. Knurled adjustment washer | 13. Waste evacuation system |
| 6. Blade | 14. Lower conductive pad |
| 7. Hook | 15. Power cord connector |
| 8. Mode indicator LED (left side of the tool) | |

3.2. TECHNICAL FEATURES OF THE TOOL

3.2.1. GENERAL CHARACTERISTICS OF THE TOOL

Cutting capacity	35 mm
Pruning shears power supply voltage	43.2 V
Maximum electrical power	800 W
Battery life	Depending on the use and type of battery
Weight of pruning shears	720 g

3.2.2. BATTERY COMPATIBILITY

Battery	Charger
ULIB 150	CB5004HV2 CB5010HV (+ adapter ref.152147)
ULIB 250	CB5010HV+

3.2.3. VIBRATION AND NOISE EMISSION VALUES

The determination of noise levels and vibration rates is based on operating conditions at maximum rated speed according to a standardised test method. It can be used to compare two machines.

The declared total vibration value(s) and the declared noise emission value(s) may also be used in a preliminary exposure assessment.

Safety measures need to be identified to protect the operator based on an estimate of exposure under actual use conditions (taking account of all parts of the operating cycle such as the times when the tool is switched off and when it is running idle in addition to the trigger activation time).

Sound pressure values

Maximum sound pressure level at the user's position (uncertainty K_{pA} : 1.5 dB (A))	$L_{pa} = 63$ dB (A)
---	----------------------

Sound power values

Measured sound power level L_{WA} (uncertainty K_{WA} : 0.6 dB(A))	$L_{WA_{m}} = 73.38$ dB
Guaranteed sound power level $L_{WA_{g}}$	$L_{WA_{g}} = 74$ dB

The measured noise level and the guaranteed noise level were measured according to a procedure in accordance with Directive 2000/14 / EC Annex V.

Vibration values

Vibration emission values at the handle determined in accordance with EN 50636-2-100	$a_h = 0.68$ m/s ²
--	-------------------------------

The total declared values for vibration and noise emissions can be used for a preliminary exposure assessment.

Caution

Vibrations during actual working use of the tool may differ from the total declared value, depending on the way the machine is used.

It is necessary to identify safety measures to protect the operator, based on an estimate of exposure under actual operating conditions (taking into account all parts of the operating cycle, such as the time the machine is switched off and the time it is idling, in addition to the working time).

3.3. PRESENTATION OF ACTIV' SECURITY

The Pruning shears C35 is equipped with a patented anti-cutting injuries system, the **Activ' Security**.

This technology allows the blade to stop immediately when it comes into contact with the operator's finger or hand, with gloves PELLENC or without gloves.

The Activ' Security works thanks to a natural conductive circuit created via 3 contact points.

Note

The use of conductive gloves PELLENC is recommended for optimal safety in very wet or extreme conditions.

Two model types are available:

- The Activ' Security Comfort glove, a special size and preserves dexterity at work.
- The Activ' Security Vegetation glove, specially for thicker branches, with a waterproof and breathable membrane, ideal for clearing wood.

See 9.2. Optional accessories, page 40.

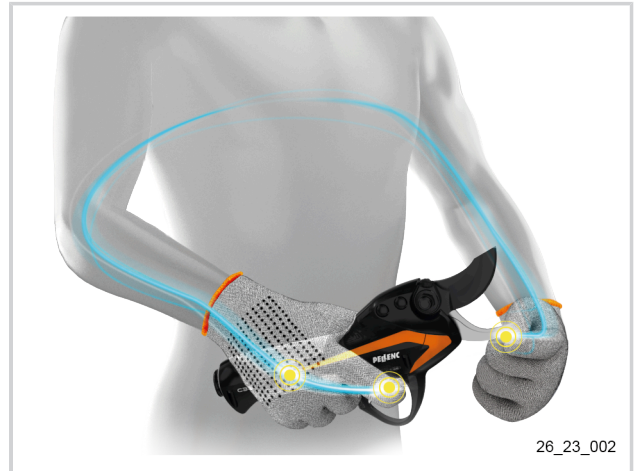

26_23_002

4. START-UP

Note

For more information on battery start-up instructions, refer to the battery operating instructions.

4.1. CONTENTS OF THE C35 CASE + ULIB 150 BATTERY

Check that the tool is delivered with:

- 1 C35 pruning shears
- 1 ULIB 150 battery
- 1 CB5004HV2 battery charger and power cord
- 1 holster to be fitted on the adjustable belt
- 1 adjustable belt
- 1 armband
- 1 sharpening stone
- 1 grease gun
- 1 tube of grease
- 1 tool operating instructions manual
- 1 battery 150 operating instructions manual
- 13 mm angled wrench

4.2. CONTENTS OF THE C35 CASE + ULIB 250 BATTERY

Check that the tool is delivered with:

- 1 C35 pruning shears
- 1 ULIB 250 battery fitted on an adjustable harness
- 1 CB5010HV battery charger and power cord
- 1 holster to be fitted on the adjustable belt
- 1 adjustable belt
- 1 armband
- 1 cord (ref.130735)
- 1 sharpening stone
- 1 grease gun
- 1 tube of grease
- 1 tool operating instructions manual
- 1 battery 250 operating instructions manual
- 13 mm angled wrench

4.3. FITTING OF THE BATTERY ON THE HARNESS (ULIB 250 BATTERY)

See the harness assembly instructions.

Important

After mounting, the battery must be solidly attached and secured on your harness. If this is not the case then the mounting needs to be checked.

4.4. FITTING THE HOLSTER TO THE BELT

See the operating instructions for the battery.

4.5. CONNECTING THE TOOL TO THE ULIB 150 AND 250 BATTERIES

1. Putting the battery into service.
See the operating instructions for the battery.
2. Before connecting the tool, make sure the battery is switched off.
See the operating instructions for the battery.
3. Align the tool power alignment marker (2) with the notch in the battery power connector (1).
4. Connect the battery power cord (3) to the tool.
5. Tighten the tightening ring (4).

Important

Risk of false contact and tool stoppage if the tightening ring is not fully tightened.

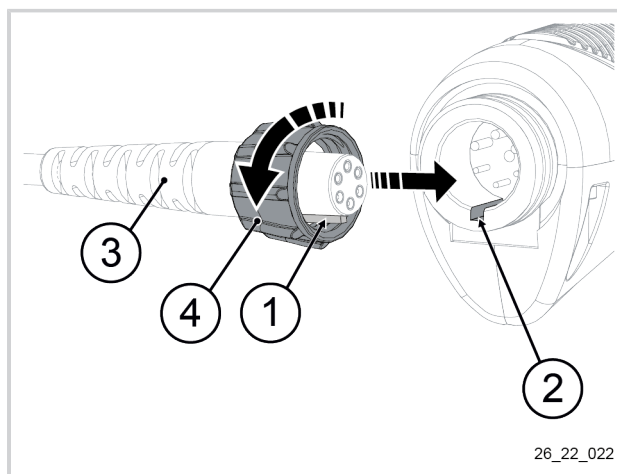

4.6. DISCONNECTING THE TOOL FROM THE ULIB 150 AND 250 BATTERIES

1. Before disconnecting the tool, make sure the battery is switched off.
See the operating instructions for the battery.
2. Loosen the tightening ring (1) on the tool's power cord (2).
3. Disconnect the power cord (2) from the tool.

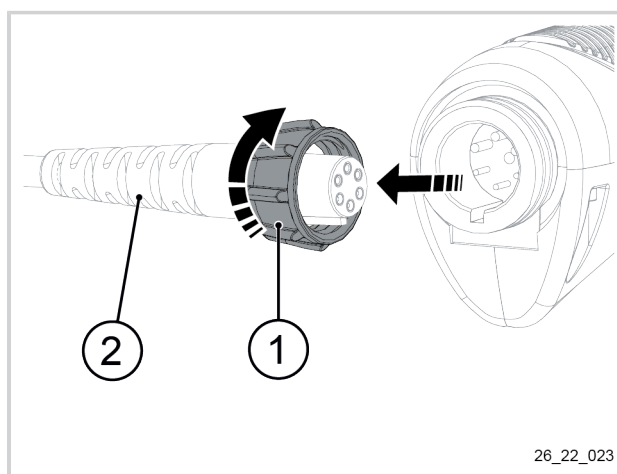

4.7. PUTTING THE LEAD AND ARMBAND IN PLACE

See the operating instructions for the battery.

Note

You must take all necessary care to prevent catching the lead of the pruning shears in the branches. To do this, attach the cord to the arm using the cuff provided (see battery operating instructions).

5. USING THE TOOL

5.1. SWITCHING THE BATTERY ON AND OFF

See the operating instructions for the battery.

5.2. ACTIV' SECURITY TOOL ACTIVATED

Activ' Security only works when the user is wearing conductive gloves PELENC or when they are working without gloves.

If the user is wearing other types of gloves, the tool will only start if the Activ' Security has been deactivated beforehand.

See 5.3. Activ'Security deactivated, page 18.

For more information on Activ' Security, see 3.3. Presentation of Activ' Security, page 14.

1. Turn on the battery.
See the operating instructions for the battery.

The battery beeps twice.

The Activ' Security LED (1) flashes red while waiting for information on the calibration of the tool according to its user.

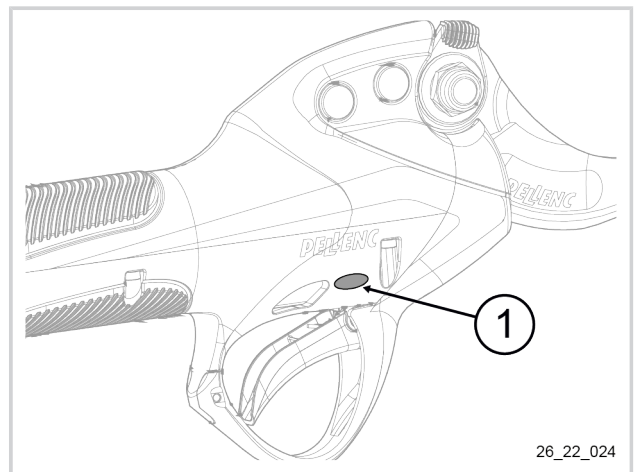

26_22_024

2. Take the tool in your hand, making sure your fingers are in contact with the lower conductive pad (2).
3. Place the index finger of the hand holding the tool on the trigger (3).
4. Grip on both sides of the blade pin (4) with the other hand.

The Activ' Security LED turns solid red when the tool has saved the user-related calibration parameters.

5. Release the blade pin (4).

The Activ' Security LED turns blue.

The tool emits a beep.

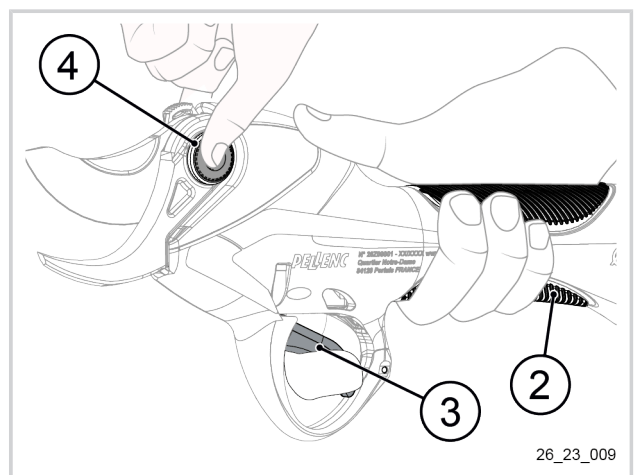

26_23_009

6. Press the trigger with your index finger to operate the tool.

Note

For the tool to work, the user of the tool must not touch the cutting head and be in contact with the conductive pad simultaneously.

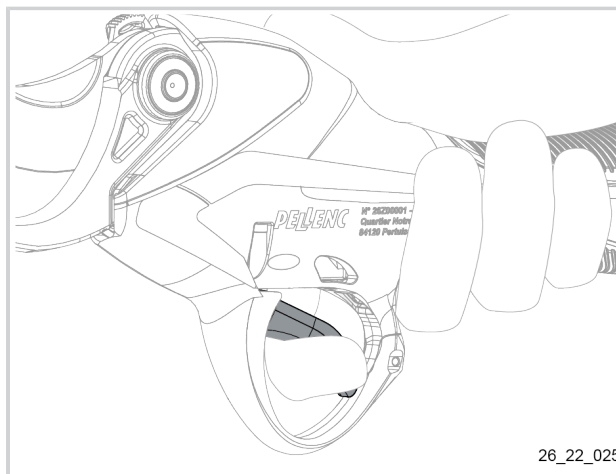

26_22_025

5.3. ACTIV'SECURITY DEACTIVATED



Warning

The user is strongly advised not to deactivate the Activ' Security. Deactivating this safety system exposes the user to the risk of serious and deep cuts.

The user is responsible for any accident that occurs as a result of the deactivation of the Activ' Security feature.

The deactivation of this safety system is recorded in the battery's black box.

5.3.1. DEACTIVATE ACTIV' SECURITY

Important

Carry out this operation without gloves. Do not wear gloves.

1. Switch on the battery.
See the operating instructions for the battery.

The battery beeps twice.

Note

The user's finger should not be placed on the optical sensor when the battery is switched on.

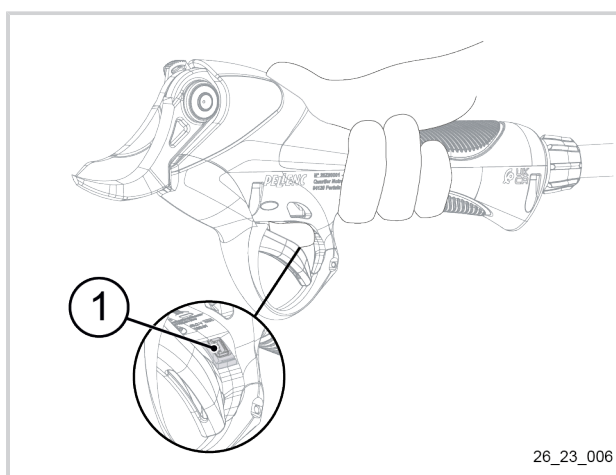

26_23_006

Within 10 seconds of starting the tool:

2. Take the tool into your hand.
3. Place the index finger in front of the optical sensor (1) **for 1 second**.
4. Press the trigger (2) in fully.
5. Release the trigger (2).
6. Place the index finger in front of the optical sensor (1) **for 1 second**.

The tool will emit an alarm sound and the "Mode" LED (3) will turn red to indicate that the Activ' Security is deactivated.

Note

When the Activ' Security is deactivated, the tool emits an alarm sound each time it is switched on and off.

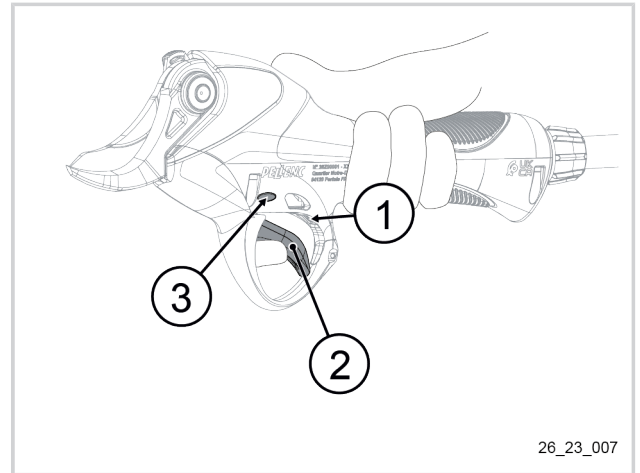

26_23_007

5.3.2. STARTING THE TOOL WITH ACTIV' SECURITY DEACTIVATED

1. Turn on the battery.
See the operating instructions for the battery.

The battery beeps twice.

The Activ' Security LED (1) flashes red.

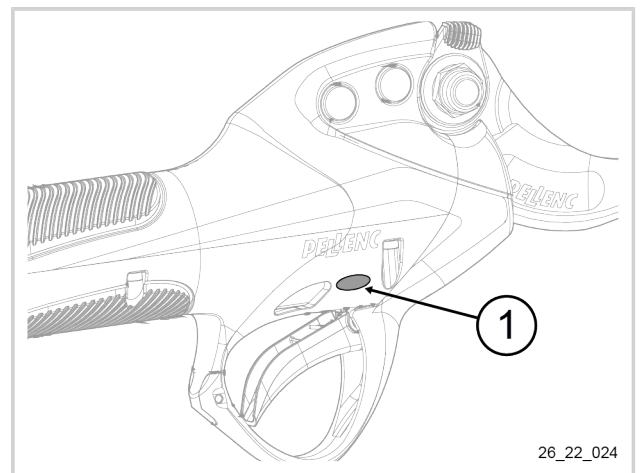

26_22_024

2. Take the tool into your hand.
3. Press the trigger (2) with the index finger of the hand holding the tool.

The tool emits three alarm beeps to warn that the Activ' Security feature is not activated.

The blade opens.

The tool is ready for use.

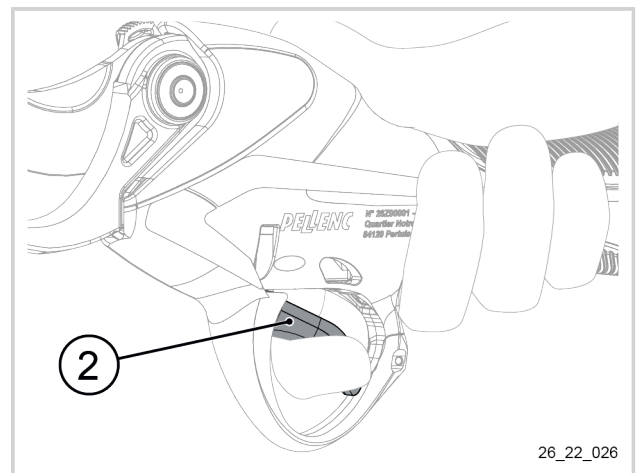

26_22_026

5.3.3. ACTIVATION OF ACTIV' SECURITY



Warning

Activ' Security is based on electrical conduction and is only optimal with the use of PELLENC Activ' Security gloves.

When working in wet conditions, wearing gloves PELLENC increases safety effectiveness.

If you put on gloves that you did not have at the beginning of the day or you replace your conductive gloves during the day, make sure they are compatible with the Activ' Security by restarting the tool and activating the safety system.



Warning

The safety system only protects the user holding the tool, any other persons is not protected.

Activ' Security and gloves PELLENC reduce the risk of cuts **but this risk is still present**. Always be careful when using pruning shears.

Important

Carry out this operation without gloves. Do not wear gloves.

1. Switch on the battery.
See the operating instructions for the battery.
The battery beeps twice.

Note

The user's finger should not be placed on the optical sensor when the battery is switched on.

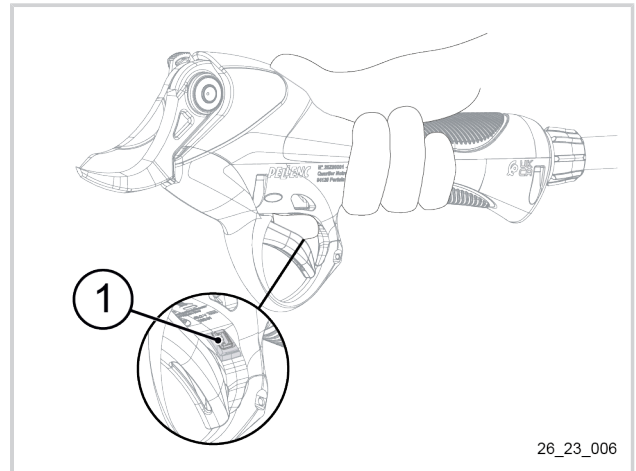

Within 10 seconds of starting the tool:

2. Take the tool into your hand.
3. Place the index finger in front of the optical sensor (1) **for 1 second**.
4. Press the trigger (2) in fully.
5. Release the trigger (2).
6. Place the index finger in front of the optical sensor (1) **for 1 second**.
The tool will emit an audible warning to confirm the activation of the Activ' Security.
7. Check that Activ' Security is operating, see 6.3.1. Checking the operation of the Activ' Security and the conductivity of the gloves, page 30.

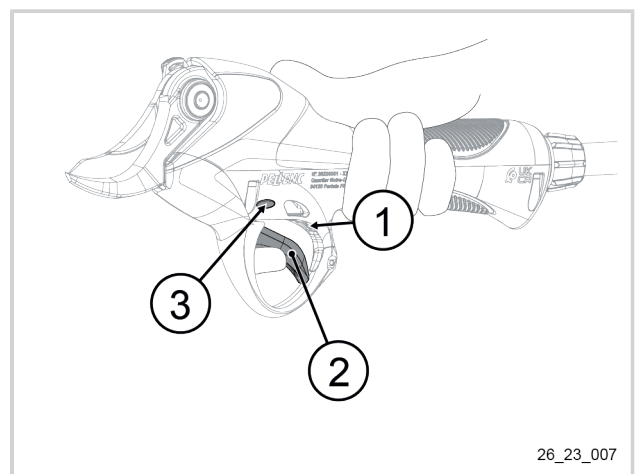

Important

He safeties have their limits. The user of the tool will need to be vigilant to ensure that the tool works properly.

5.4. BLADE OPENINGS

5.4.1. FULL OPENING OF THE BLADE

1. Turn on the battery
See the operating instructions for the battery.

The battery beeps twice.

The Activ' Security LED (1) flashes red.

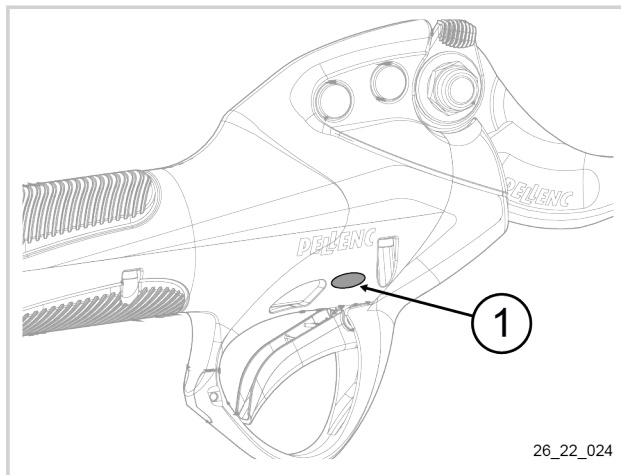

2. Take the tool into your hand.
3. **If Activ' Security is activated:**
 - Make sure that your fingers are in contact with the lower conductive pad (2) and simultaneously
 - Touch the blade shaft (4) with your other hand.
4. Press the trigger (3) with the index finger of the hand holding the tool.

The blade opens.

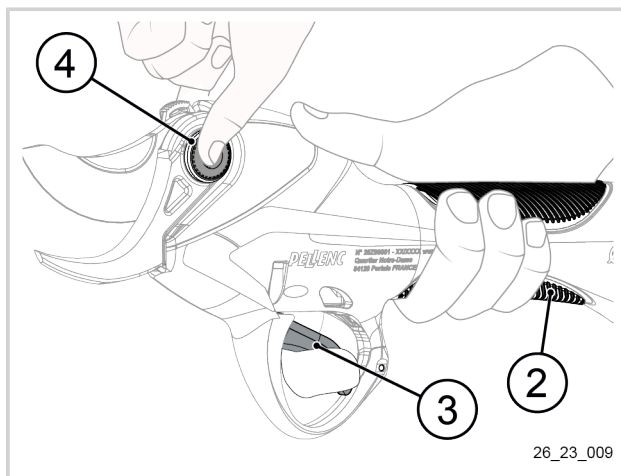

5.4.2. OPTICAL SENSOR AND HALF-OPENING

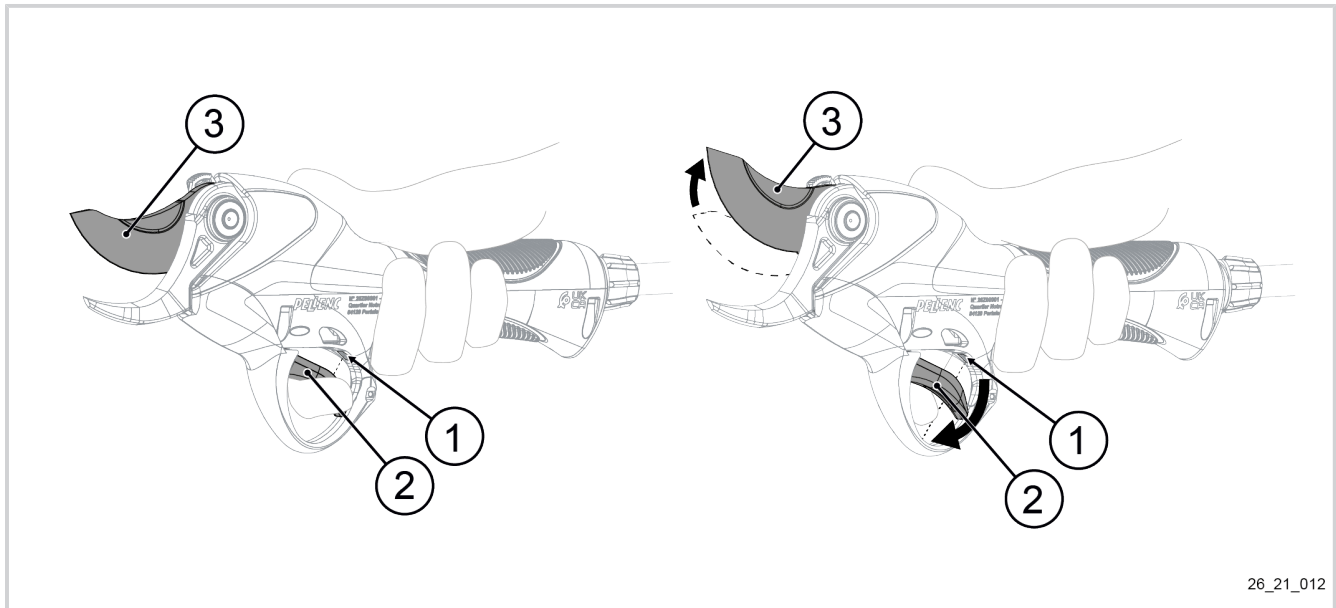

26_21_012

The blade (3) remains in half-open position as long as the optical sensor (1) detects that the user's finger is in front of the trigger (2).

When the finger moves away from the trigger (2), the optical system controls the full opening of the blade (3) (modes C1 + C3).

For more information on setting the sensitivity of the optical sensor, see 5.6.3. "Functional" setting modes, page 27

Note

Depending on the gloves used, these may have an impact on the operation of the optical sensor. We recommend not wearing black gloves.

Important

If the optical sensor is no longer functioning properly, check that nothing is blocking the trigger slot, or clean the optical sensor window with cleaning alcohol.

5.5. SWITCHING TO AND FROM STANDBY

5.5.1. AUTOMATIC STANDBY MODE

The tool can be put to standby when the F8 mode is set between 1 and 8. See 5.6.3. "Functional" setting modes, page 27.

If no action is taken on the pruning shears or the battery for 2 minutes, the tool automatically switches to standby.

Note

A beep from the battery indicates that the tool is in standby mode.

5.5.2. MANUAL STANDBY MODE

1. Press the trigger (1) fully in for a few seconds (long press) until the blade closes.
The battery beeps and the LED MODE (2) flashes.
2. Release the trigger (1).
The blade remains closed.

Note

To adjust the time the trigger is held down for the tool to go into standby, see 5.6.3. "Functional" setting modes, page 27.

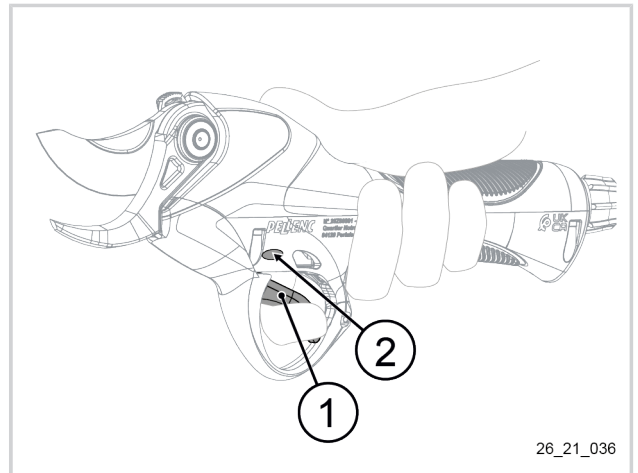

26_21_036

5.5.3. STANDBY EXIT

1. Press the trigger (1) in fully.
2. Release the trigger (1).

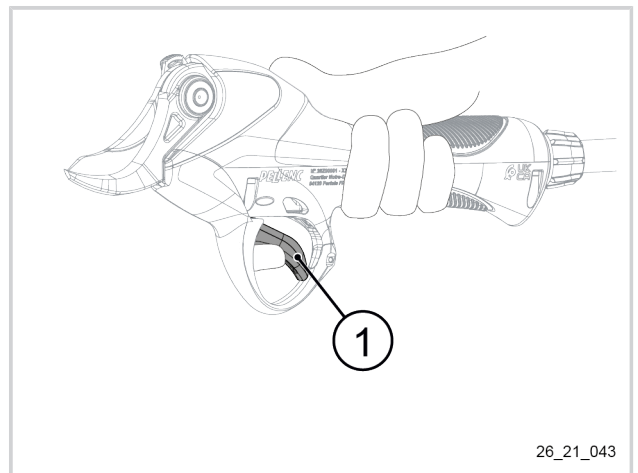

26_21_043

5.6. HMI (HUMAN MACHINE INTERFACE) SETTINGS OF THE TOOL

The Human Machine Interface (HMI) is an interface that links the user to the control system of a tool or machine. The operator is then able to interact with the tool or machine.

5.6.1. USAGE MODES

5.6.1.1. PRESENTATION OF USAGE MODES

Different operating modes are available to best suit the user's working habits (indicated on the display). The tool offers 4 operating modes, depending on the operator's working preferences.

5.6.1.1.1. PROGRESSIVE (INCREMENTAL) MODES

Mode C1: PROGRESSIVE WITH HALF-OPENING

- Progressive operation with half-opening.
- The user controls the opening of the blades by pressing the trigger.

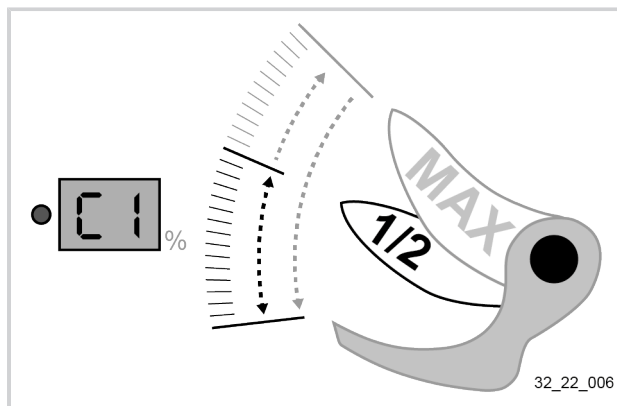

Mode C2: RAMP-UP (factory mode)

- When leaving the factory, the pruning shears are set in "progressive" mode without half-opening.
- The user controls the opening of the blades by pressing the trigger.

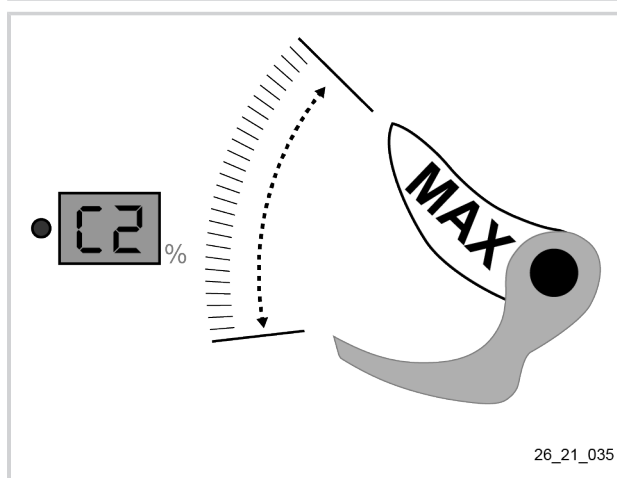

5.6.1.1.2. ALL-OR-NOTHING MODES

Mode C3: ON/Off HALF-OPENING

- Fast, "On/Off" operation, with half-opening.
- The blades are opened with a single pull of the trigger.

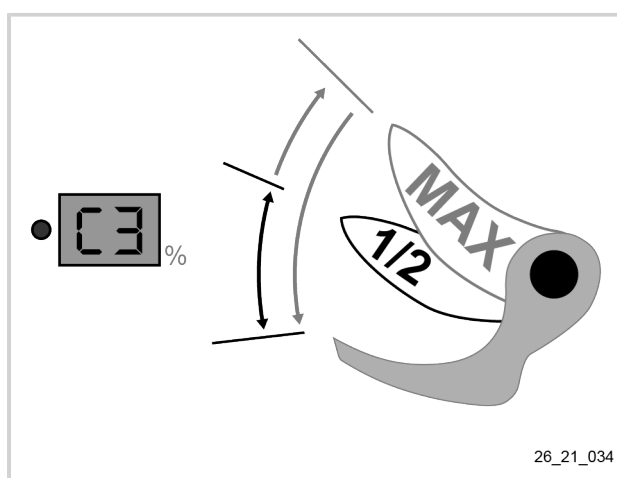

Mode C4: ALL OR NOTHING

- All-or-nothing operation without half-opening.
- The blades are opened with a single pull of the trigger.

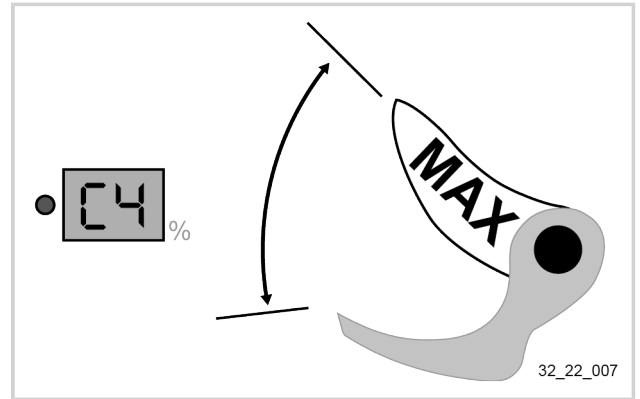

5.6.1.2. CHANGING USAGE MODE

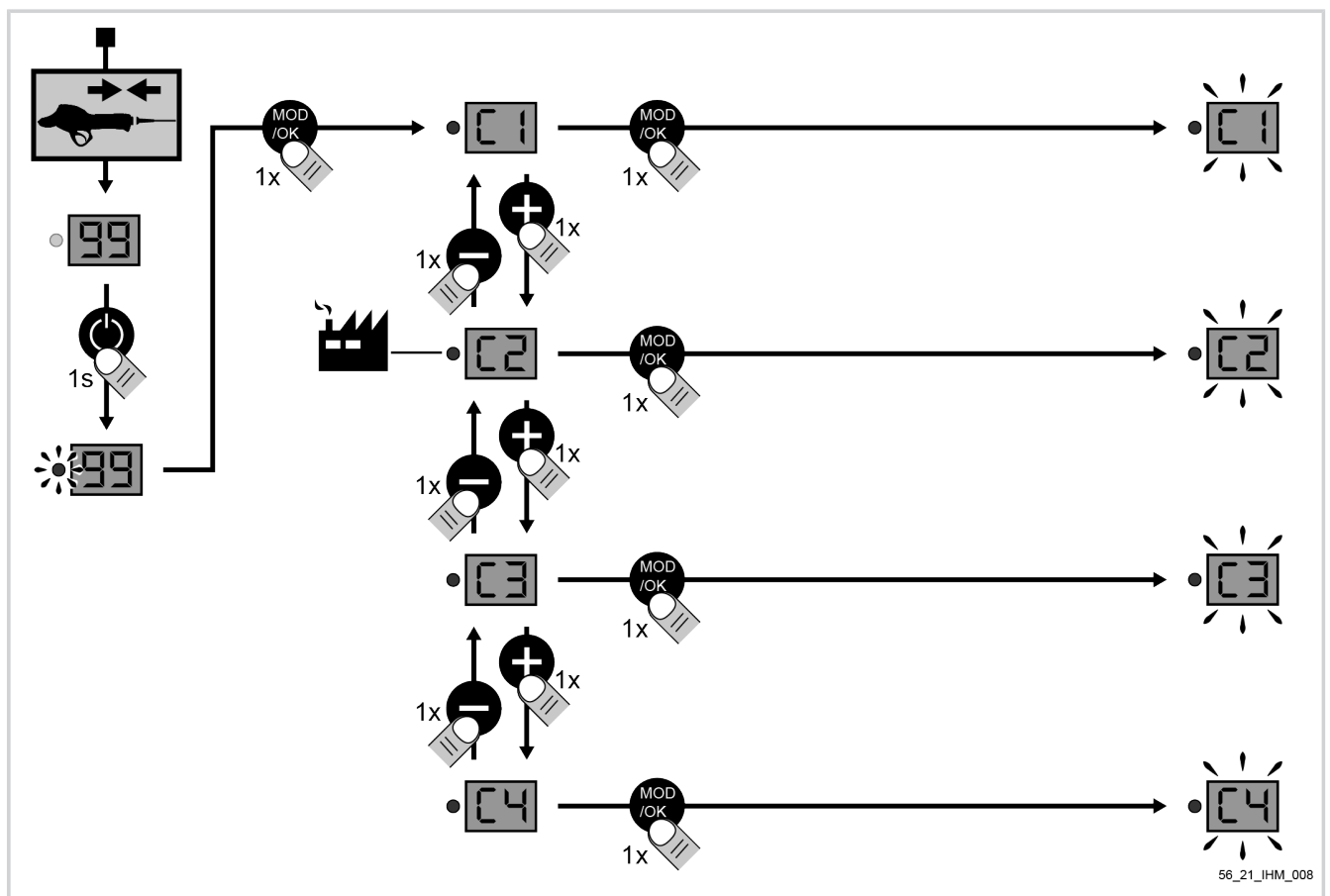

1. Connect the tool to the battery.
See 4.5. Connecting the tool to the ULIB 150 and 250 batteries, page 16.
2. Turn on the battery.
See the operating instructions for the battery.
3. Press the "mode" button on the battery.
4. Select modes C1, C2, C3 or C4 by pressing "+" or "-",
5. Press the "mode" button to validate.

5.6.2. AUTHORISATION MODES

5.6.2.1. PRESENTATION OF AUTHORISATION MODES

It is possible to set the tool's setting level according to the tool's operating modes.

See 5.6.1. Usage modes, page 23.

- L1: "Normal" mode: the user has access to the 4 operating modes C1 to C4 but without any adjustment possible.
- L2: Expert" mode: the user has access to the 4 operating modes C1 to C4 and the four settings F5 to F8 (factory setting ).

To change the authorisation settings of the tool, see 5.6.2.3. Change of authorisation mode, page 26.

5.6.2.2. COMPATIBILITY BETWEEN AUTHORISATION MODES AND TOOL SETTINGS

Pruning shears C35	Setting mode	
Pruning shears modes	L1	L2
C1: Progressive half-opening	✓	✓
C2: Progressive	✓	✓
C3: On/Off half-opening	✓	✓
C4: On/Off	✓	✓
F5: Blade crossing setting	✗	✓
F6: Adjusting the half-opening	✗	✓
F7: Adjusting optical sensor sensitivity	✗	✓
F8: Tool standby delay setting	✗	✓

5.6.2.3. CHANGE OF AUTHORISATION MODE

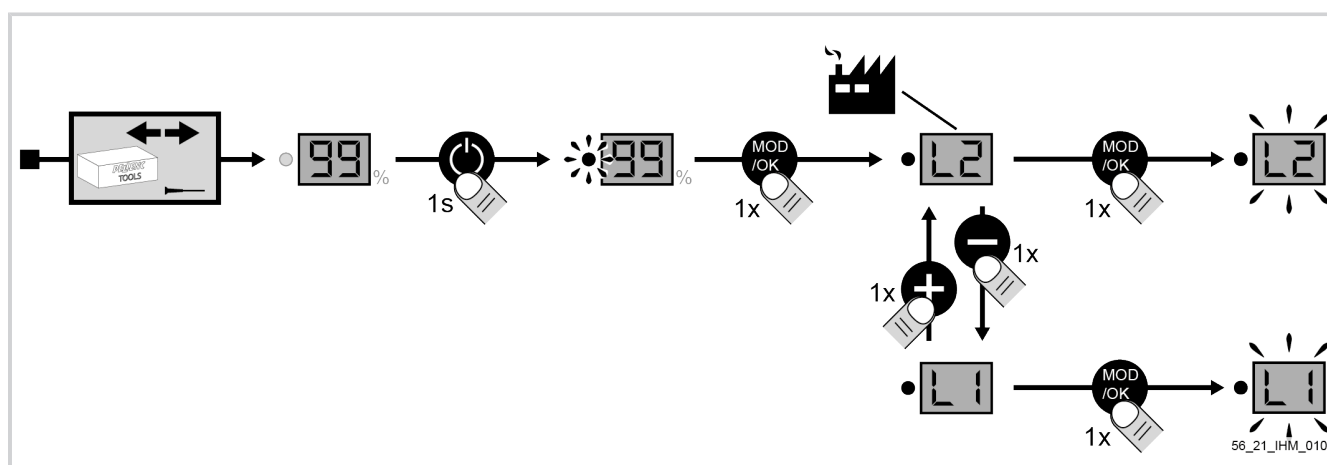

1. Disconnect the tool from the battery.
See 4.6. Disconnecting the tool from the ULIB 150 and 250 batteries, page 16.
2. Switch on the battery.
See the operating instructions for the battery.
3. Press the "mode" button on the battery,
4. Select the mode by pressing + or -,
5. Press the "mode" button to validate.
6. Switch off the battery.

See the operating instructions for the battery.

7. Connect the tool to the battery.

See 4.5. Connecting the tool to the ULIB 150 and 250 batteries, page 16.

5.6.3. "FUNCTIONAL" SETTING MODES

5.6.3.1. PRESENTATION OF THE "FUNCTIONAL" SETTING MODES

The user has the possibility to act on 4 so-called "functional" settings:

- Blade crossing.
See 6.8. Checking the crossing over of the hook and the blade, page 34.
- Half-opening of the blade,
- Sensitivity of the optical sensor,
- Tool into standby delay.

Functional modes	Description	Adjusting the setting
F5: Blade crossing setting	Adjust the blade crossing.	1 - 9: Low crossing - high crossing
F6: Half-open setting	Adjust the blade half-opening.	1 - 9: Narrow opening - wide opening
F7: Adjusting optical sensor sensitivity	Adjust the sensitivity of the blade's optical sensor.	1 - 9: Very sensitive - not very sensitive
F8: Tool standby delay setting	Adjust the amount of time the trigger is held down before the tool goes to standby.	1 - 8: Minimum time limit - maximum time limit
		9: No standby mode

To modify the "functional" settings of the tool, see 5.6.3.2. Change of "functional" settings mode, page 28.

5.6.3.2. CHANGE OF "FUNCTIONAL" SETTINGS MODE

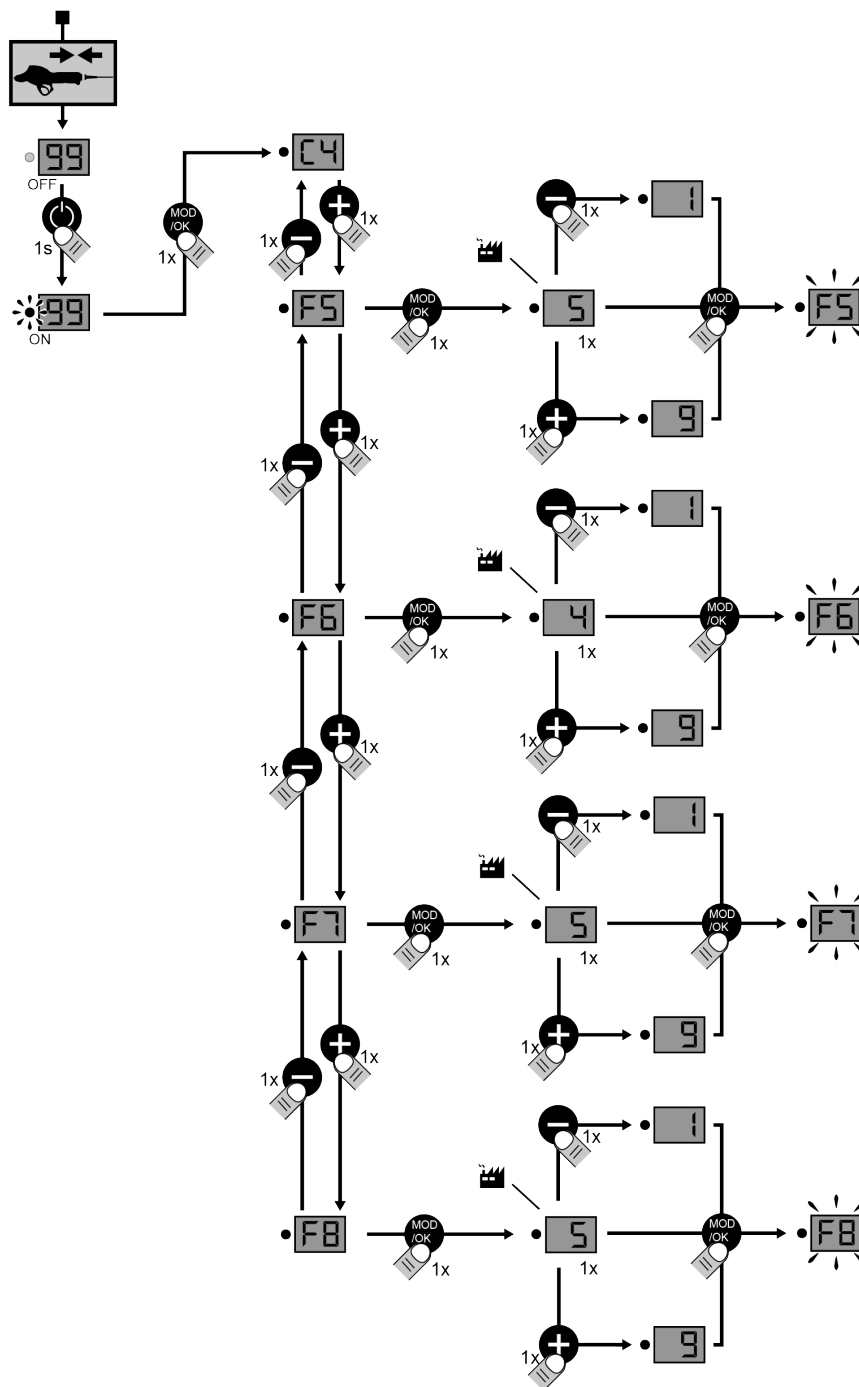

56_21_IHM_009

1. Connect the tool to the battery.
See 4.5. Connecting the tool to the ULIB 150 and 250 batteries, page 16.
2. Turn on the battery.
See the operating instructions for the battery.
3. On the battery, select the mode by pressing "+" or "-",
4. Press the "mode" button to validate.
5. Press "+" or "-" to adjust the setting from 1 to 9, see 5.6.3.1. Presentation of the "functional" setting modes, page 27.
6. Press the "mode" button to validate.

6. MAINTENANCE



Caution

- All maintenance operations must be carried out with the battery switched off and the tool power cord disconnected from the battery, unless otherwise specified in the procedure.
- Use products recommended by PELLENC.
- In the event of any problem, consult an authorised PELLENC dealer.

6.1. SERVICING FREQUENCY

Maintenance schedule

Operations	Servicing frequency			
	At each start-up ¹	Every 4 hours	Every week	After use
Visually check the general condition of the tool. See 6.3.2. Visual check of the general condition of the tool, page 31.	X			
Check the operating trigger. See 6.3.3. Checking the operating trigger, page 31.	X			
Check the sharpness of the blade. See 6.4. Sharpening the blade, page 32.				X
Check the tightness of the blade. See ???.	X			
Check the crossing over of the hook and the blade. See 6.8. Checking the crossing over of the hook and the blade, page 34.	X			
Check the tightness of the tool power cord. See 4.5. Connecting the tool to the ULIB 150 and 250 batteries, page 16	X			
Clean the tool (blowing or brushing, not high pressure jet cleaning). See 6.7. Cleaning the tool, page 33.				X
Grease the blade. See 6.6. Greasing the blade, page 33.			X	
Check the functioning of the Activ' Security. see 6.3.1. Checking the operation of the Activ'Security and the conductivity of the gloves, page 30	X	X		
Check the condition of the gloves and their conductivity. see 6.3.1. Checking the operation of the Activ'Security and the conductivity of the gloves, page 30	X	X		
Check the battery charge level.	X			X
Have the tool checked by a PELLENC authorised dealer.	Important Have the machine serviced every 400 hours or at least once a year by a PELLENC authorised dealer. Always store the tool clean and in a dry place, with the battery charged.			

Operations	Servicing frequency			
	At each start-up ¹	Every 4 hours	Every week	After use
Changing the blade kit See 6.9. Changing blade or shaft, page 35.	EVERY 200 HOURS or as necessary to maintain a good quality cutting, replace the blade.			
Battery	Please refer to the battery operating instructions.			

6.2. MAINTENANCE ADVICE

If the cut is no longer clean and effortless, this means that the tool is consuming more energy than necessary. Check the following points:

1. blade sharpening,
2. the tightness of the blade,
3. greasing of the blade pin,
4. general condition of the tool.

The operating time and service life of the pruning shears mainly depend keeping the blade properly sharpened and tightened.

6.3. CHECK

6.3.1. CHECKING THE OPERATION OF THE ACTIV'SECURITY AND THE CONDUCTIVITY OF THE GLOVES

Each time the tool is switched on, the safety device is waiting to be initialised.



Warning

For the proper functioning of the safety system, it is imperative to use conductive gloves PELENC or no gloves.



Warning

Contact an authorised distributor PELENC in the event of a problem.

At the beginning of each day or change of user, it is necessary to ensure that the Activ' Security is working properly. Two methods of verification are possible:

Method No. 1:

1. Switch the tool on.
See the operating instructions for the battery.
2. Take the tool in your hand, making sure your fingers are in contact with the lower conductive pad (1).
The "Activ' Security" LED (3) is solid red.
3. Check the conductivity of each finger of the opposite hand by pressing them one by one against the trigger (2).
The "Activ' Security" LED (3) must be blue (fixed or flashing) each time a finger is fitted on the trigger.
4. Check the correct operation of the blade according to the position of the trigger (2).

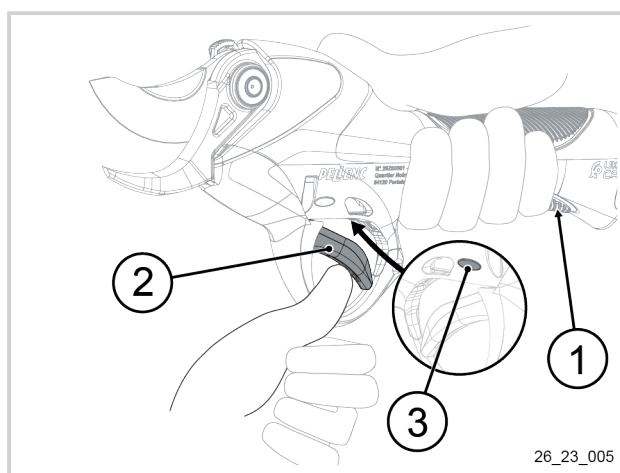

26_23_005

Method No. 2:

1. Switch the tool on.
See the operating instructions for the battery.
2. Take the tool in your hand, making sure your fingers are in contact with the lower conductive pad (1).
3. Place the index finger of the hand holding the tool on the trigger (2).
4. Apply pressure to the lower edge of the hook (3) with the opposite hand.
The "Activ' Security" LED (4) is solid red.
5. Remove the opposite hand from the hook (3).
The "Activ' Security" LED (4) must be blue.
6. Check the correct operation of the blade according to the position of the trigger (3).

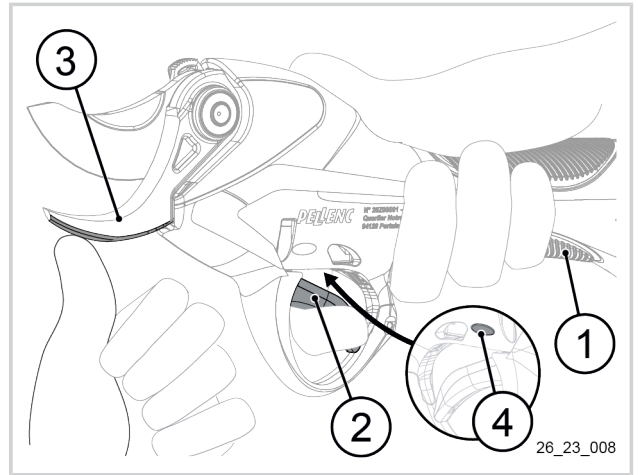

Note

When the blade is held in the open position and the battery emits a beep in the event of simultaneous contact with the two conductive surfaces, the Activ' Security is working. In case of malfunction, try to increase the contact area with the tool and wear/replace your conductive gloves.

6.3.2. VISUAL CHECK OF THE GENERAL CONDITION OF THE TOOL

- Visually check the general condition of the tool.

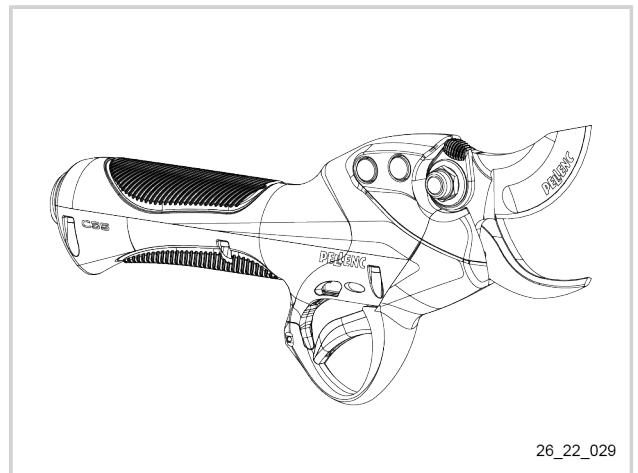

6.3.3. CHECKING THE OPERATING TRIGGER

1. Visually check the condition of the operating trigger.
2. Ensure that nothing physical (e.g. tape, collar, etc.) prevents or interferes with the operation of the operating trigger.
3. Ensure that the operating trigger is functioning properly by pressing it.

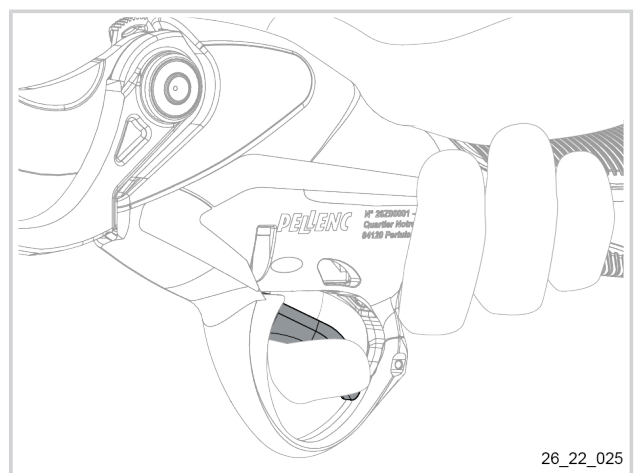

6.4. SHARPENING THE BLADE

This operation is essential because it determines the quality of the cut of the tool, guarantees the longevity of the blades and mechanical parts and preserves the autonomy of the battery.

The frequency of blade sharpening depends on:

- the wood being cut (hardness and diameter),
- the rate of pruning,
- the sharpening tool. A sharpening stone is supplied with your tool.

1. Open the tool blade fully
See 5.4. Blade openings, page 21.
2. Turn the battery off.
See the operating instructions for the battery.
3. Disconnect the tool from the battery.
See 4.6. Disconnecting the tool from the ULIB 150 and 250 batteries, page 16.
4. Pose the sharpening stone (1) onto the blade on the right-hand side of the tool.

Important

Incline the stone about 30° to match the edge of the blade perfectly.

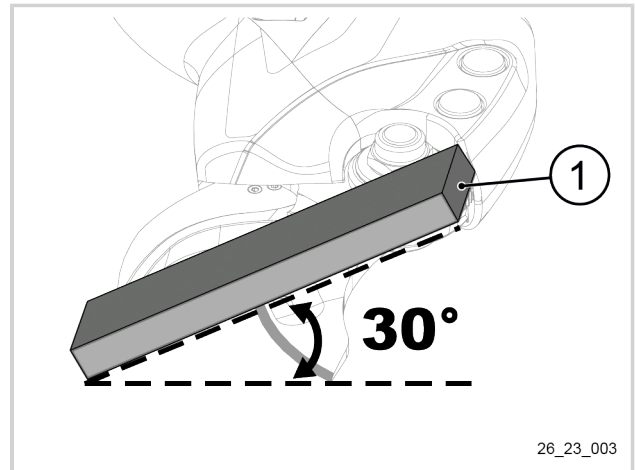

5. Refresh only the 1st cutting angle (2) from the inside to the outside until the burr is removed from the blade edge.

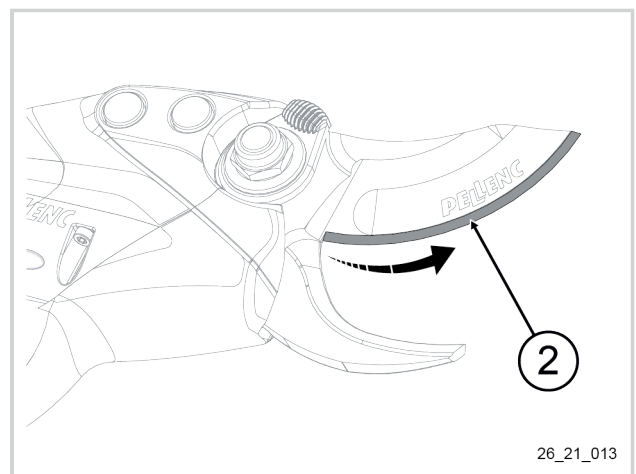

6. Turn the tool over.
7. Deburr the back of the blade (2) once, posing the sharpening stone flat from the inside out.

Important

It is imperative to remove the burr from the edge of the blade and to carry out the first refreshment within the first 15 minutes of use, then every 1 or 2 days maximum.

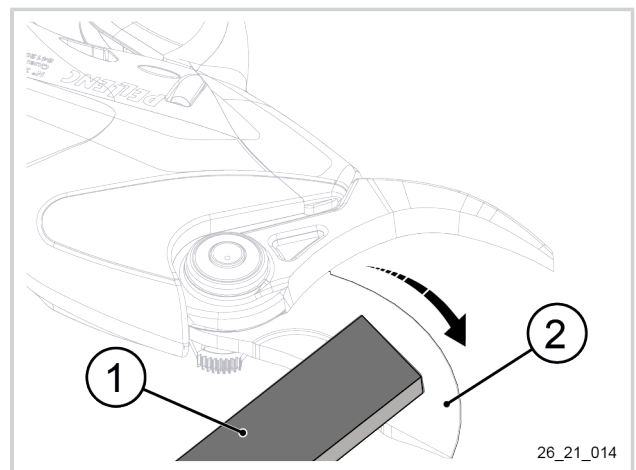

6.5. CHECK THE TIGHTNESS OF THE BLADE

For optimum cutting quality, regularly check the blade's tightness:

- 1.
2. Switch off the tool.
See 5.1. Switching the battery on and off, page 17.
3. Disconnect the battery from the tool.
See 4.6. Disconnecting the tool from the ULIB 150 and 250 batteries, page 16.
4. Tighten the nut (1) with the supplied spanner (2) until the knurled lock washer (3) turns with difficulty.

Note

Excessive tightening can cause the tool to overheat, resulting in high battery consumption and a significant reduction in battery life.

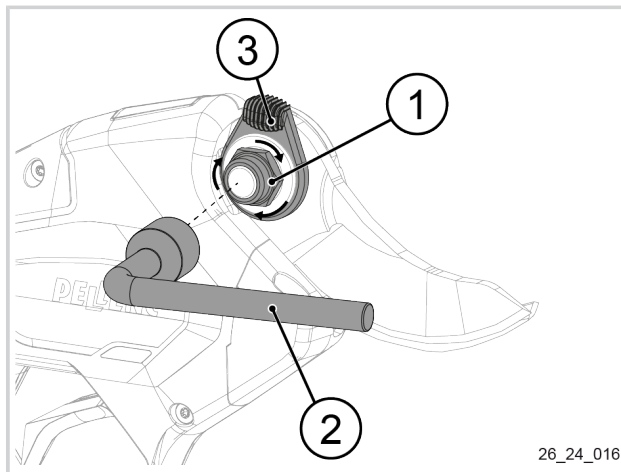

6.6. GREASING THE BLADE

1. Bring the supplied grease gun (2) into contact with the tool's blade pin (1) by pressing once until the grease appears between the blade (3) and the hook (4).
2. Remove the grease gun (2).

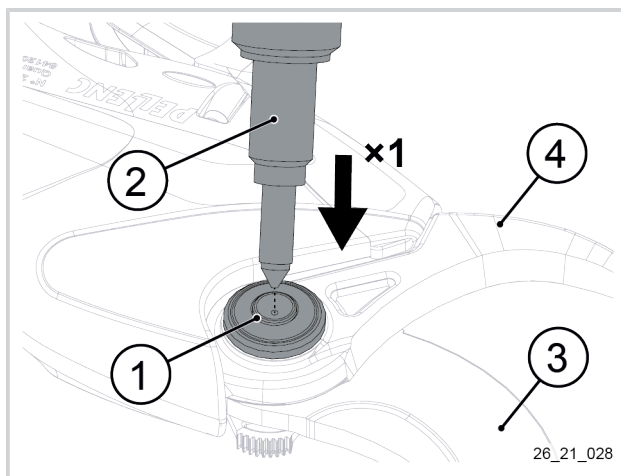

6.7. CLEANING THE TOOL

Avoid the formation of abrasive paste (oil + soil) as much as possible by frequent cleaning. To do so:

- Clean the front of the tool with a cloth and compressed air, avoid solvents such as: trichloroethylene, white spirit, petrol, etc.
- Grease the blade and blade pins lightly but often with the grease gun supplied, see 6.6. Greasing the blade, page 33.

6.8. CHECKING THE CROSSING OVER OF THE HOOK AND THE BLADE

1. Ensure that in the closed position the tip of the blade is in the lower third of the hook.
2. Adjust the crossing if necessary, see 5.6.3. "Functional" setting modes, page 27.

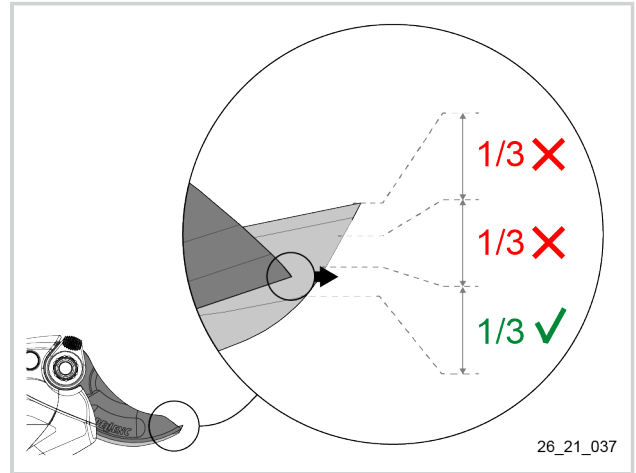

6.9. CHANGING BLADE OR SHAFT

6.9.1. REMOVAL OF THE BLADE AND ITS PIN

1. Open the blade fully.
See 5.4. Blade openings, page 21.
2. Turn the battery off.
See the operating instructions for the battery.
3. Disconnect the tool from the battery.
See 4.6. Disconnecting the tool from the ULIB 150 and 250 batteries, page 16.

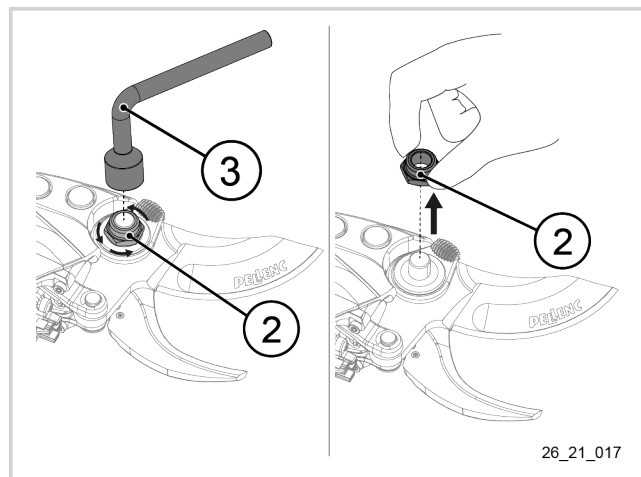
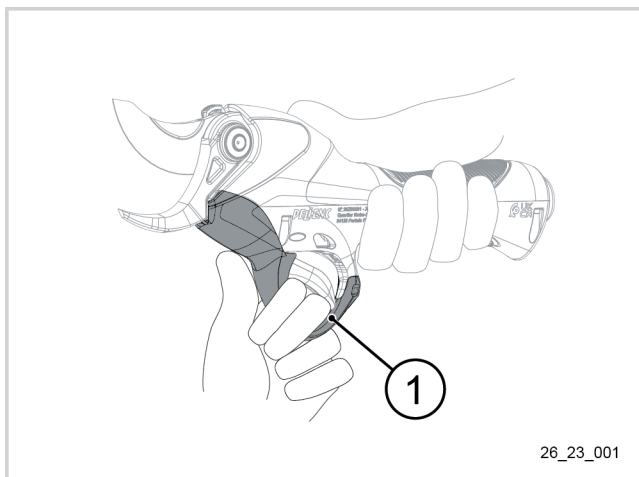

4. Open the guard (1).

5. Loosen the nut (2) with the key provided (3).
6. Remove the nut (2).

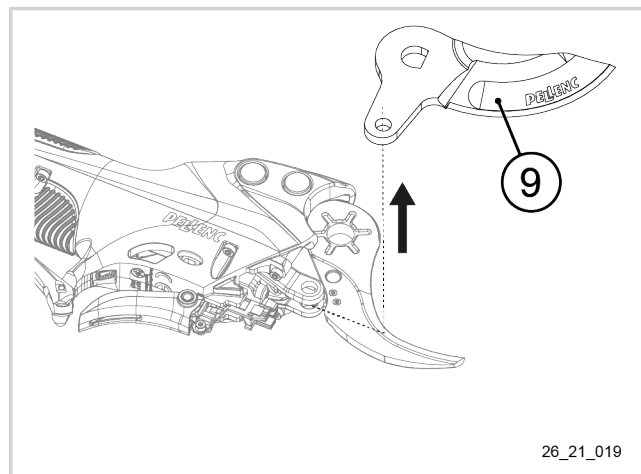
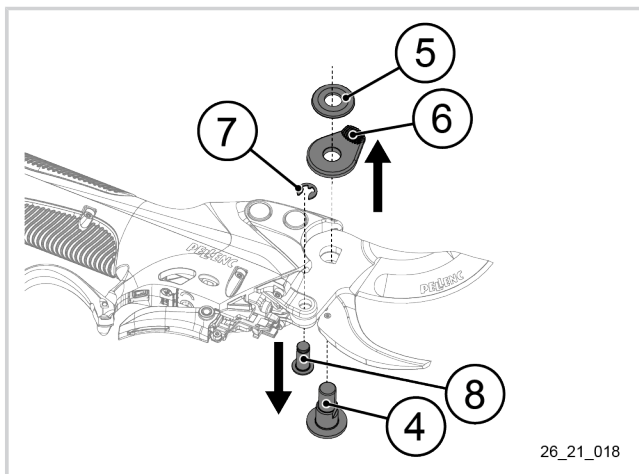

7. Remove the parts in this order:
 - The blade pin (4),
 - The washer (5),
 - The knurled adjustment washer (6),
 - The circlip (7) by levering with a small screwdriver,
 - the clevis pin (8).

8. Remove the blade (9) and dispose of it.

Note

To reinstall the blade and pins, see 6.9.2. Fitting of the blade and its pins, page 36.

6.9.2. FITTING OF THE BLADE AND ITS PINS

Note

To remove the blade, the pins and change the worn parts, see 6.9.1. Removal of the blade and its pin, page 35.

Before fitting the blade and tool pins:

1. Ensure that the battery is switched off.
See the operating instructions for the battery.
2. Make sure the tool is disconnected from the battery.
See 4.6. Disconnecting the tool from the ULIB 150 and 250 batteries, page 16.

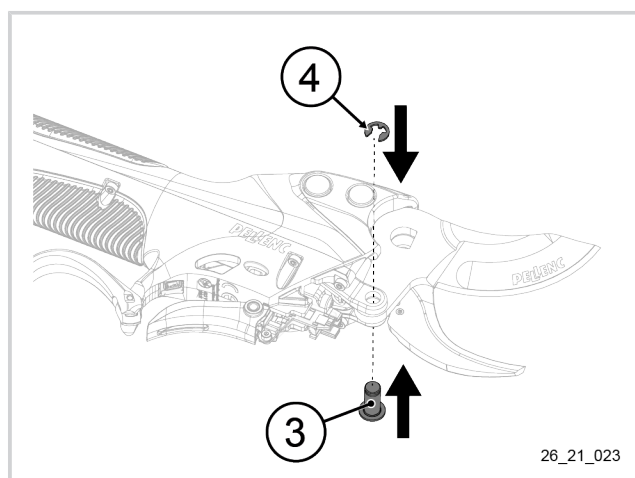
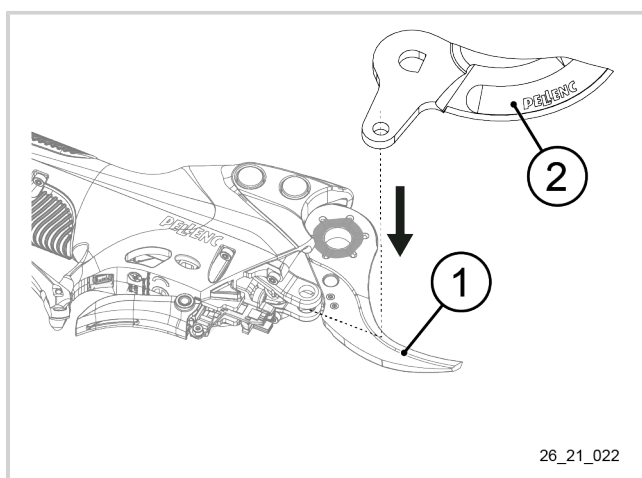

3. Grease the surface of the hook (1) in contact with the blade (2) with the tube of grease supplied.
4. Fit the blade (2) on the hook (1).
5. Grease the clevis pin (3) with the supplied tube of grease.
6. Install the clevis pin (3) on the tool link.
7. Fit a new circlip (4) with the sharp edge facing outwards onto the clevis pin (3).

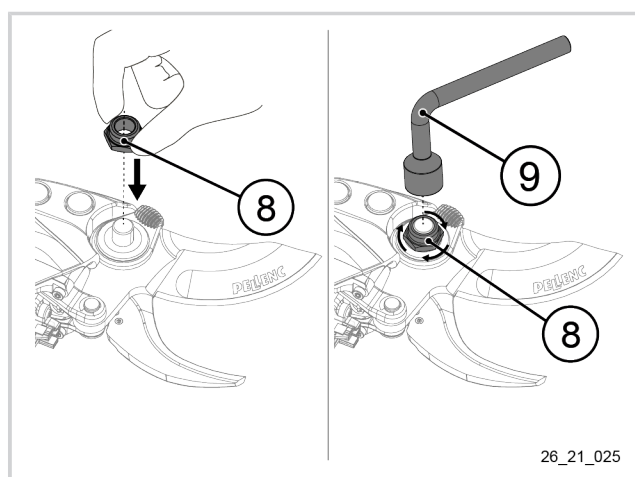
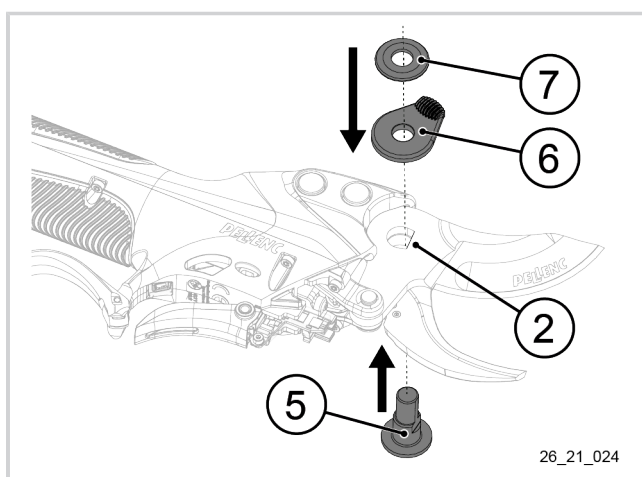

8. Align the flat on the blade pin (5) with the alignment marker on the blade (2).
9. Fit the blade pin (5).
10. Replace the knurled locking washer (6),
11. then the washer (7).
12. Fit the nut (8) on the blade pin.
13. Tighten the nut (8) using the spanner provided (9).
See ???.

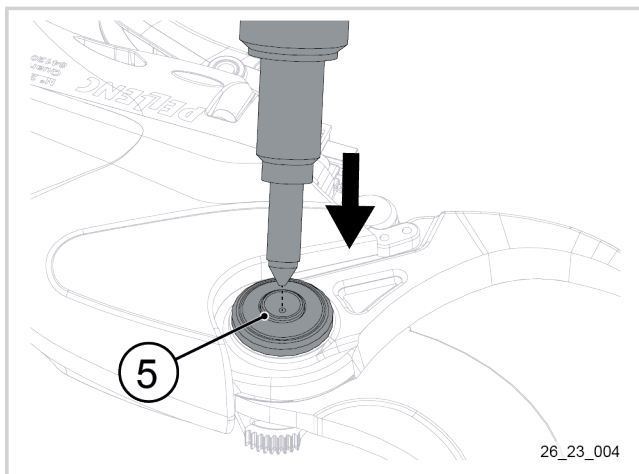

14. Grease the blade pin (5).
See 6.6. Greasing the blade, page 33.

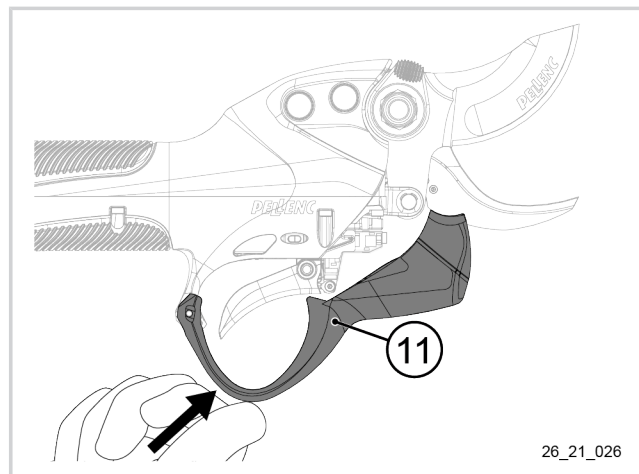

15. Clip the guard (11) back in place by pressing in the centre.

7. INCIDENTS AND TROUBLESHOOTING

7.1. TABLE OF INCIDENTS AND BREAKDOWNS



Caution

Never attempt to open or repair the battery pack or the charger

Problem	Probable cause	Check	Possible action
The tool does not start	Battery off	Check that the battery is switched on.	Switch on the battery.
	Battery discharged	Check that the battery is not completely discharged.	Recharge the battery.
	Problem related to the activation/deactivation of Activ' Security and the presence or absence of gloves PELLENC.	Check the Activ' Security activation and/or the Activ' Security power-up procedure.	See 6.3.1. Checking the operation of the Activ' Security and the conductivity of the gloves, page 30.
	Poor connection between tool and battery	Check that the tool is connected to the battery.	See 4.5. Connecting the tool to the ULIB 150 and 250 batteries, page 16.
	The power cord is cut or faulty	Check the condition of the power cord.	Change the power cord. PELLENC authorised dealer.
The tool makes an unusual noise	Internal breakage	PELLENC authorised dealer	PELLENC authorised dealer.
The tool stops during use	The machine has reached its temperature limit	Abnormally high tool temperature.	Check that the tool is being used under the recommended conditions. See 2. Safety, page 7.
	Internal breakage	PELLENC authorised dealer	PELLENC authorised dealer.
	Stop and restart the battery, if the tool still does not start, see the "tool does not start" section of this table.		
Loss of efficiency and/or cutting quality of the tool	Ineffectiveness of the blade	Check the sharpness of the blade, the tightness of the blade, the greasing of the blade and the crossing of the blade and hook.	See 6. Maintenance, page 29.
	The cutting diameter does not correspond to the maximum capacity of the pruning shears		Cut only branches that are suitable for your tool.
	Battery partly discharged	Check that the battery is sufficiently charged.	Recharge the battery.
Power loss + Battery LED flashing	Repetition of 3 XL cuts, the battery limits the power for 30 seconds.		Do not perform an XL cut for 30 seconds.
The battery displays an error code	See the battery operating instructions		
The blade no longer opens in half-open position	Mode problem	Check that you are in a half-open mode	See 5.6.1.1. Presentation of usage modes, page 23.

Problem	Probable cause	Check	Possible action
	Optical sensor problem	Check the optical sensor window	See 5.4.2. Optical sensor and half-opening, page 22.
		Check the sensitivity setting of the optical sensor	
	Trigger problem	Check the trigger	See 6.3.3. Checking the operating trigger, page 31.

If the tool does not work, return the complete equipment in its original packaging to an authorised repairer PELLENC.

7.2. ACTIV' SECURITY LED CODES SUMMARY

Normal Codes	
Start-up	
Flashing red	• Waiting for initialization
Red and (light) blue fixed	• Activ' Security initialized: user detected on pad and hook
Slow flashing red	• Activ'Security deactivated
Use	
Steady blue	• No fault detected: user detected between pad and trigger
Flashing blue	• No fault and low Activ' Security threshold: user detected between pad and trigger
Slow flashing red and alarm sound	• Activ'Security deactivated
Degraded Mode codes	
Using the tool	
Rapid flashing red	• Poor connection between the hook and the trigger board
1 short beep every 3 seconds	• Guard open
Fault codes	
Start-up	
Flashing red and blue	• Waiting for initialization and user detected on the pad
Use	
Steady red	• User not detected on pad or trigger
Steady red and (light) blue	• Fault detected: user in contact with the hook and/or not detected on the pad
Steady red and flashing (light) blue	• Fault detected with Activ' Security threshold low: user in contact with the hook and/or not detected on the pad

8. STORAGE AND TRANSPORT

8.1. STORAGE

1. Switch off the tool.
See the operating instructions for the battery.
2. Disconnect the pruning shears from the battery.
See 4.6. Disconnecting the tool from the ULIB 150 and 250 batteries, page 16.
3. Clean the pruning shears.
See 6.7. Cleaning the tool, page 33.
4. Store the pruning shears in their carrying case away from heat, dust and moisture.
5. Storing the battery.
See the operating instructions for the battery.

Note

It is possible to have the pruning shears serviced by an authorised repairer out of season. For more information, consult an authorised dealer or contact PELLENC.

9. ACCESSORIES AND CONSUMABLES

9.1. ACCESSORIES INCLUDED

For a list of accessories included with the tool, see 4.1. Contents of the C35 case + ULIB 150 battery, page 15 and 4.2. Contents of the C35 case + ULIB 250 battery, page 15.

9.2. OPTIONAL ACCESSORIES

Name	Reference
Vinion Prunion 4m Power Cord 250 Battery	147073
NOTE: Only for 250 batteries	
Vinion Prunion 150 Battery 3m Power Cord	147072
NOTE: Only for 150 batteries	
Activ' Security Comfort Glove	164452
Activ' Security Vegetation Glove	164453

9.3. CONSUMABLES

Name	Reference
C35 blade kit	159025
C35 maintenance kit	159022
C35 feather blade kit	159029
Sharpening stone	02322
Tube of grease	170755

10. WARRANTIES

10.1. GENERAL WARRANTIES

10.1.1. STATUTORY WARRANTY

10.1.1.1. LATENT DEFECTS WARRANTY

Apart from the commercial warranty provided for under Article II, Article 1641 of the French Civil Code states that "the seller is bound to a warranty on account of latent defects of the object sold which render it unfit for the use for which it was intended, or which would impair said use to the extent that the buyer would not have acquired it, or would only have paid a lesser price for it, had he/she known of them".

Article 1648 of the Civil Code "The action resulting from latent defects must be brought by the purchaser within two years after the discovery of the defect.»

10.1.1.2. LEGAL GUARANTEE OF CONFORMITY

Article L.217-4 of the French Consumer Code "The seller delivers goods in compliance with the contract and is liable for defects of conformity existing upon delivery.

The seller is also liable for any lack of conformity resulting from the packaging, assembly or installation instructions whenever its contractual liability is engaged in this regard or the latter are carried out under its responsibility.

Article L.217-5 of the French Consumer Code "Goods are compliant with the contract":

1. If they are fit for the purpose normally expected of similar goods and, where applicable:
 - If they correspond to the description given by the seller and possess the qualities that were presented to the buyer in the form of a sample or model;
 - If they possess the qualities that a buyer can reasonably expect given the public statements made by the seller, the producer or its representative, especially in advertising or labelling;
2. Or if it has the characteristics defined by mutual agreement between the parties or be suitable for any special use sought by the buyer, brought to the attention of the seller and accepted by the latter.

Article L.217-12 of the French Consumer Code "legal action resulting from lack of conformity lapses two years after delivery of the goods".

The legal guarantee of conformity applies only to consumers, not to professional customers.

10.1.2. COMMERCIAL WARRANTY PELLENC

10.1.2.1. CONTENTS

10.1.2.1.1. GENERAL INFORMATION

In addition to the legal warranties, user customers benefit from the commercial warranty on products PELLENC covering the exchange and replacement of parts recognised as being out of order, due to machining defects, assembly defects or material defects, whatever the cause.

The warranty forms an inseparable whole with the product sold by PELLENC.

10.1.2.1.2. SPARE PARTS

The commercial warranty also covers original spare parts PELLENC, excluding labour and to the exclusion of certain spare parts of each product provided upon delivery.

10.1.2.2. DURATION OF WARRANTY

10.1.2.2.1. GENERAL INFORMATION

Products PELLENC connected to a battery are covered by the commercial warranty from the date of delivery to the user customer for a period of two (2) years PELLENC, associated robotic products are also covered PELLENC and other products are covered for one (1) year PELLENC.

10.1.2.2.2. SPARE PARTS

Spare parts PELLENC replaced under the product warranty are guaranteed under the commercial warranty from the delivery of the product PELLENC to the user customer for a period of two (2) years in the case of products connected to a battery PELLENC, and for a period of one (1) year in respect of other products PELLENC.

In the case of products connected to a battery PELLENC, spare parts that are replaced under the product warranty after the 12th month of use are covered for a period of one (1) year.

10.1.2.2.3. WARRANTY EXCLUSIONS

Products that have been subject to abnormal use, or that have been used under conditions and for purposes other than those for which they were manufactured, are excluded from the commercial warranty, especially in the case of non-compliance with the conditions stipulated in this user manual.

Nor does it apply in the event of impact, dropping, negligence, lack of supervision or maintenance or if the product has been transformed. Products that have been altered, transformed or modified by the user customer are also excluded from the warranty.

Wear parts and/or consumables are not covered by the warranty.

10.1.2.3. IMPLEMENTATION OF THE COMMERCIAL WARRANTY

10.1.2.3.1. PRODUCT COMMISSIONING AND COMMISSIONING DECLARATION

At the time of the sale, the DISTRIBUTOR and/or customer-user undertakes to **complete the online warranty activation form** in full on the Pellenc Service website.

The warranty must always be activated by the DISTRIBUTOR in order to demonstrate that it has fulfilled its information obligations towards the Customer. The DISTRIBUTOR may be held liable if the accident was caused by a failure to provide advice on its part.

Activating the warranty also activates the commercial warranty. Without this, PELLENC will not be able to honour any commercial warranty., and the DISTRIBUTOR must therefore bear the financial burden alone without being able to pass on the cost of its intervention under the warranty to the user customer.

10.1.3. PAID AFTER-SALES SERVICE

10.1.3.1. GENERAL INFORMATION

Malfunctions, breakdowns, breakages resulting from misuse, negligence or improper maintenance by the user customer, as well as malfunctions resulting from the normal wear of the product, are subject to the payment of the

after-sales service, even during the period of the legal and commercial warranty. After-sales service repairs that fall outside of the legal and commercial warranty also include maintenance, adjustments, diagnostics of all types, and cleaning, without the present list being exhaustive.

10.1.3.2. WEAR PARTS AND CONSUMABLES

Wear parts and consumables also fall within the after-sales service.

10.1.3.3. SPARE PARTS

The paid after-sales service also covers original spare parts PELLENC, excluding labour and outside the legal or commercial warranty period.

In case of replacement of original spare parts PELLENC in the context of the after-sales service, said latter are covered by a commercial warranty of one year as of the installation date.

10.2. SPECIFIC WARRANTIES

PELLENC guarantees its motor for a period of 2 years from the date of delivery.

PELLENC guarantees its battery for a period of 2 years from the date of delivery provided that:

- the number of charging cycles does not exceed 100 per year;
- the battery charge capacity did not exceed 50 kWh since commissioning;
- the battery is used at temperatures between -5° C and +35° C;
- The battery is charged at temperatures between +10° C and +25° C;
- The battery has not gone into deep discharge;
- Average consumption does not exceed 450 mA.



Warning

Never open the pruning shears or battery pack, as this may void the warranty. Contact your authorised repair person.

11. STATEMENTS OF COMPLIANCE

11.1. DECLARATION OF CONFORMITY: C35

MANUFACTURER / PERSON AUTHORISED TO COMPILE THE TECHNICAL FILE		PELENC	
ADDRESS		Quartier Notre-Dame - 84120 Pertuis (France)	
GENERIC DENOMINATION	Electric pruning shears		
FUNCTION	Intended for pruning		
COMMERCIAL NAME	C35		
TYPE	C35		
MODEL	C35		
SERIAL NO.	26Z00001 - 26Z49999	26A00001 - 26A49999	26B00001 - 26B49999

This declaration of conformity is issued under the sole responsibility of the manufacturer.

The object of the declaration described above complies with the relevant Union harmonisation legislation:

- Directive 2006/42/EC
 - EN 62841-1:2015 + A11:2022
- Directive 2014/30/EU
 - EN IEC 55014-1:2021
 - EN IEC 55014-2:2021
- Directive 2011/65/EU
- Directive 2012/19/EU
- Regulation (REACH) No 1907/2006

Signed for and on behalf of:

Pascal MOULINIER
 Group VP Engineering



PERTUIS, on 23.06.2025

PELLENC

   www.pellenc.com

PELLENC
Quartier Notre Dame - 84120 Pertuis (France)

